

Connecting dimensions, valid for article number AL_10004

12

11

10

9

8

7

6



5

4

3

2

1

-  Thread holes for screws M6 are coloured red.
The tightening torque for these screws (strength class 8.8) is 4,8 Nm.
-  Thread holes for screws M12 are coloured green.
The tightening torque for these screws (strength class 8.8) is 41 Nm.
-  Drilling holes for location pins are filled red.
Recommended dimensions for locating pins: $\text{Ø}6 \text{ h}8 \left(\begin{smallmatrix} 6 \\ 5,982 \end{smallmatrix} \right)$

Z (2:1)

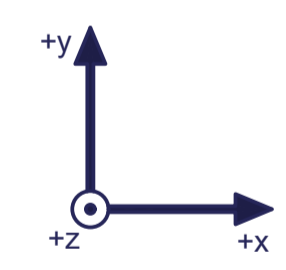
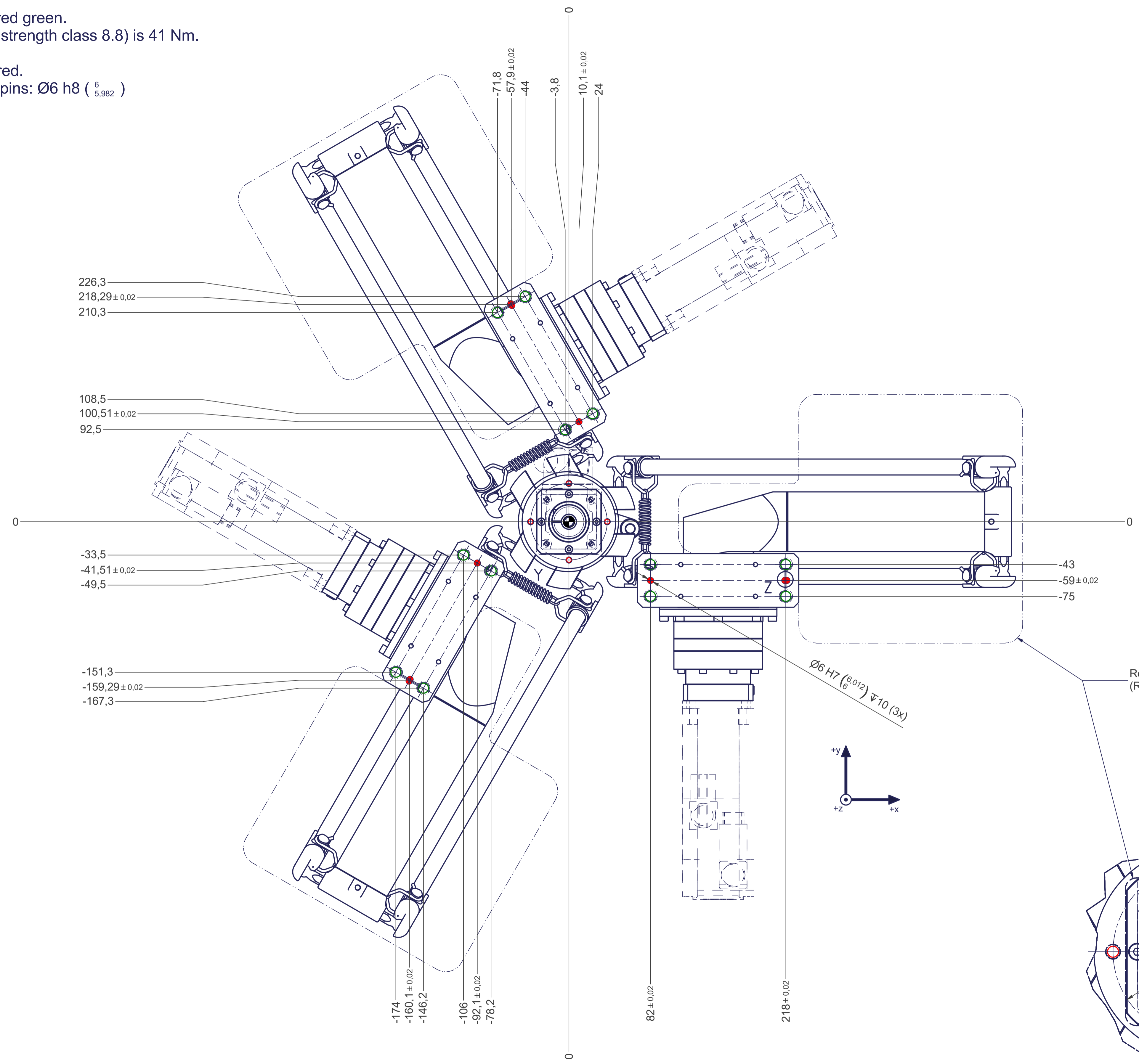
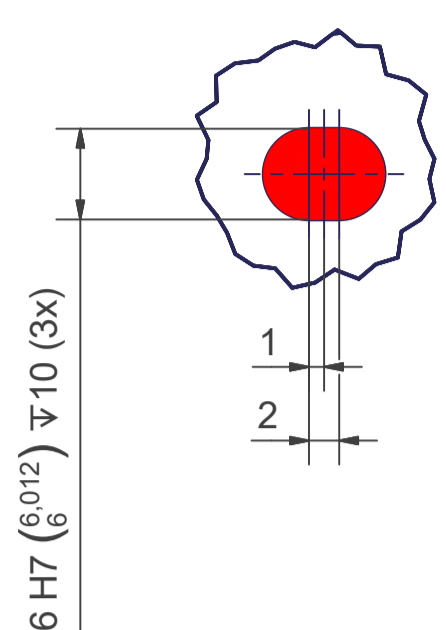

Y (1:1)

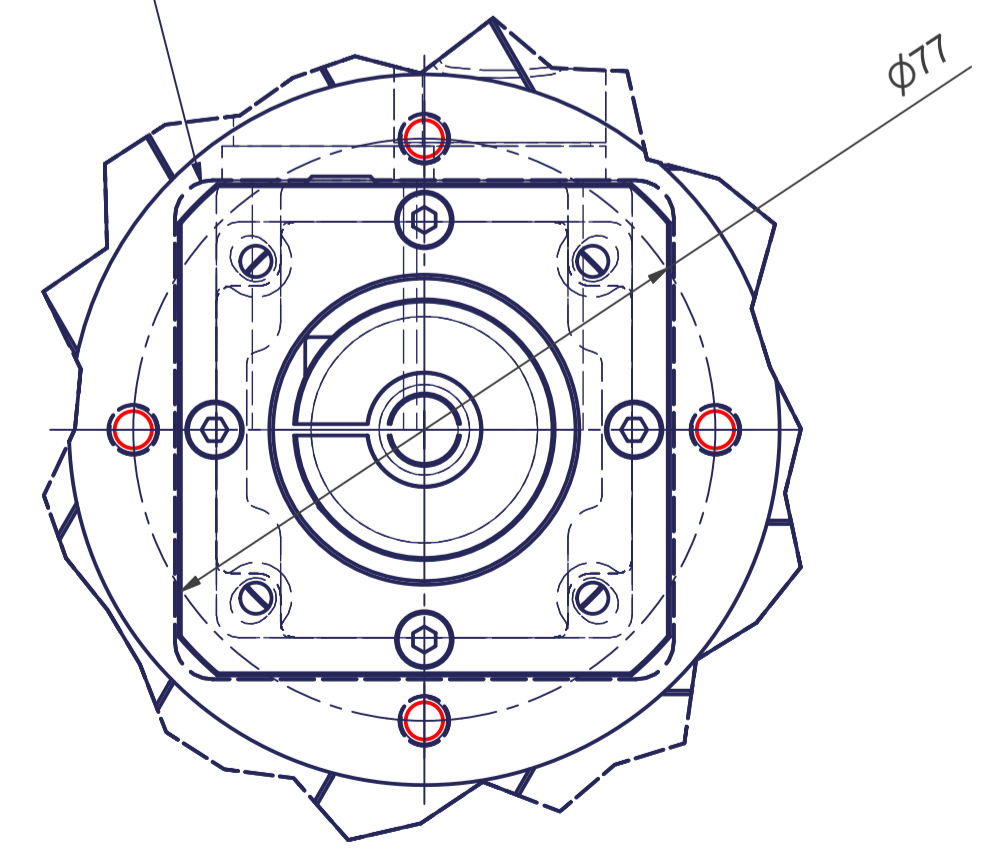

12

11

10

9

8

7

6

5

4

3

2

1