

A minimum distance of 100mm between the cable harness and any (machine)parts is recommended to avoid any collision

Optional Bellows (1 : 2)

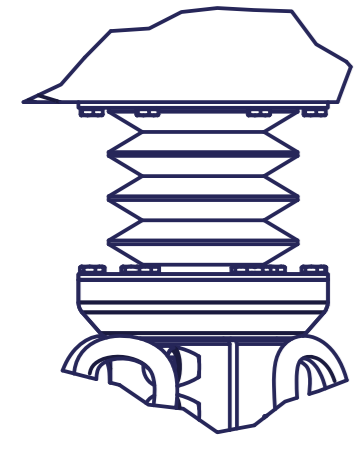

TCP - working range when using optional Bellows (MT_BGR00104375)

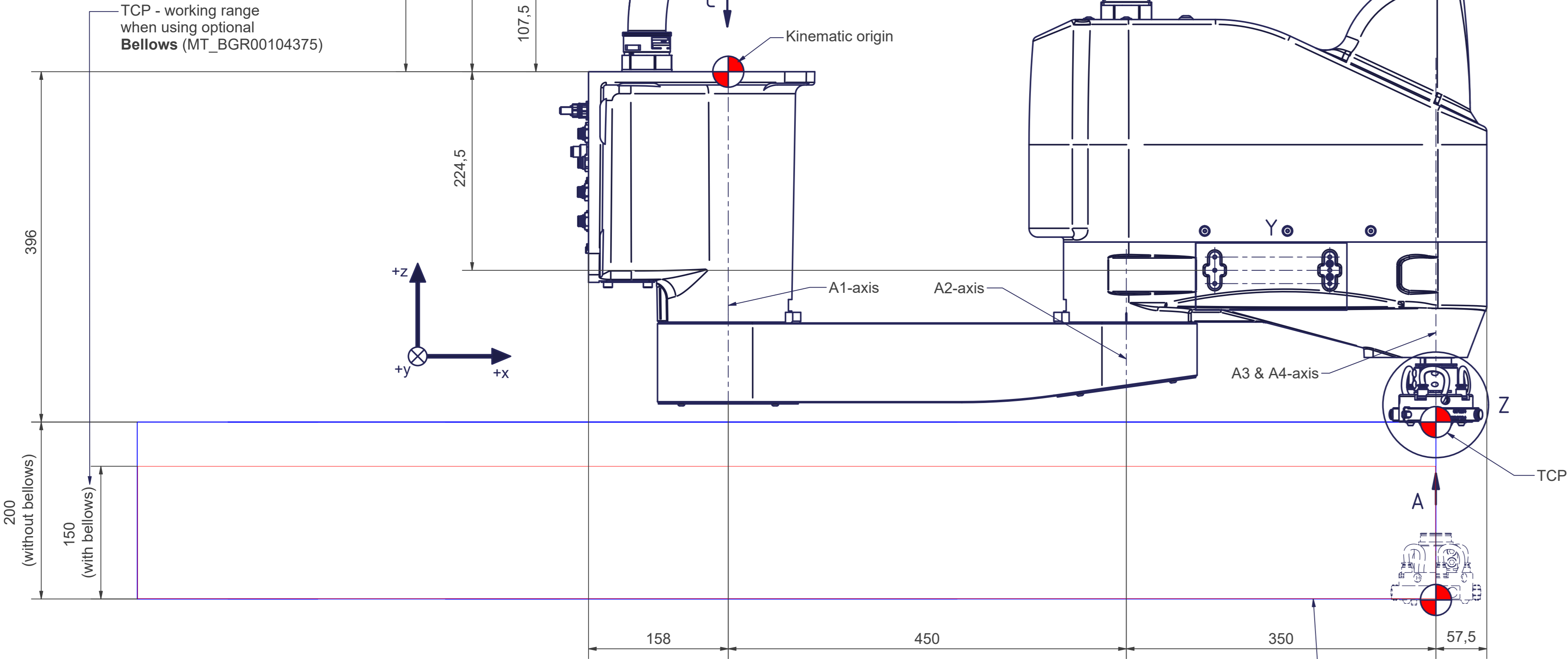

A (2 : 1)
Tool mounting flange

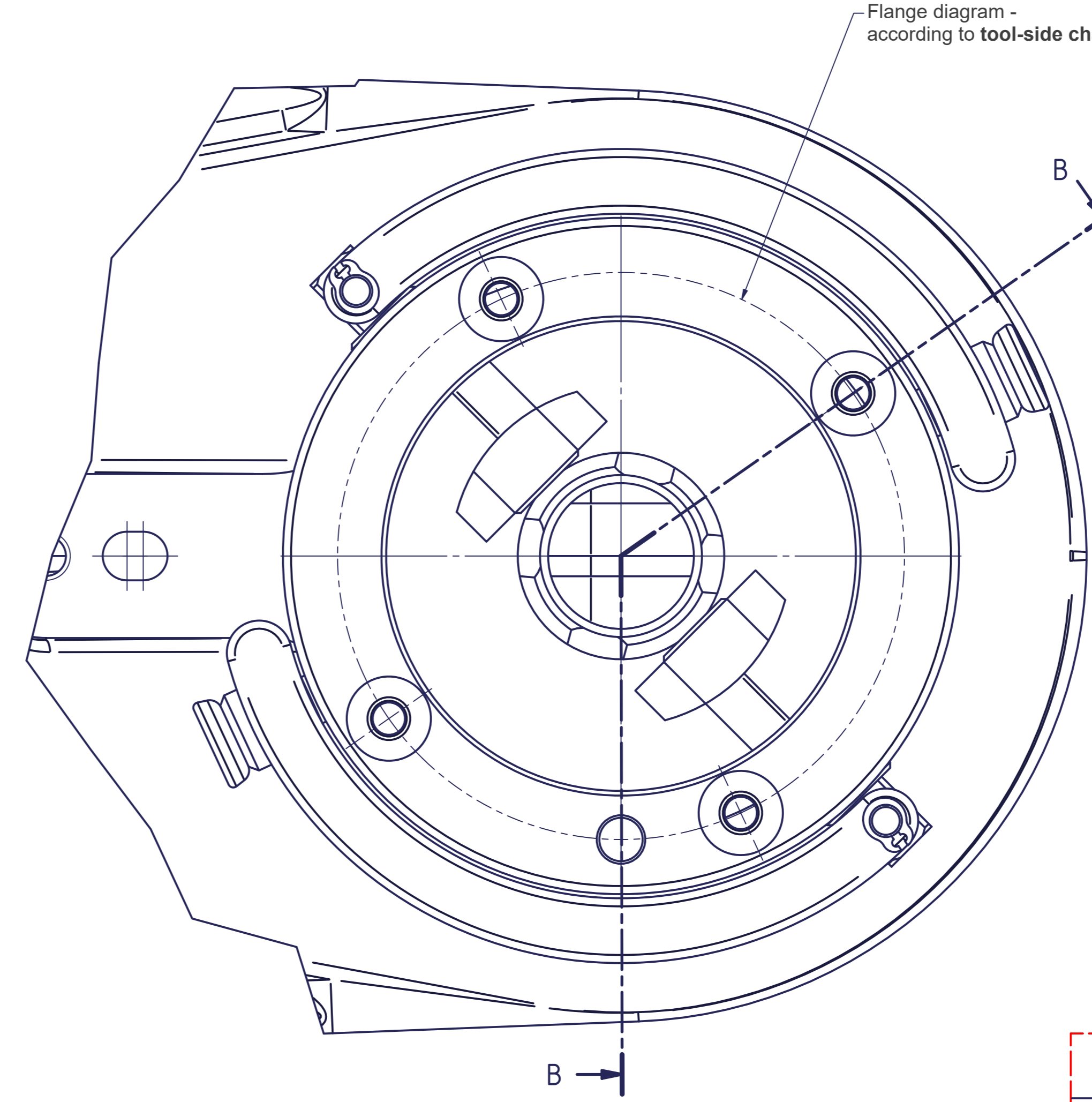

B-B

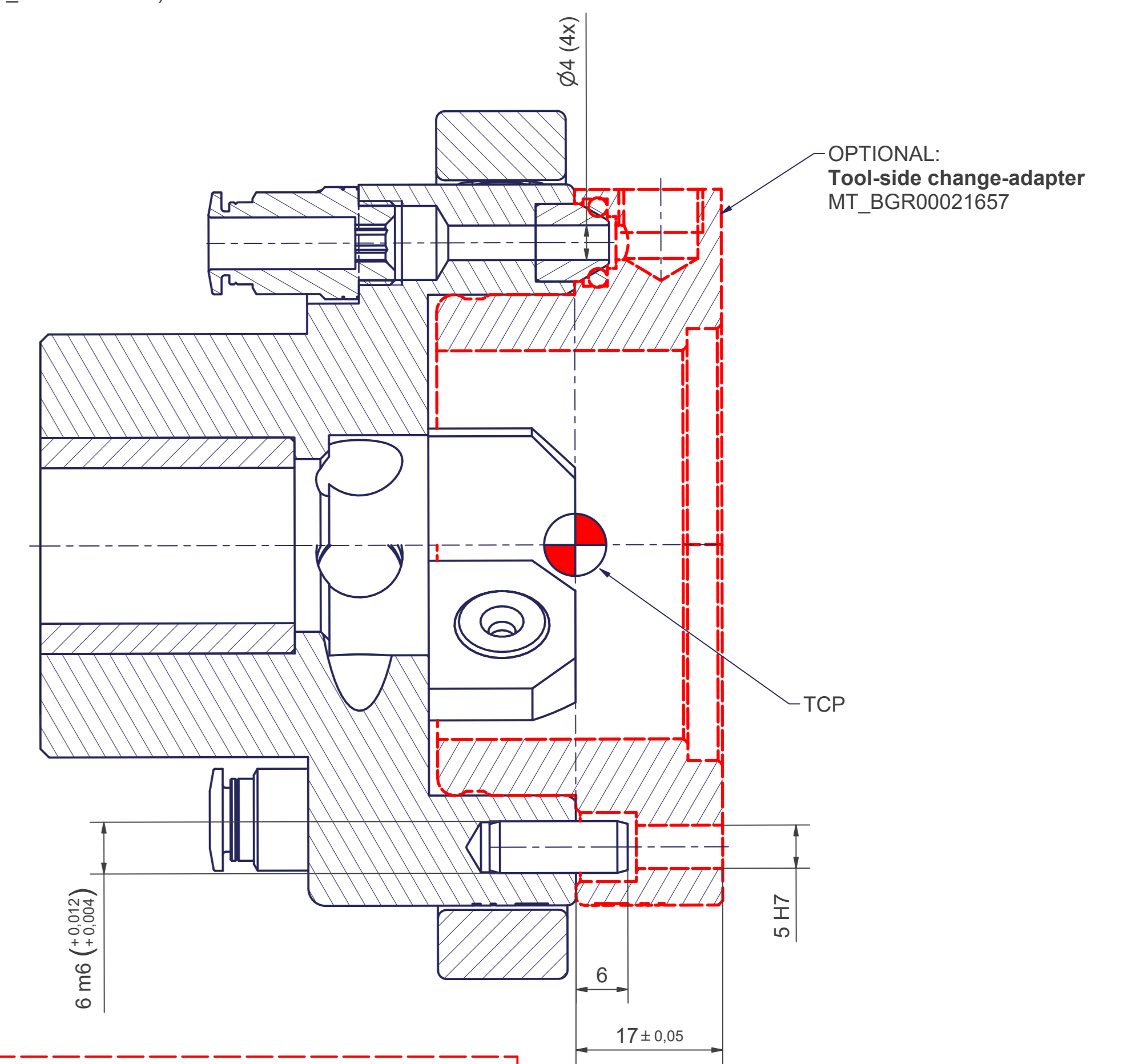

PIN assignment by autonox Robotics

PIN number	Connection to	M12 8-pin male
1	Push button	
2	Push button	
3 to 8	Not connected	

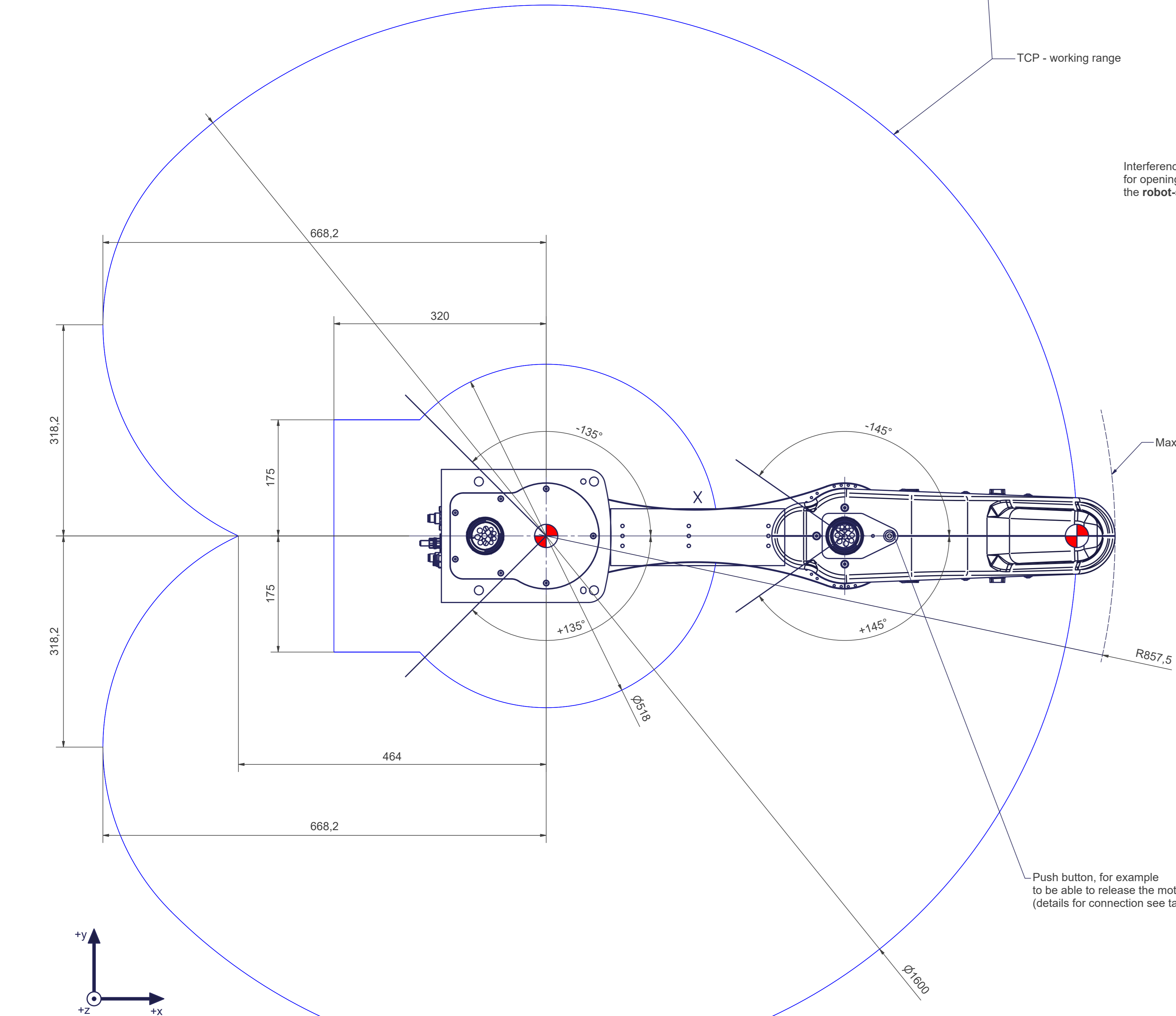

Interference contour for opening and closing the robot-side change-head

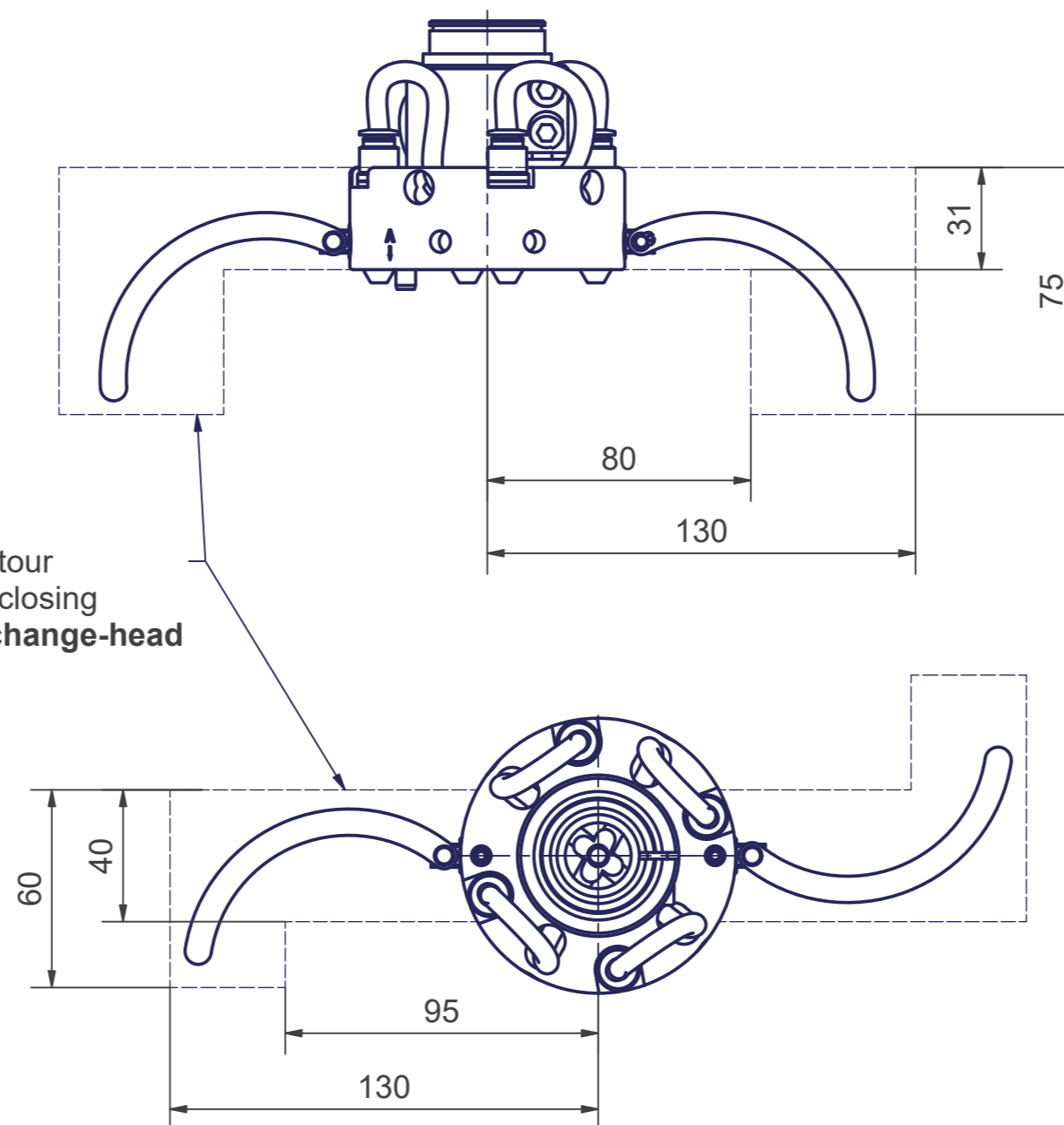

C (1 : 2)
Base frame

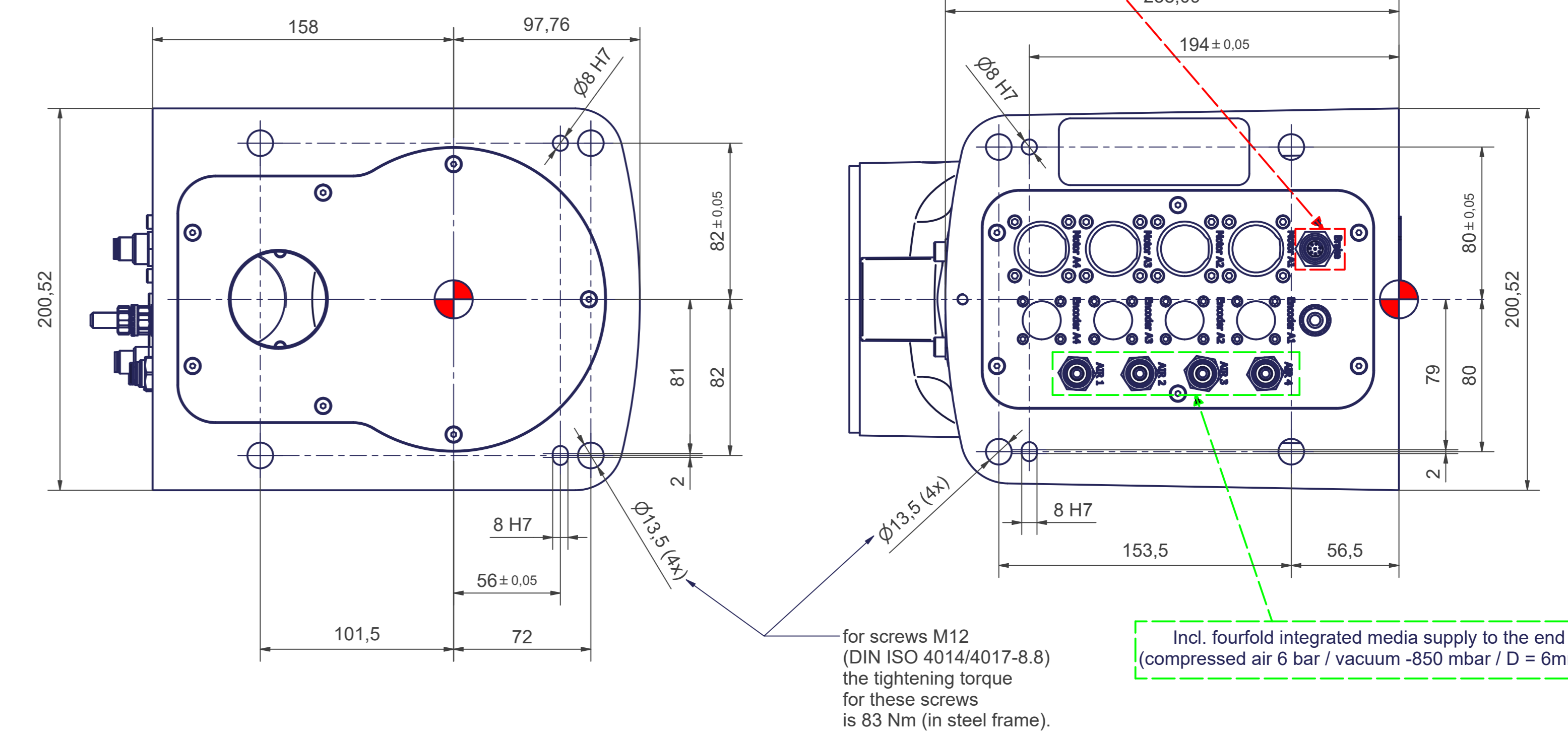

Z (1 : 1)

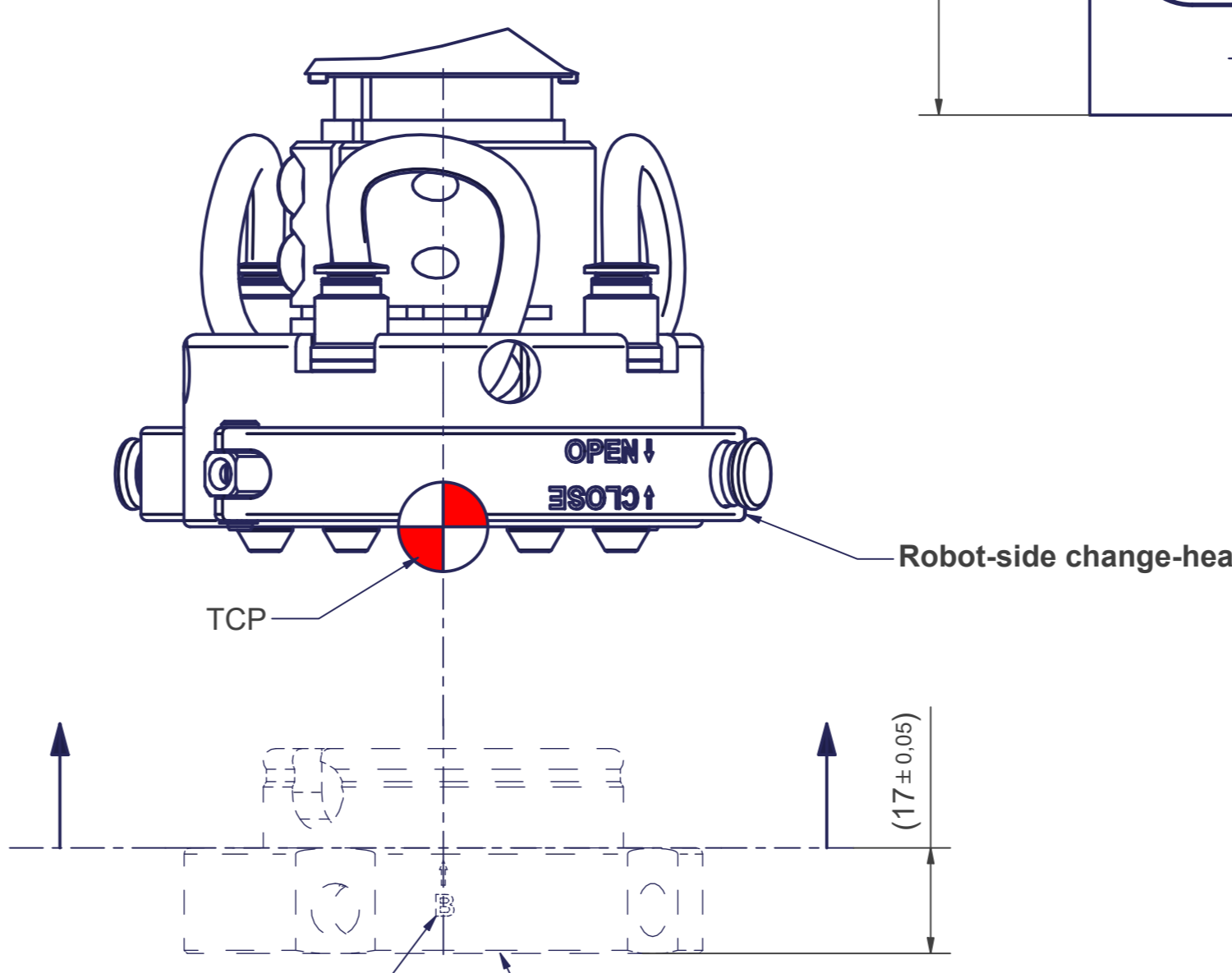

X (1 : 2)

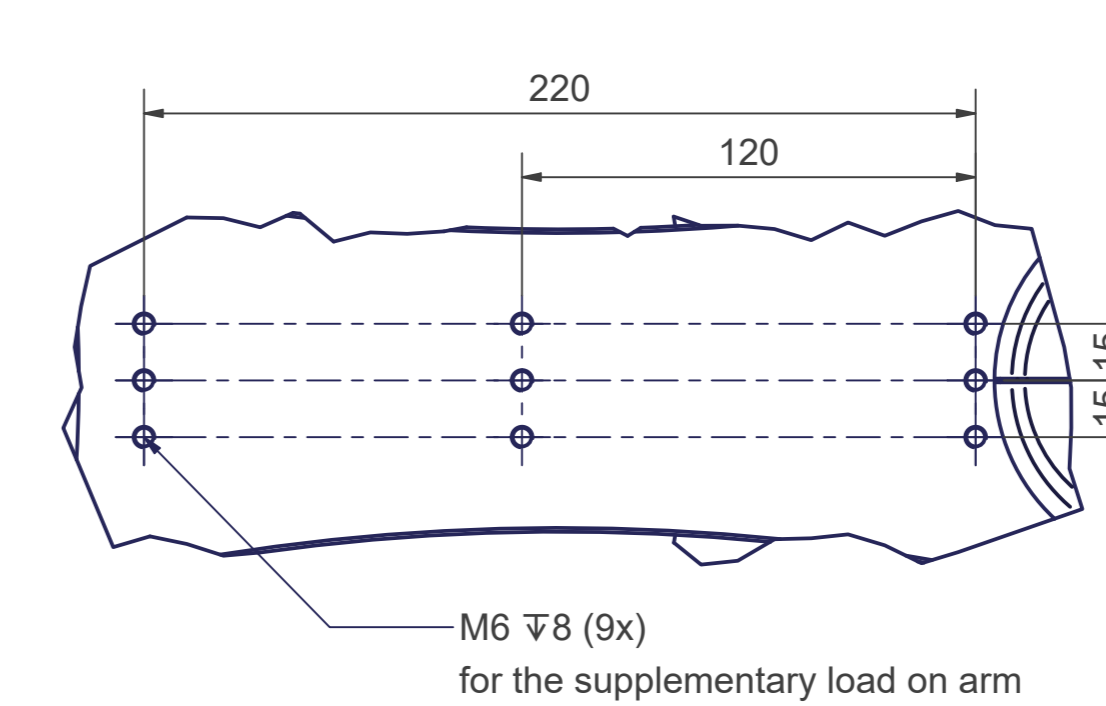

Y (1 : 2)

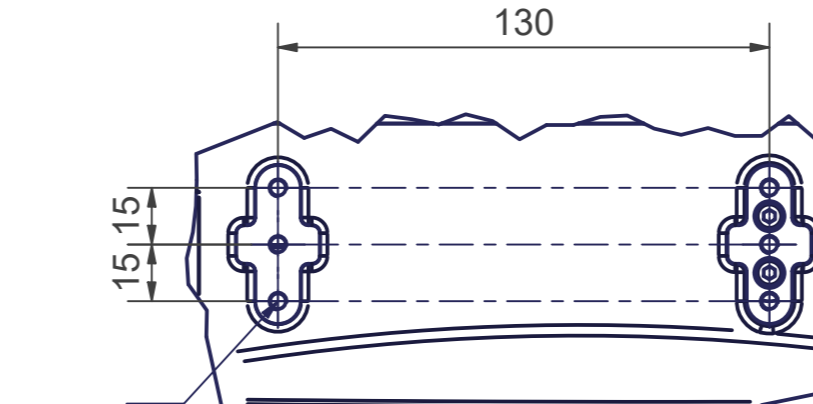

for screws M12 (DIN ISO 4014/4017-8.8) the tightening torque for these screws is 83 Nm (in steel frame).

Incl. fourfold integrated media supply to the end effector (compressed air 6 bar / vacuum -850 mbar / D = 6mm d = 4mm)

sCara4-800-6kg		Motion	
Axes	4	Axes	Range fully usable
Payload (on TCP)	6kg	A1	± 135°
Reach	800 mm	A2	± 145°
Mounting position	Floor, ceiling, wall	A3	- 396 mm / - 596 mm
		A4	± 360°

More information can be found in the document "calibration dimensions"

Connecting dimensions, valid for article number: AT_00024-01-ATS

kg	kg	A	bar
m ²	m ²	P _z	l/min
proj. storage surface =		U _z	V / Hz / Ph
		l _{max}	A

OPTIONAL:
Tool-side change-adapter MT_BGR00021657

Bellows MT_BGR00104375