

Tool Center Point
TCP (on the plane of the flange)

TCP - working range

Maximum deflection of the upper arm

Interference contour
from machine body

Maximum interference
contour

Depending on
the motor type

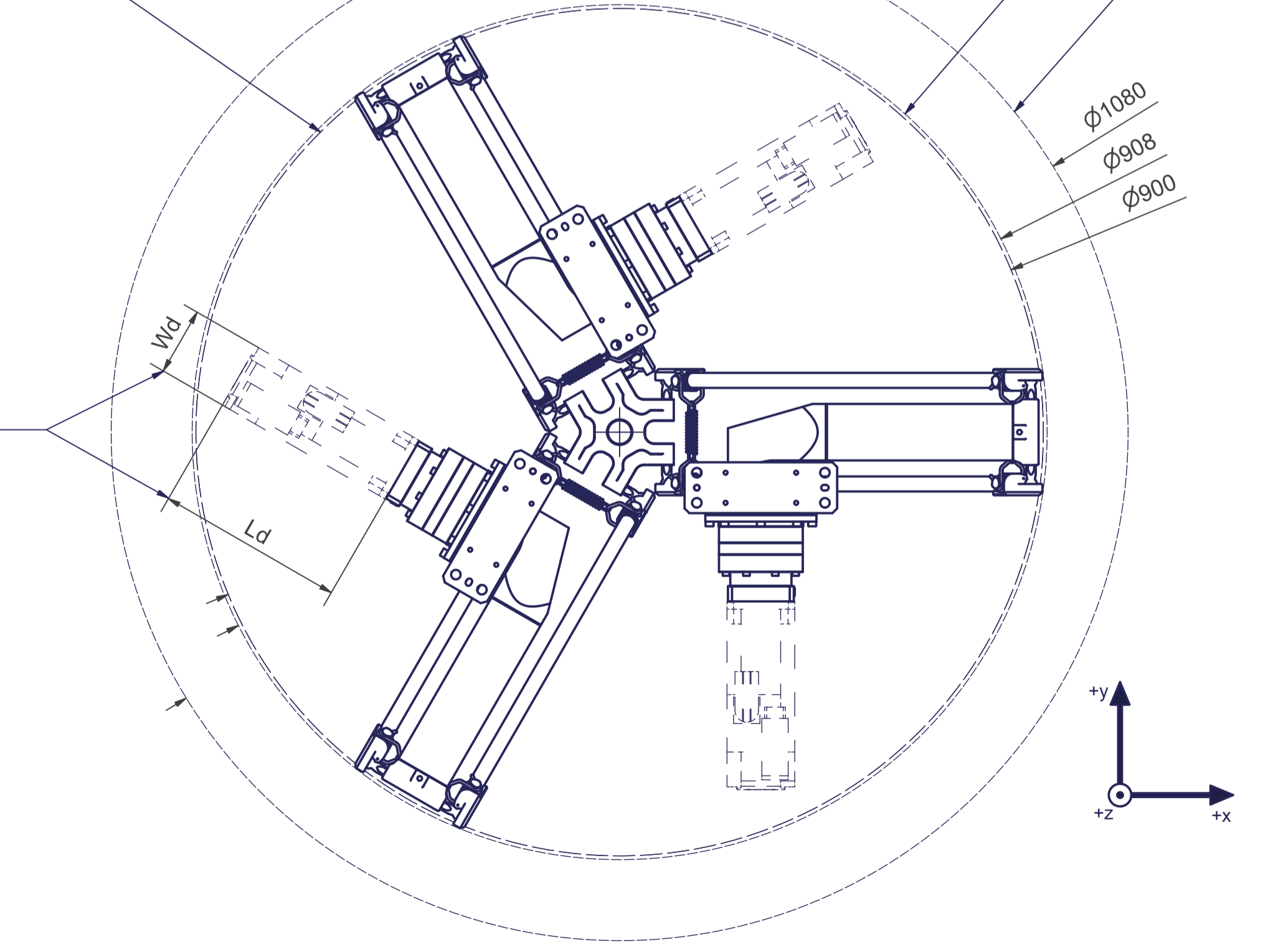

Z (1:1)

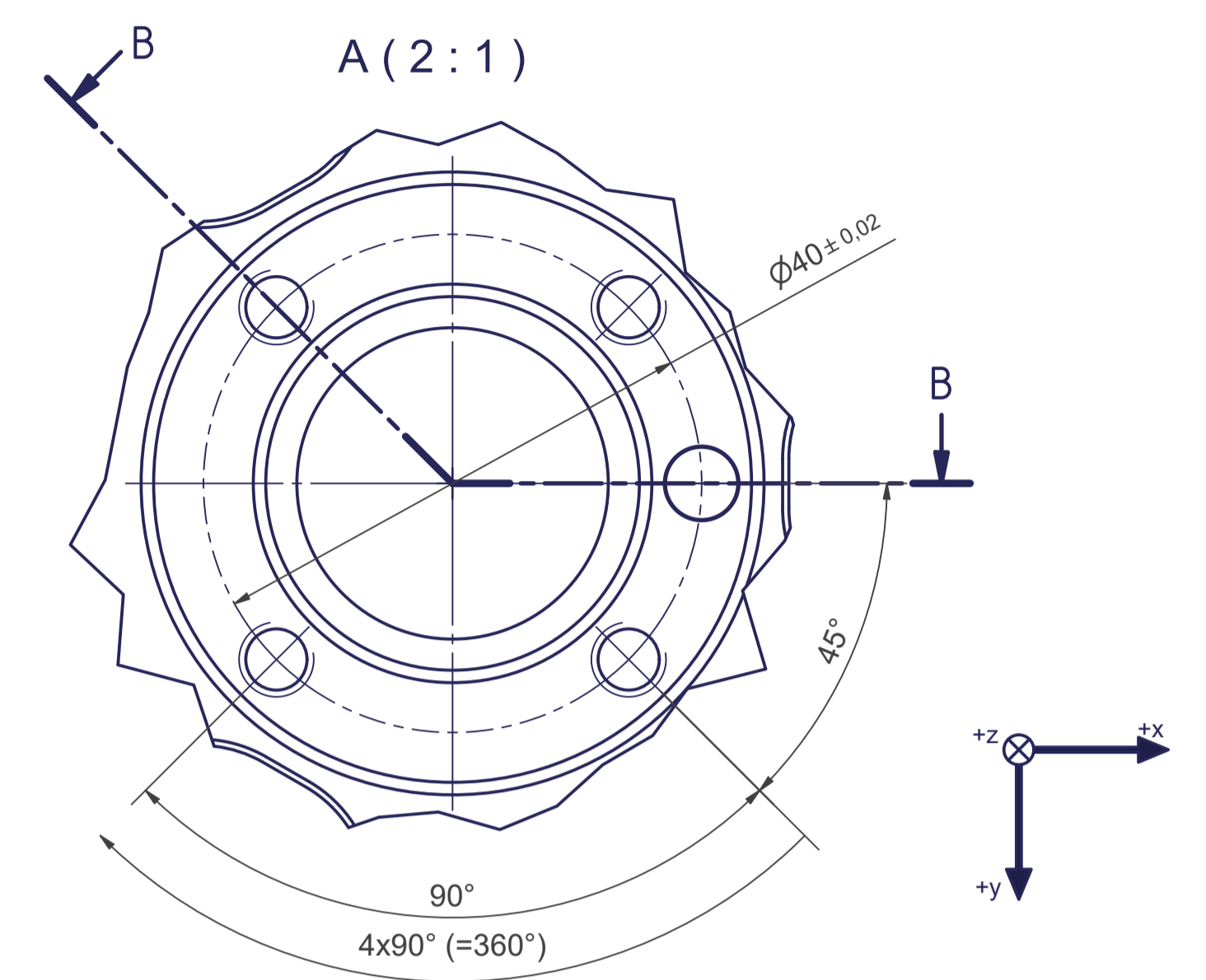
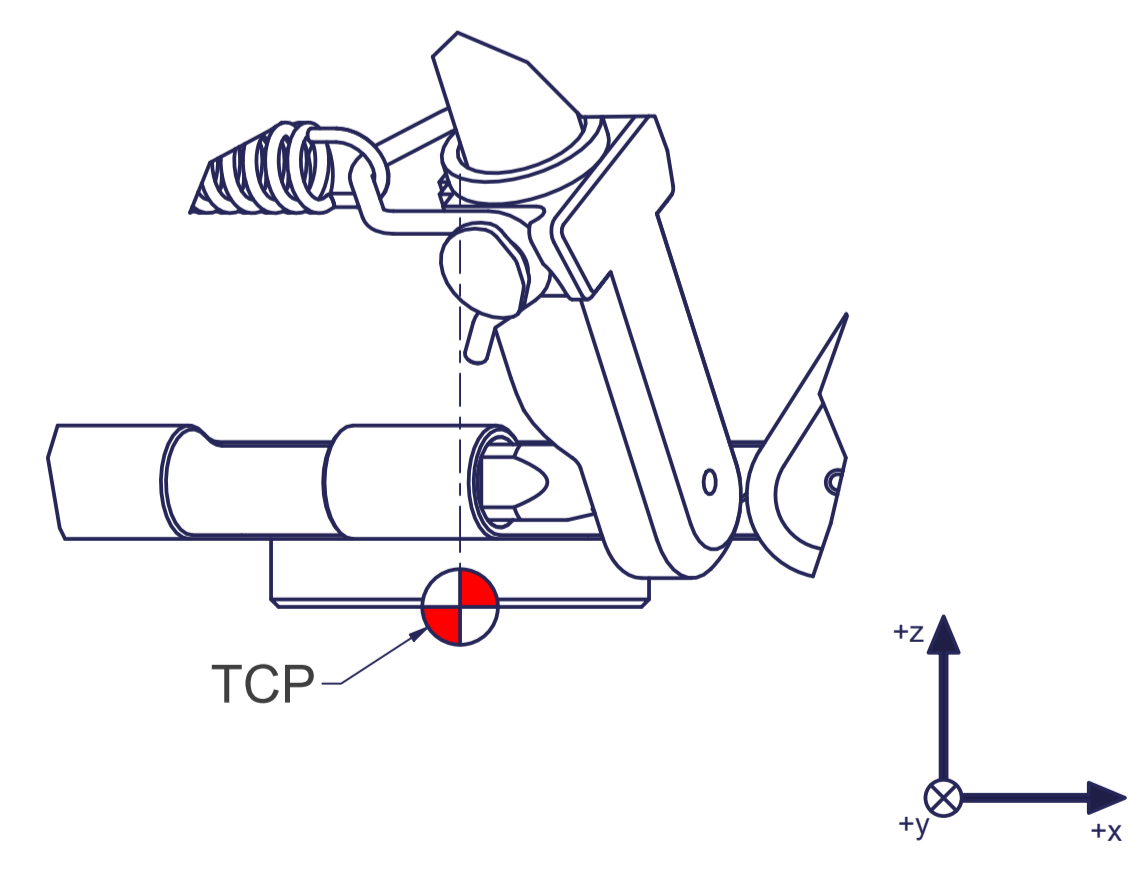

B-B

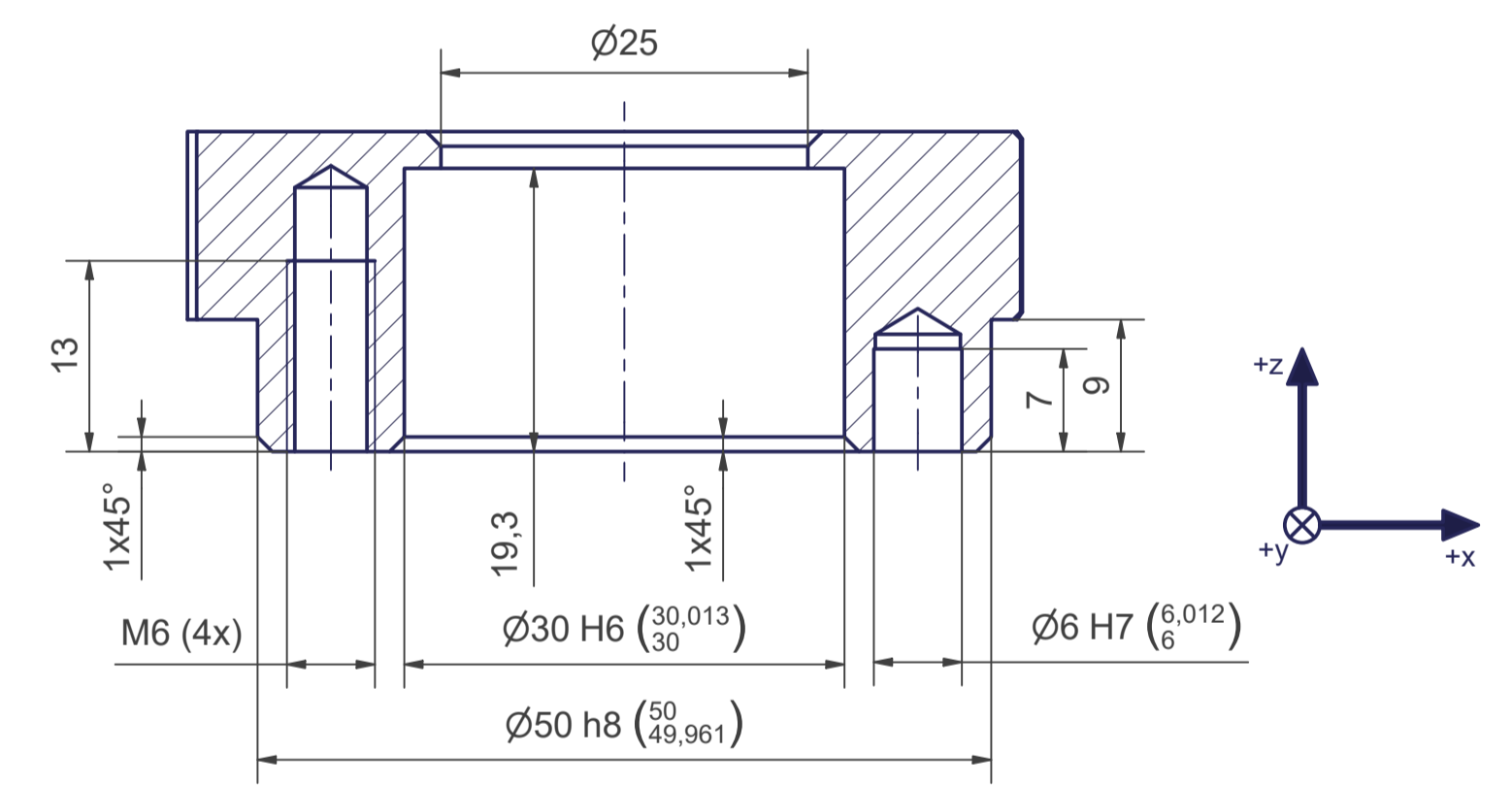

Connecting dimensions,
valid for article number AL_10003

m= kg	A	
proj. storage surface = m²		p= bar
First angle projection		v̇= l/min
	P= kW	
	U= V / Hz / Ph	
	I _{max} = A	
		autonox lean line

12 11 10 9 8 7 6 5 4 3 2 1

Thread holes for screws M12 are coloured green.
The tightening torque for these screws (strength class 8.8) is 41 Nm.

Drilling holes for location pins are filled red.
Recommended dimensions for locating pins: $\text{Ø}6 \text{ h}8 \left(\begin{smallmatrix} 6 \\ 5,982 \end{smallmatrix} \right)$

Z (2:1)

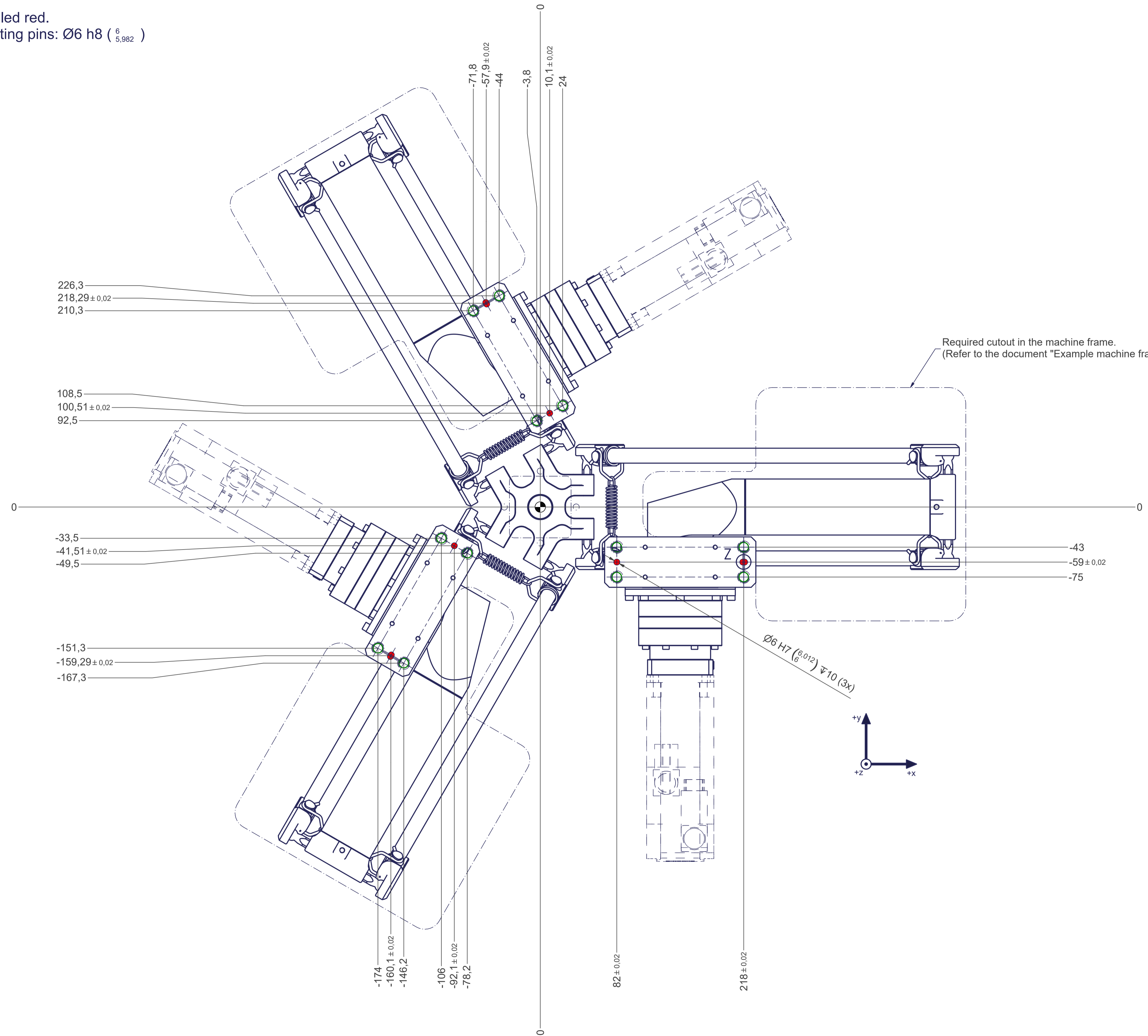
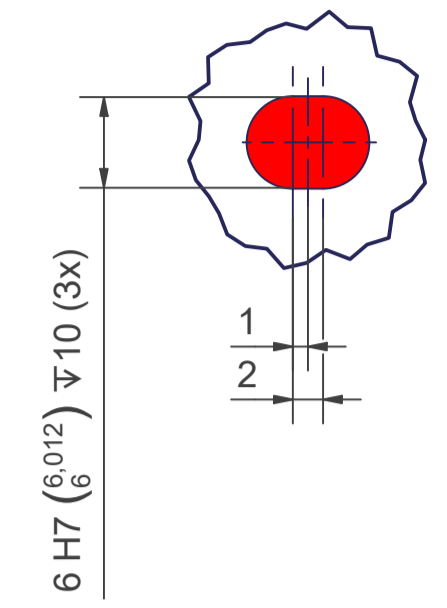

12 11 10 9 8 7 6 5 4 3 2 1