

Optional Bellows (1:2)

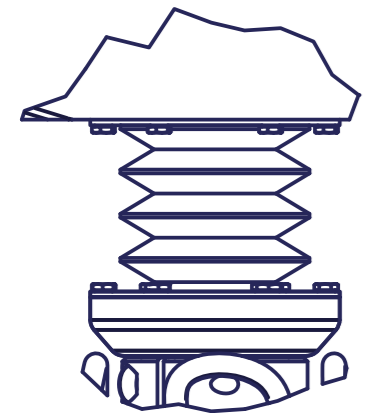

TCP - working range when using optional Bellows (MT_BGR00104375)

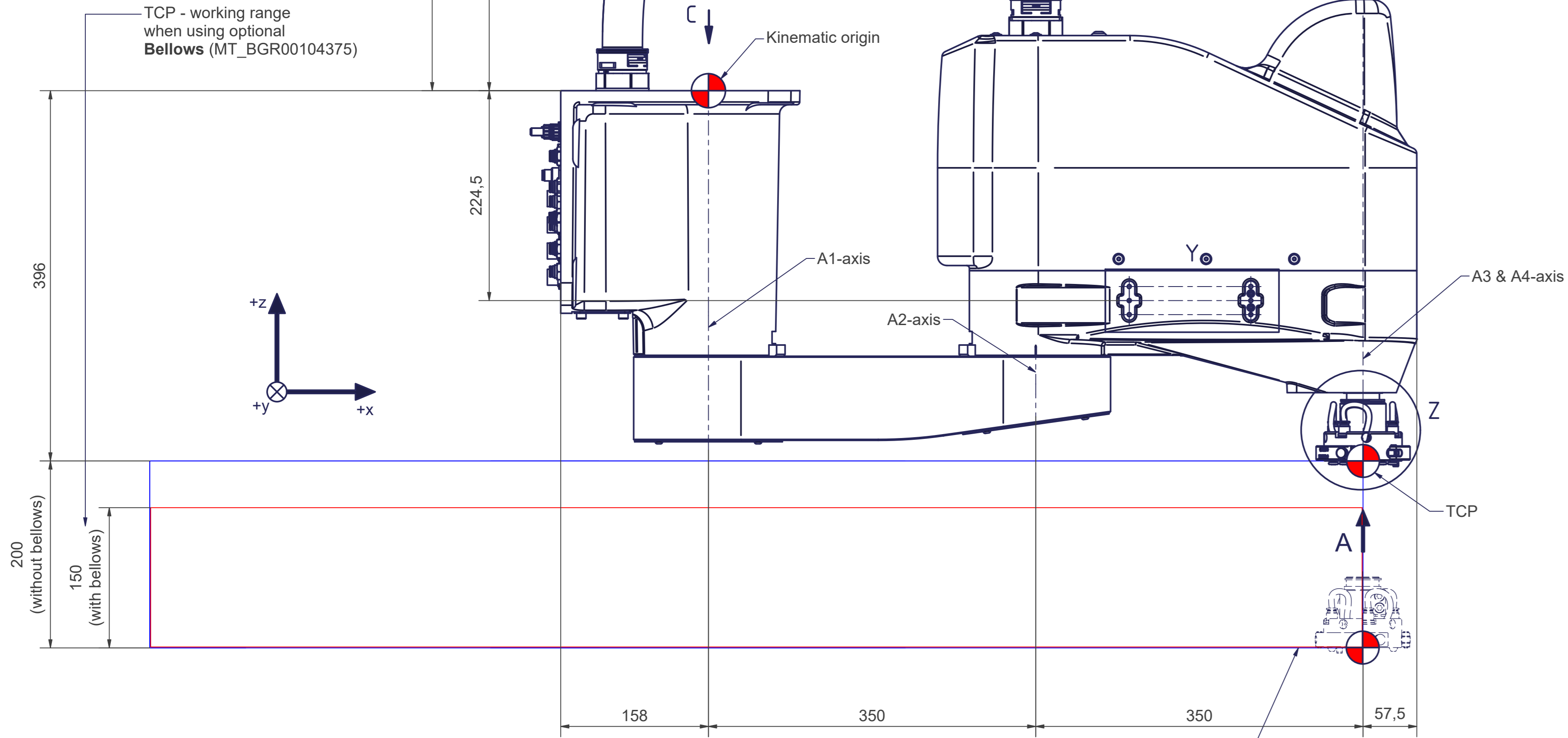

A minimum distance of 100mm between the cable harness and any (machine) parts is recommended to avoid any collision

A (2:1)
Tool mounting flange

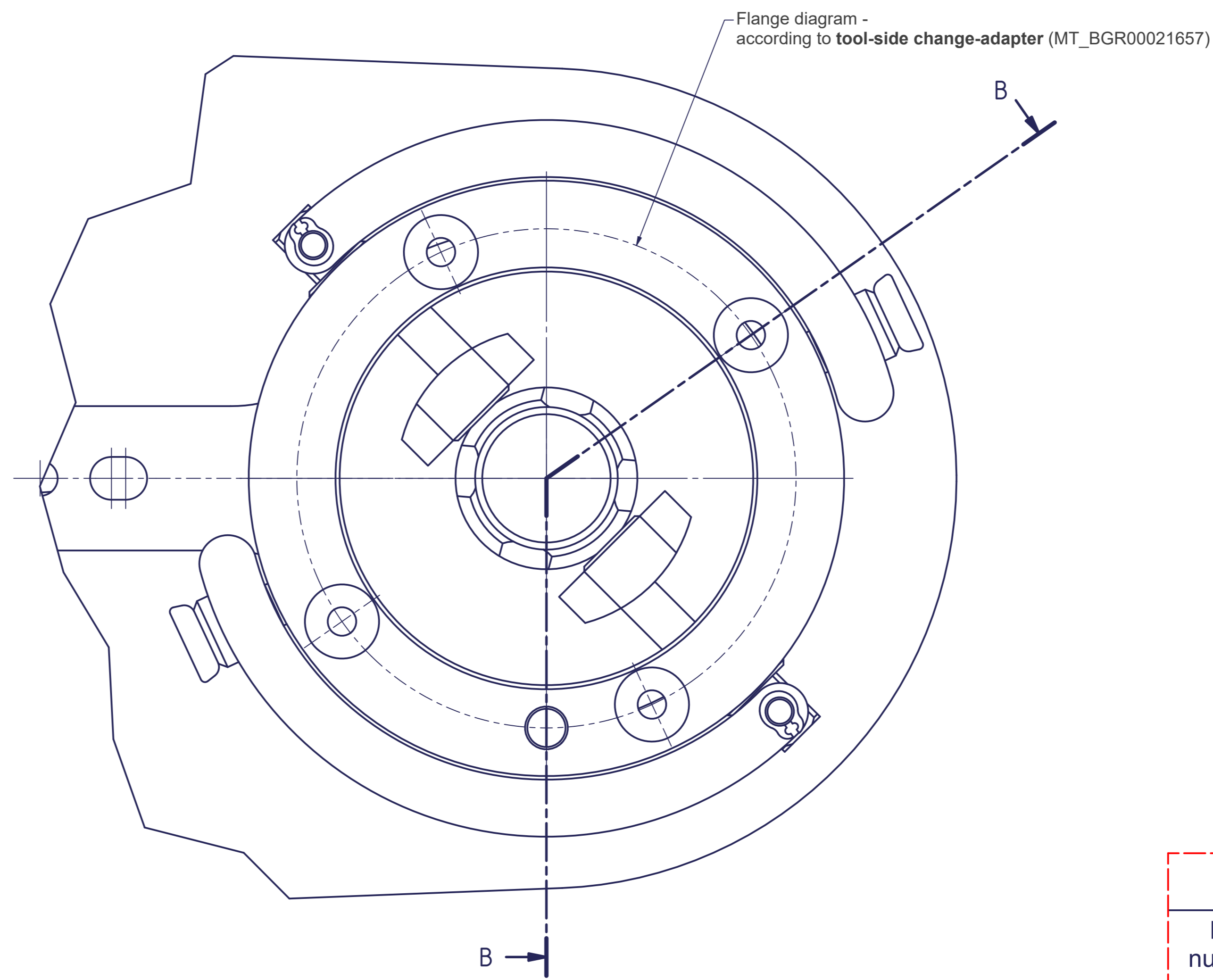

B-B

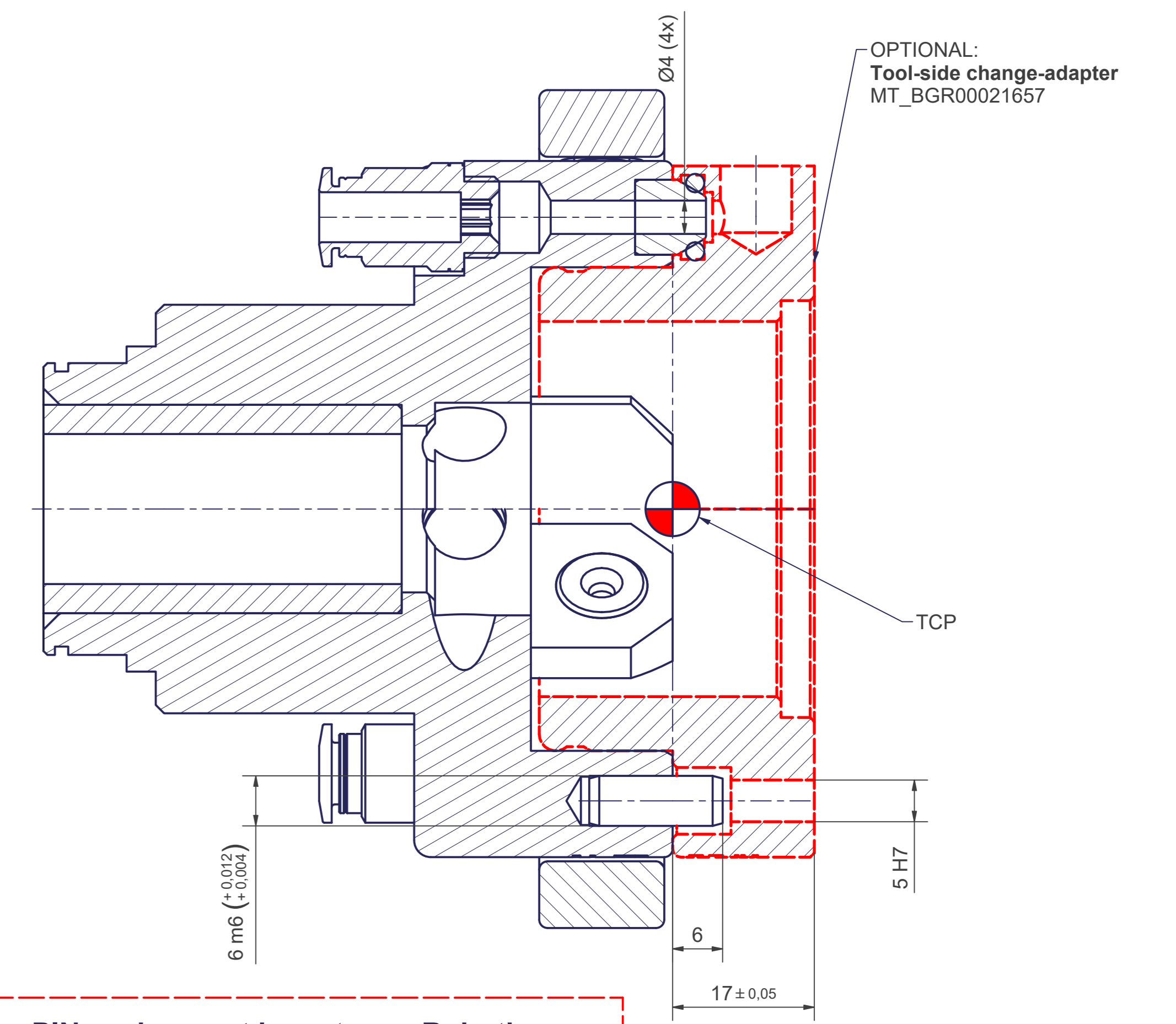

PIN assignment by autonox Robotics

PIN number	Connection to	M12 8-pin male
1	Push button	
2	Push button	
3 to 8	Not connected	

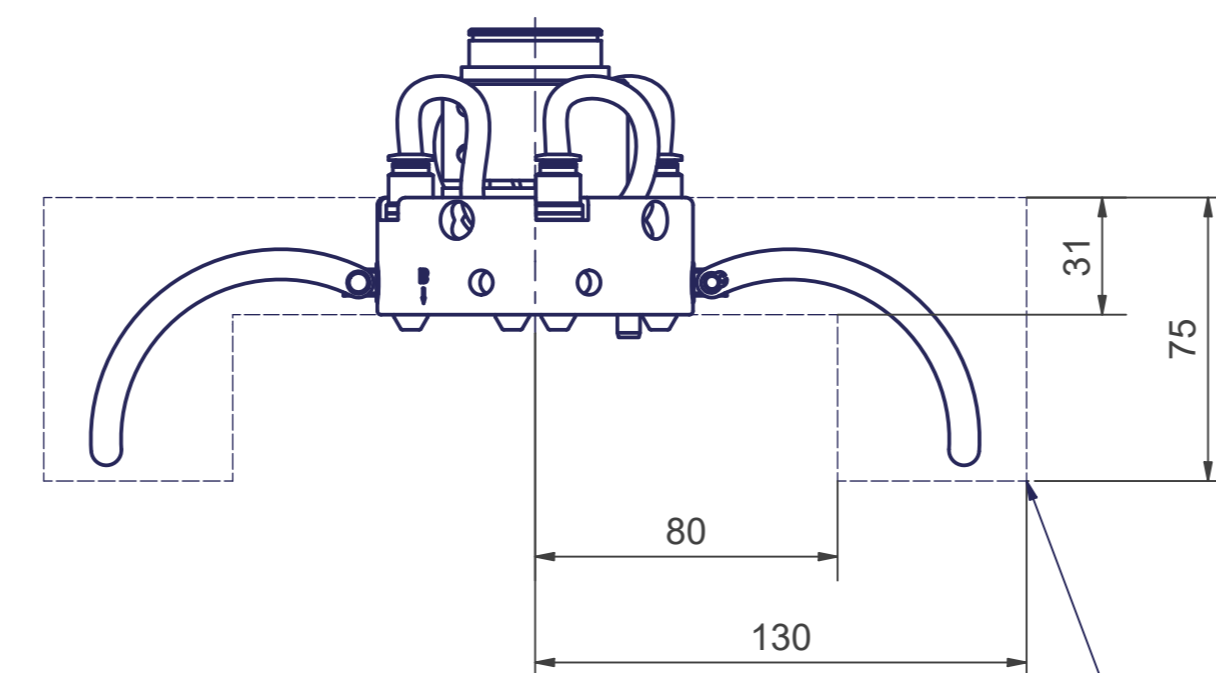

Push button, for example to be able to release the motor brakes (details for connection see table "PIN assignment")

Interference contour for opening and closing the robot-side change-head

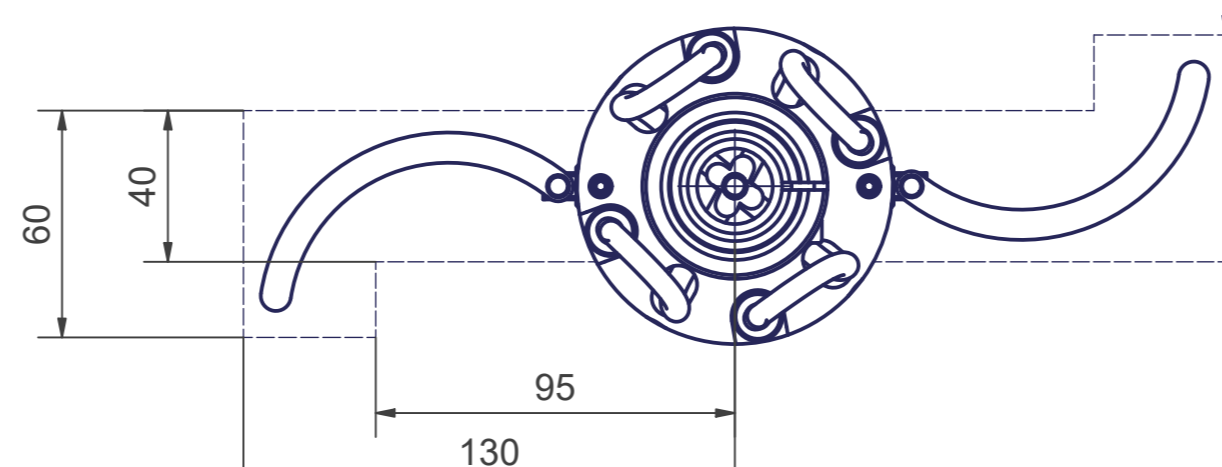

C (1:2)
Base frame

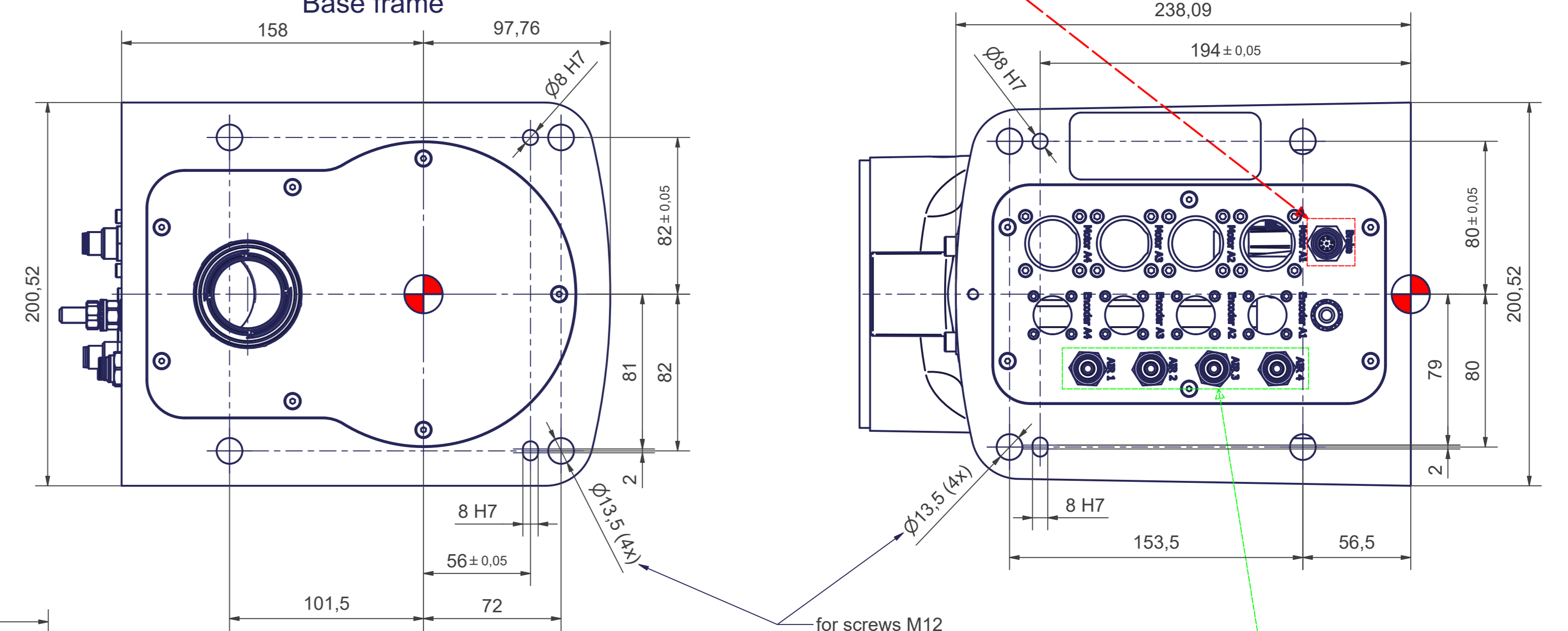

X (1:2)

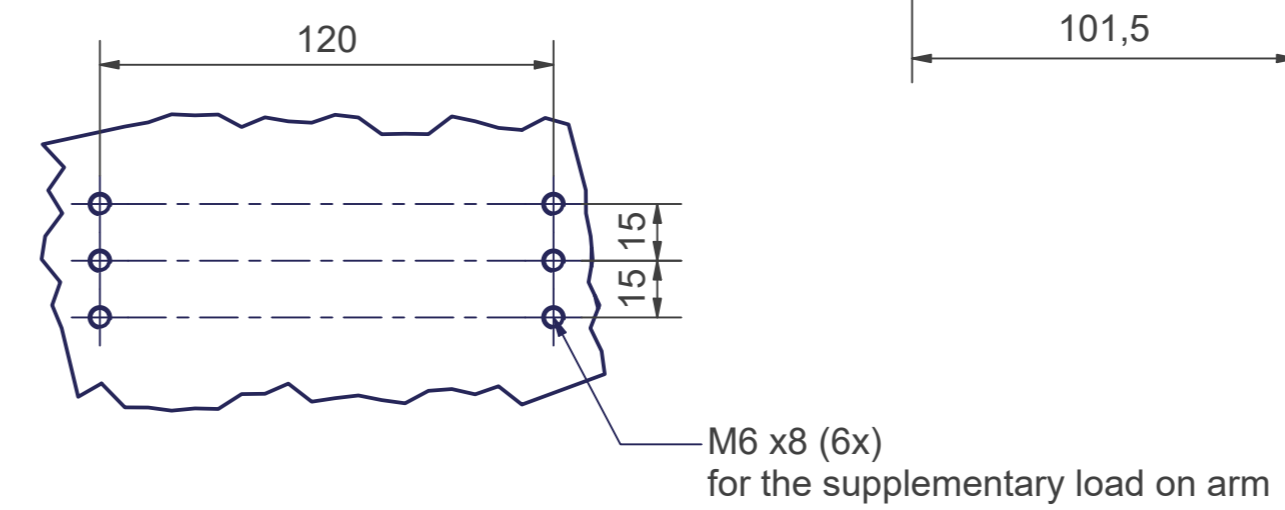

Z (1:1)

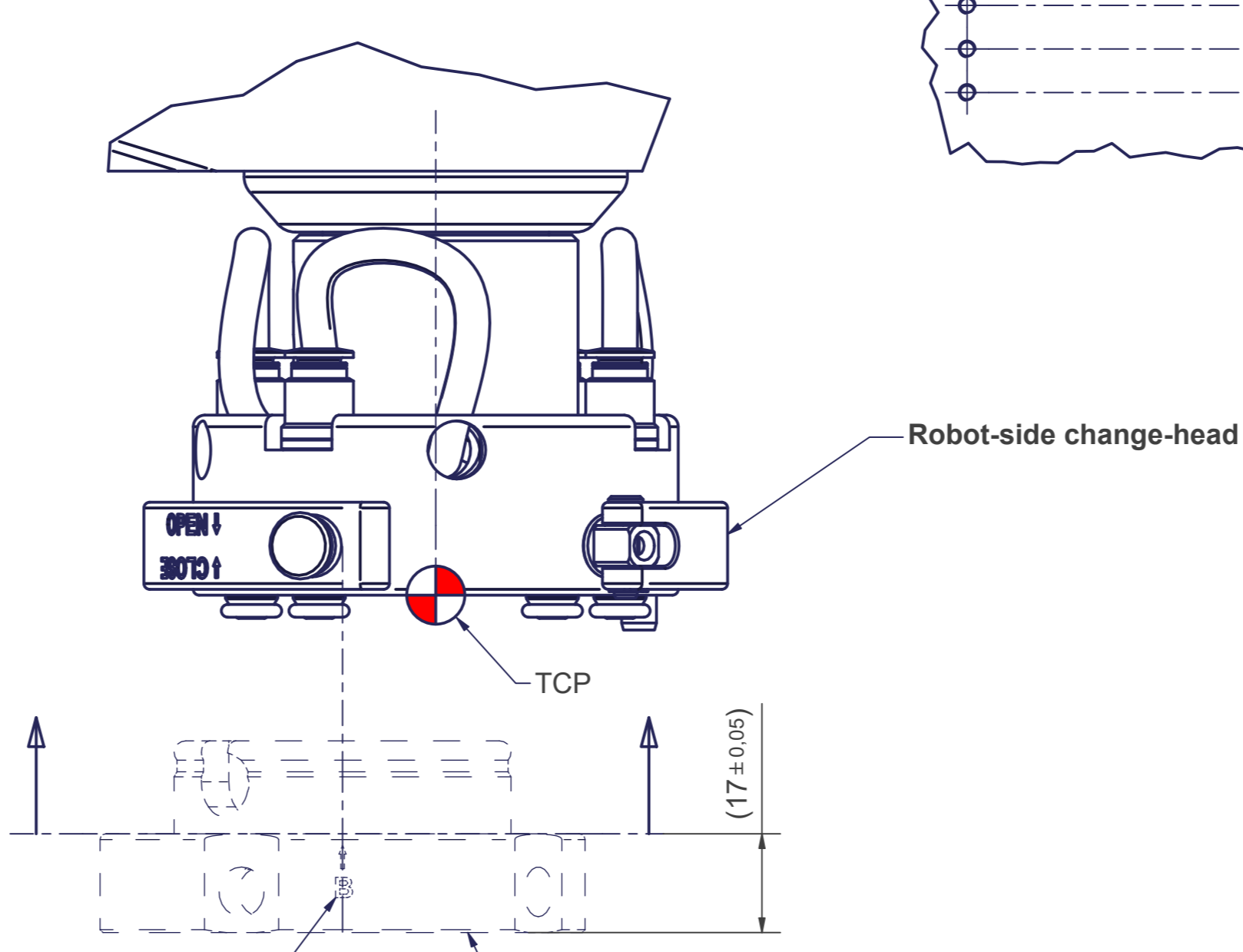

The mark "A" and "B" of the Tool-side change-adapter must fit with the mark "A" and "B" on the Robot-side change-head.

OPTIONAL: Tool-side change-adapter MT_BGR00021657

Y (1:2)

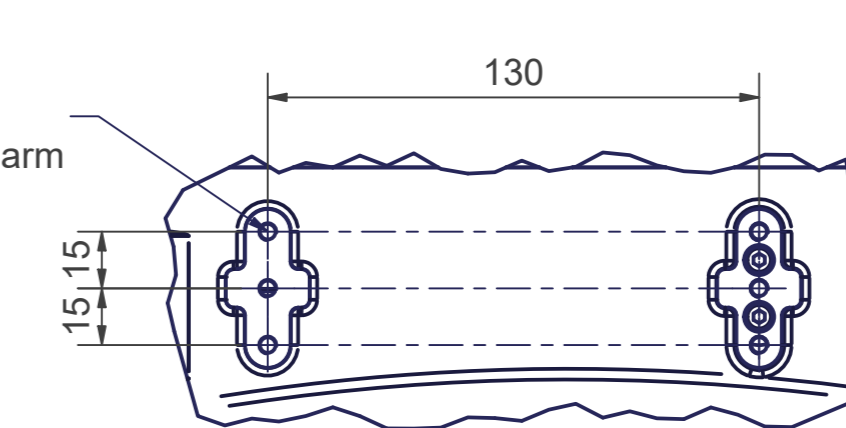

sCara4-700-6kg		Motion	
Axes	4	Axes	Range fully usable
Payload (on TCP)	6 kg	A1	± 135°
Reach	700 mm	A2	± 145°
Mounting position	Floor, ceiling, wall	A3	- 396 mm / - 596 mm
		A4	± 360°

More information can be found in the document "calibration dimensions"

Connecting dimensions, valid for article number: AT_00020-01-ATS

kg	kg	A	bar
m ⁻	kg	A	l/min
proj. storage surface =	m ²	Pz	mm
U _n	mm	U _n	mm
l _{max}	mm	U _n	mm
		U _n	mm
		U _n	mm

OPTIONAL: Tool-side change-adapter MT_BGR00021657

Bellows MT_BGR00104375

