





12 11 10 9 8 7 6 5 4 3 2 1

-  All fastening holes  $\varnothing 13,5$  for screws M12 (DIN ISO 4014/4017 -8.8) without washers. Fastening holes are coloured red.
-  Thread holes for screws M12 are coloured green. The tightening torque for these screws (strength class 8.8) is 117 Nm.
-  Drilling holes for locating pins are filled red.
-  Openings for the cable management are coloured turquoise.

Z (2:1)

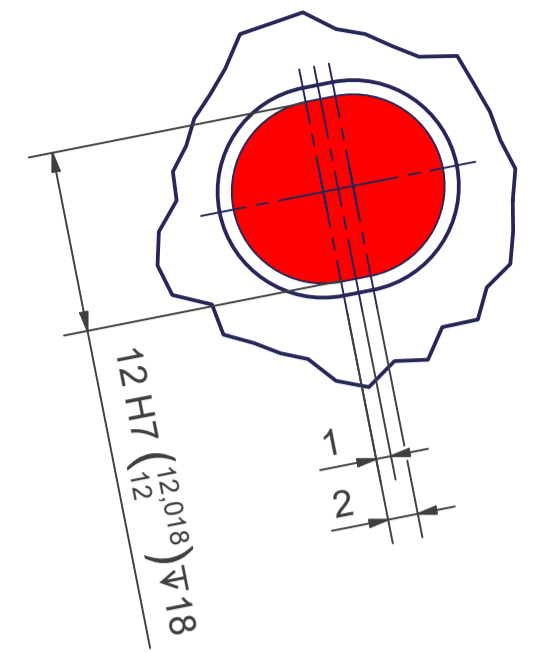

Y (2:1)

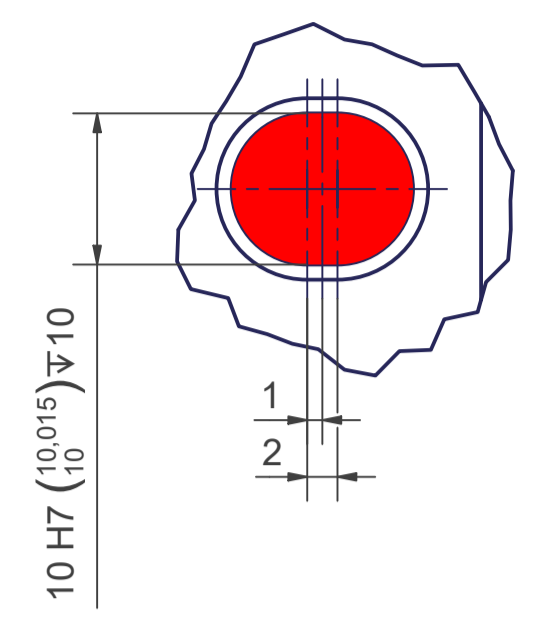

X (2:1)

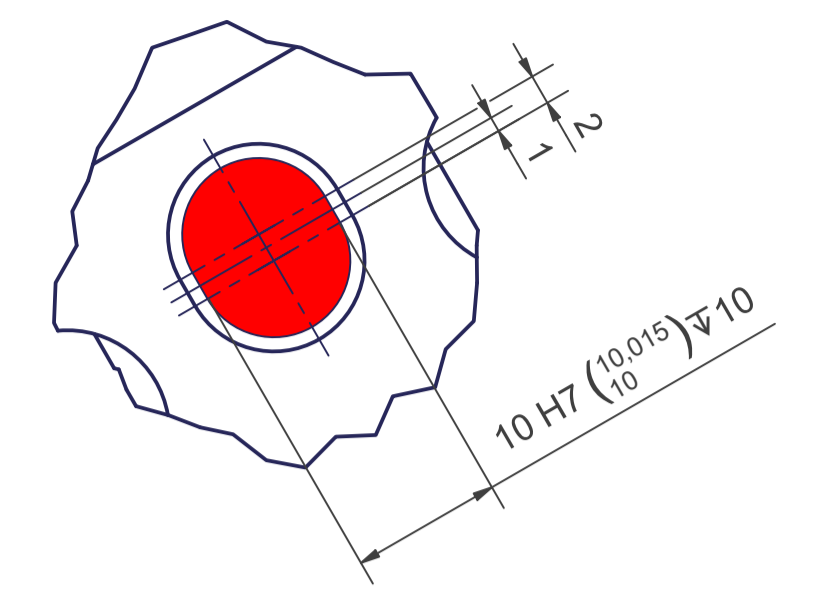

W (2:1)

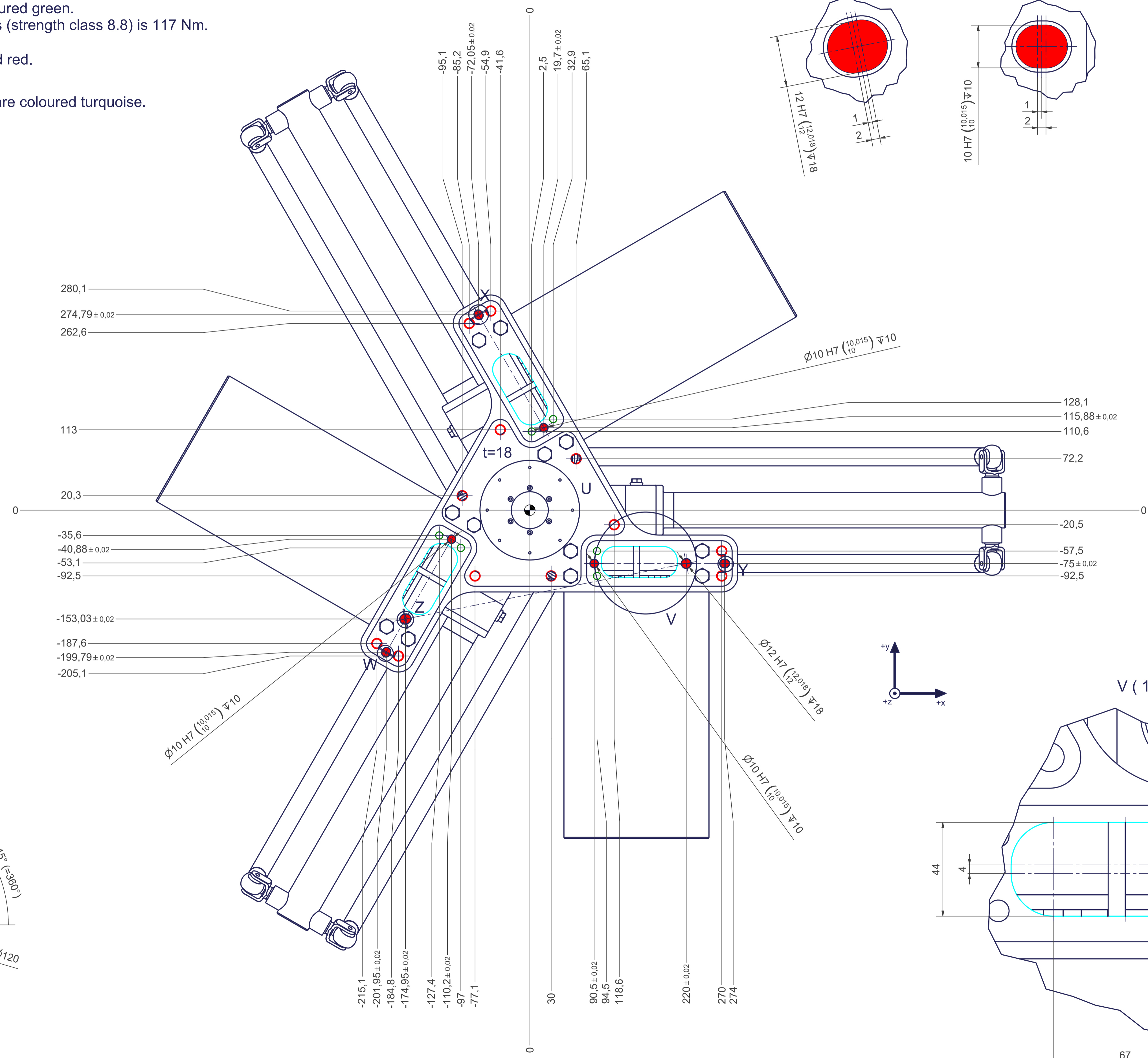
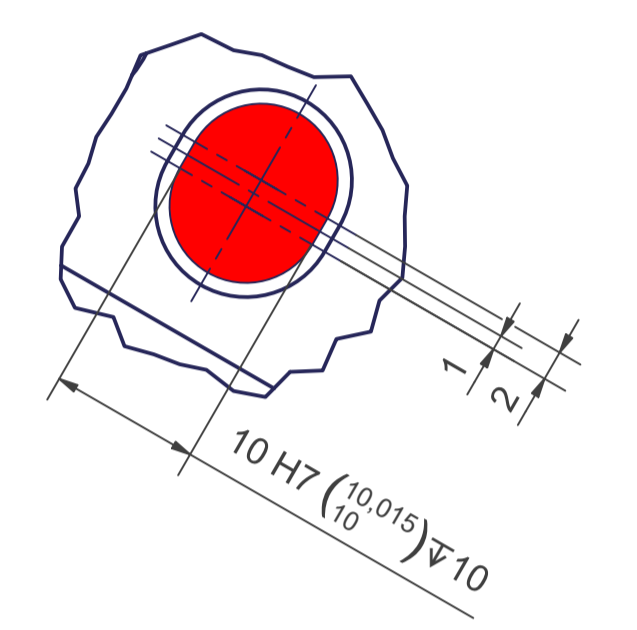

U (2:3)

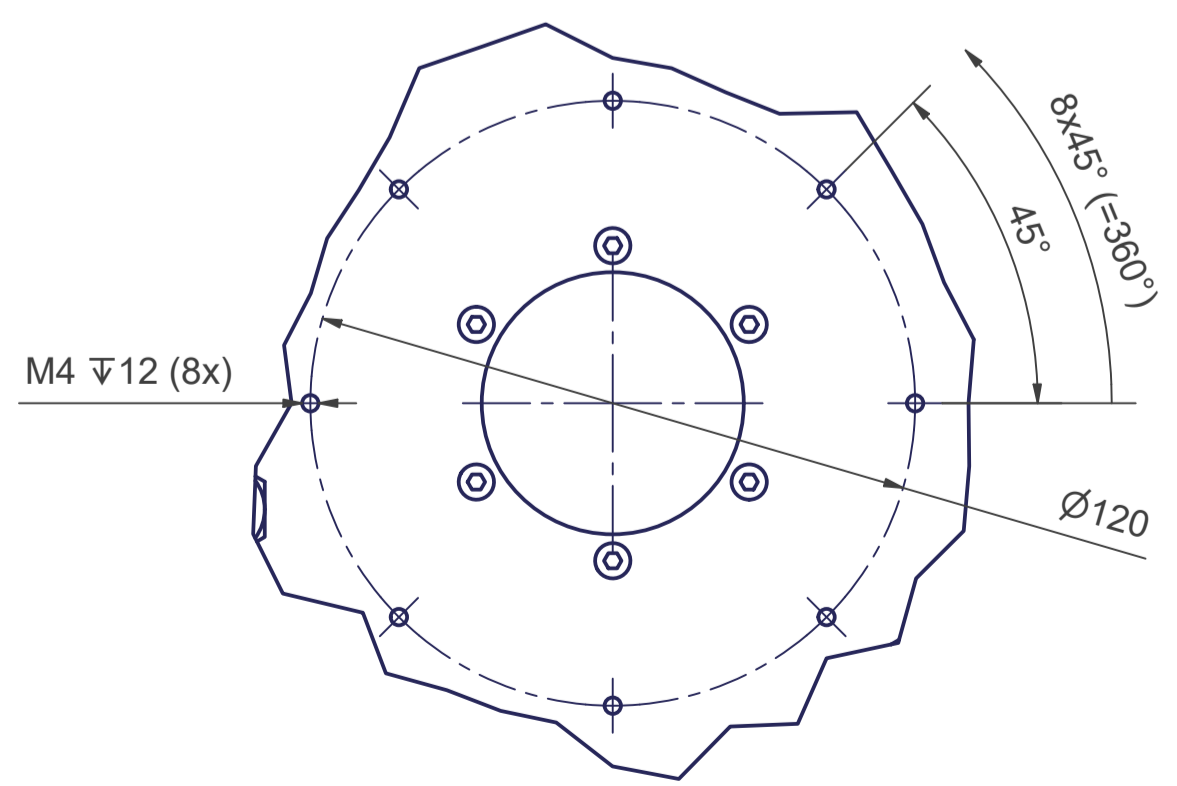

V (1:1)

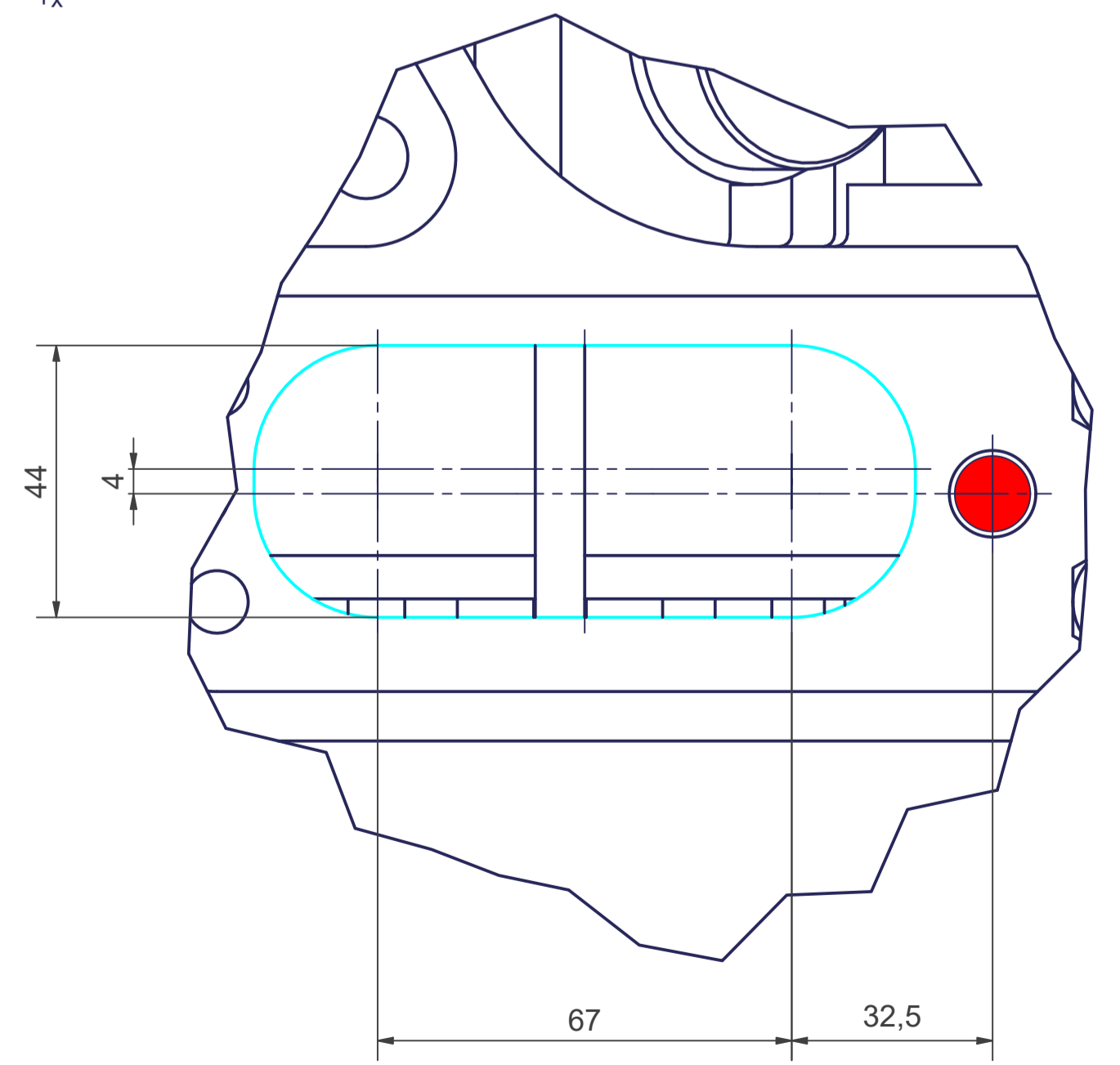

12 11 10 9 8 7 6 5 4 3 2 1