

Optional Bellows (1:2)

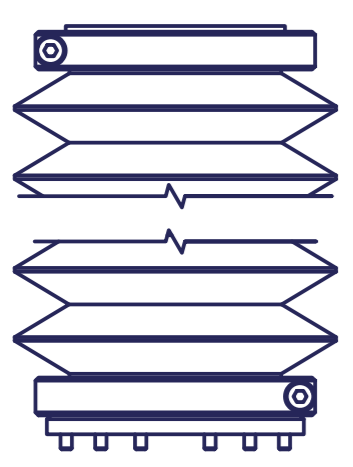

TCP - working range when using optional Bellows (MT_BGR00105809)

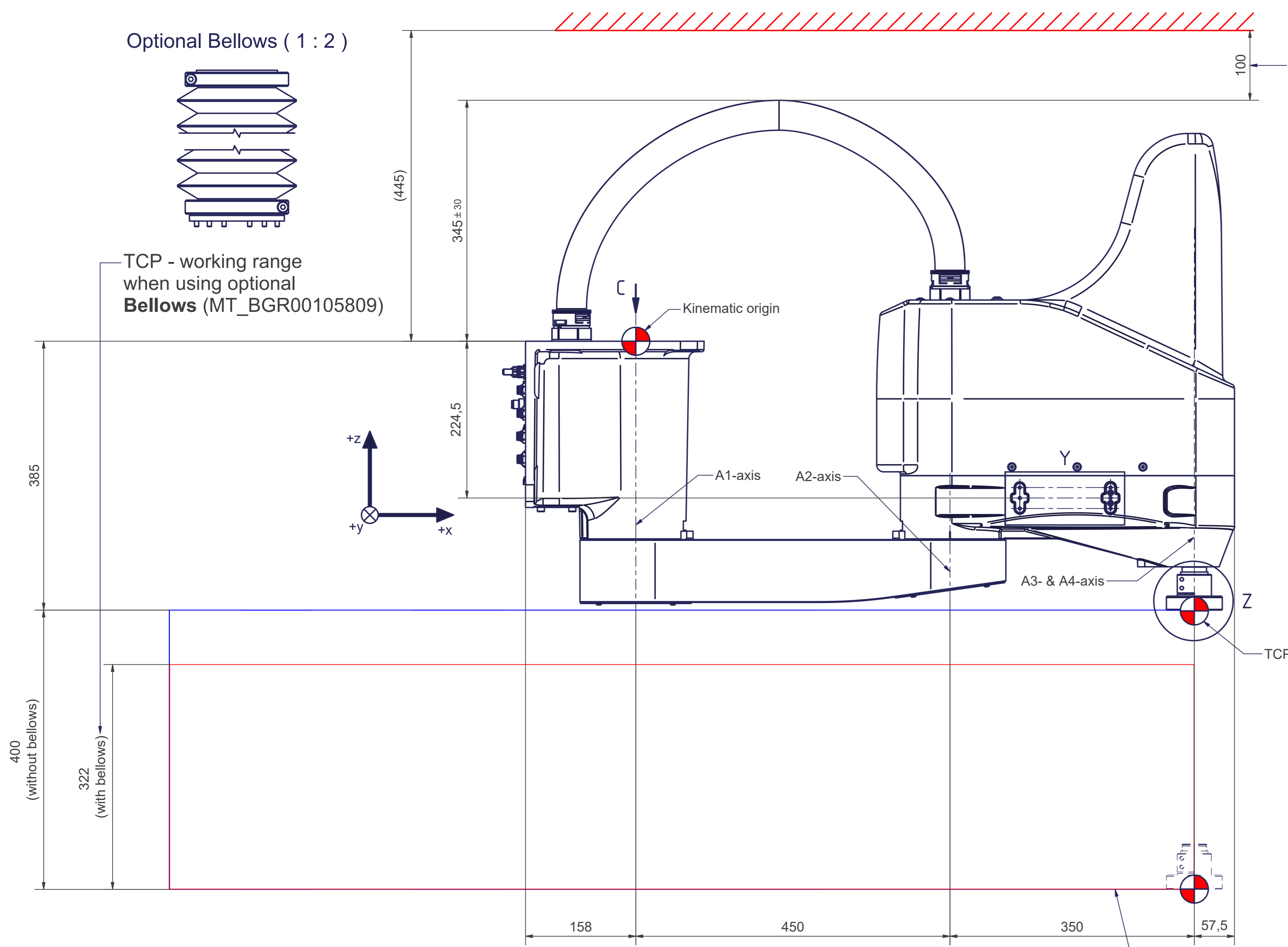

A minimum distance of 100mm between the cable harness and any (machine)parts is recommended to avoid any collision

A (2:1)
Tool mounting flange

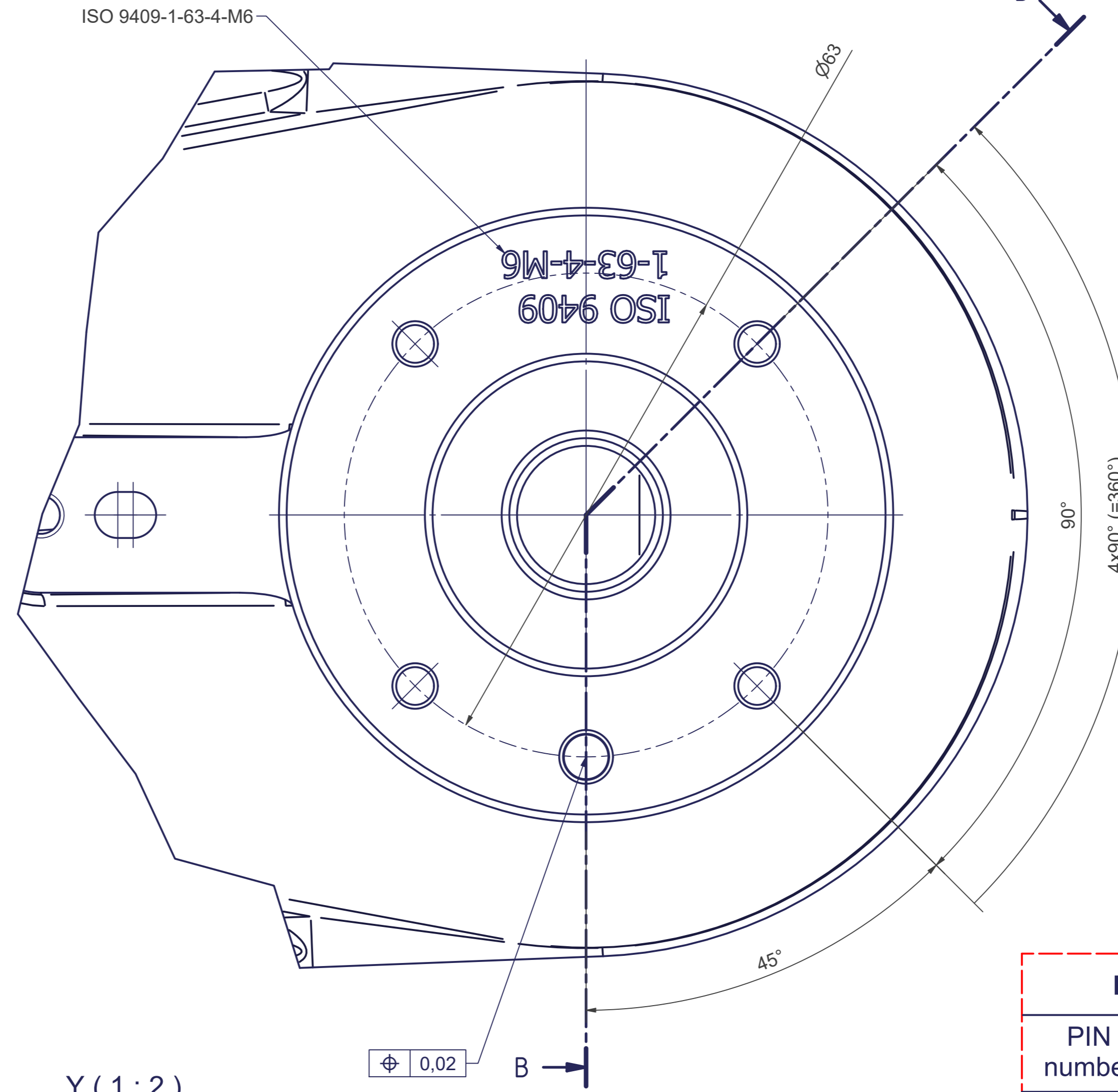

B-B

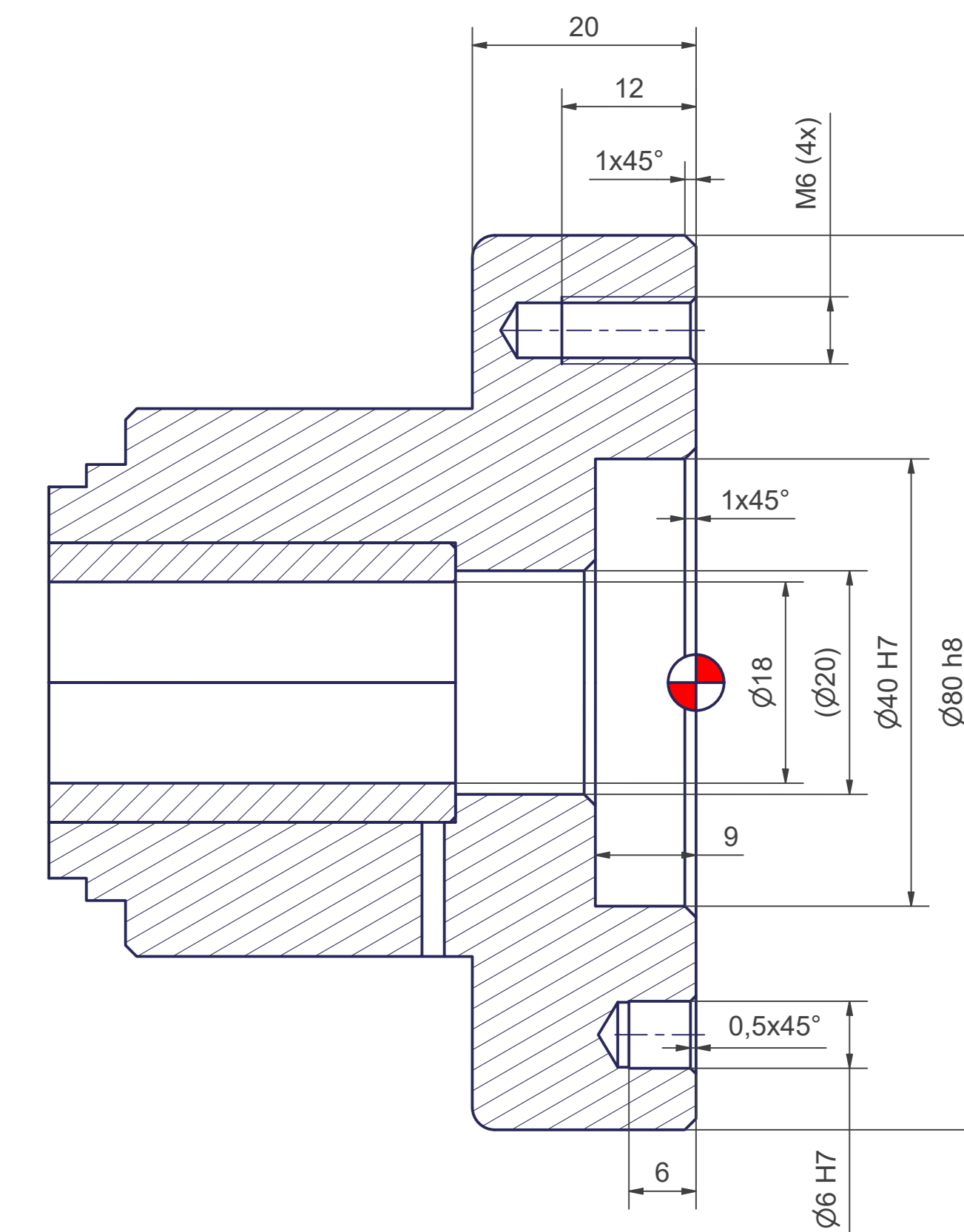

PIN assignment by autonox Robotics

| PIN number | Connection to | M12 8-pin male |
|------------|---------------|----------------|
| 1 | Push button | |
| 2 | Push button | |
| 3 to 8 | Not connected | |

Y (1:2)

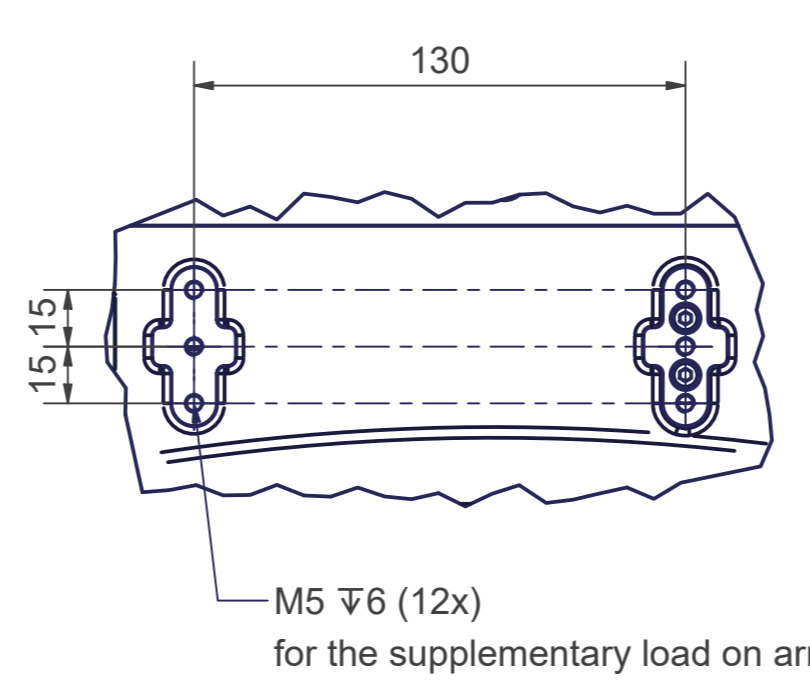

C (1:2)
Base frame

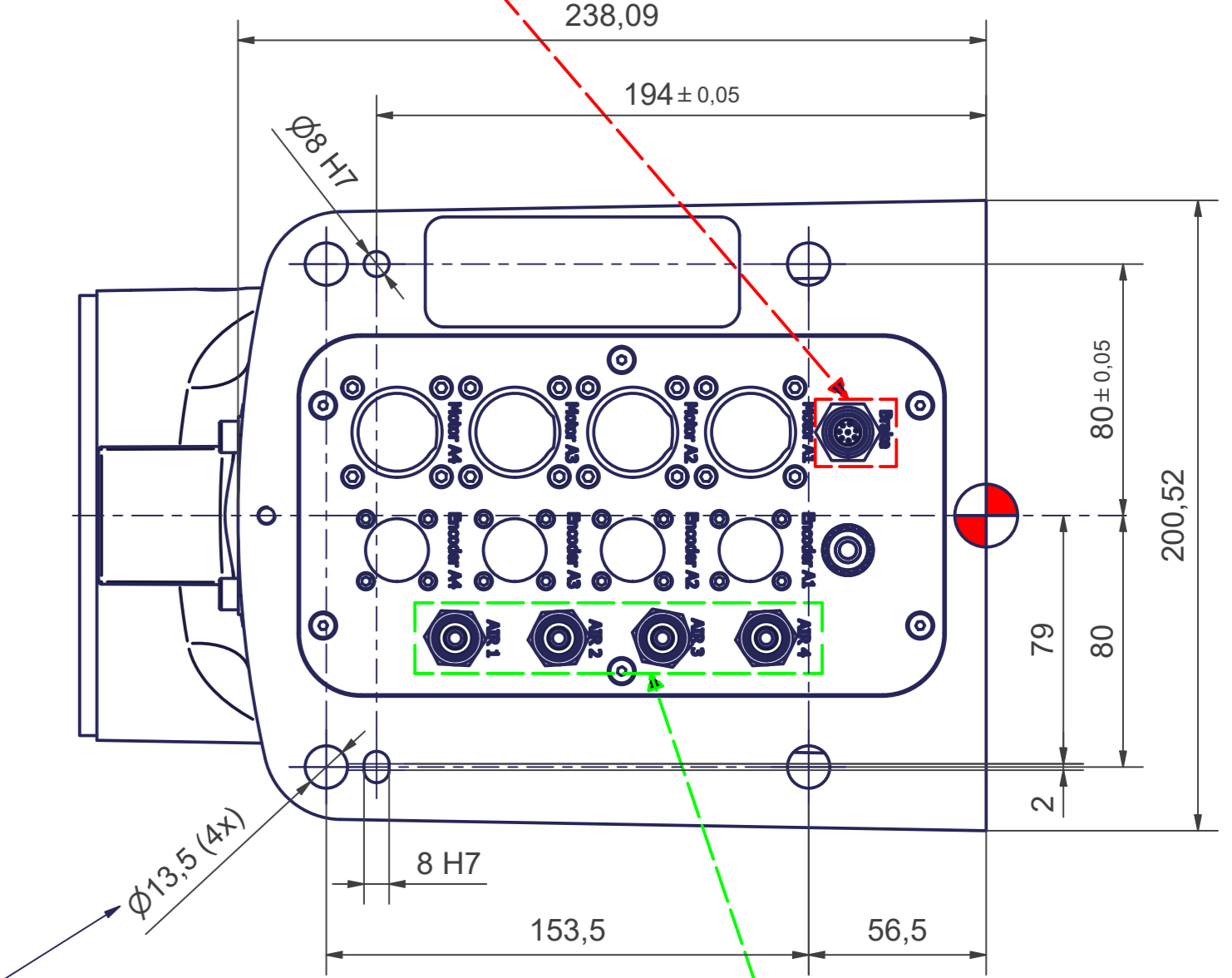
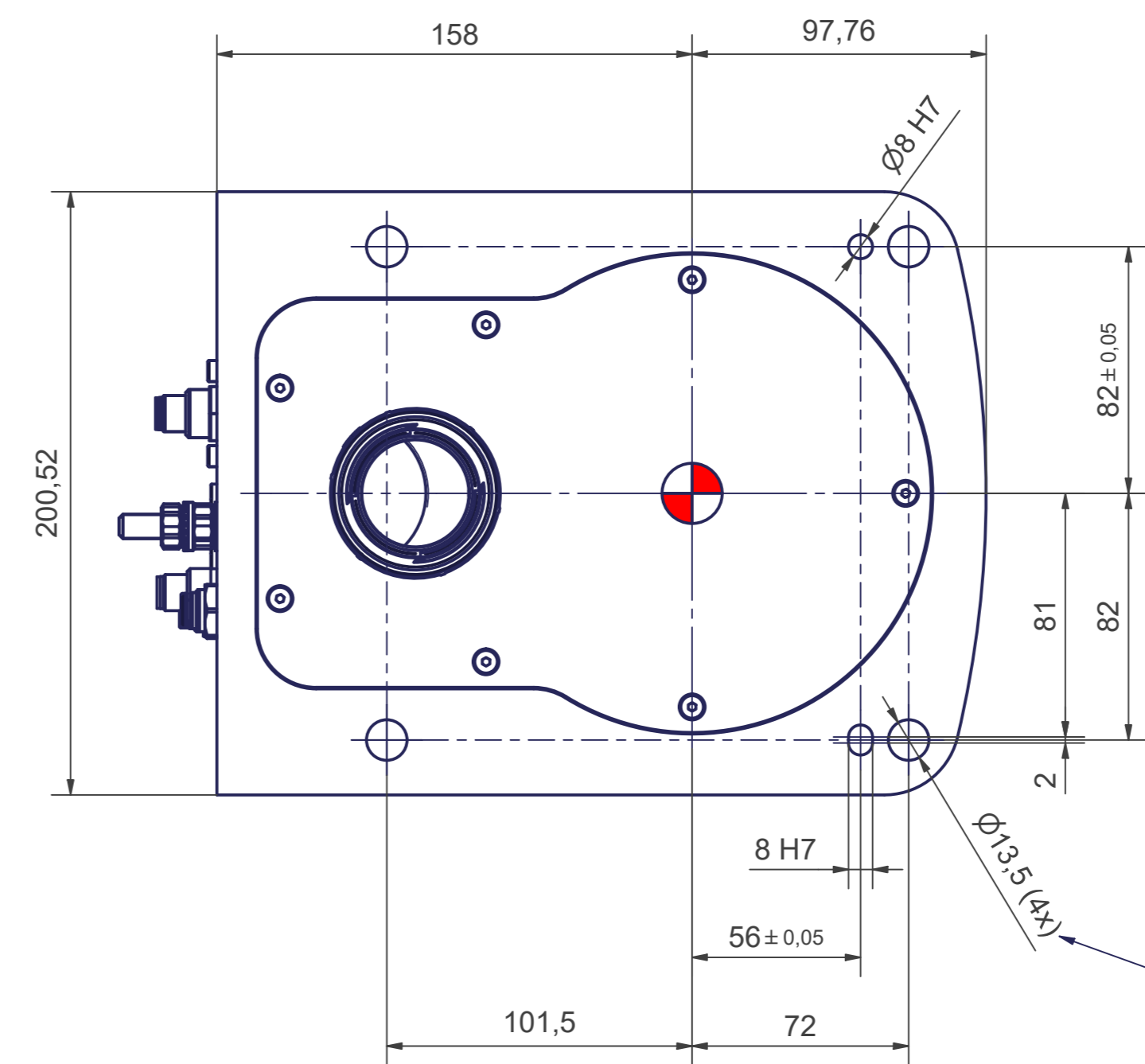

for screws M12 (DIN ISO 4014/4017-8.8) the tightening torque for these screws is 83 Nm (in steel frame).

Incl. fourfold integrated media supply to the end effector (compressed air 8 bar / vacuum -1 bar / D = 6mm d = 4mm)

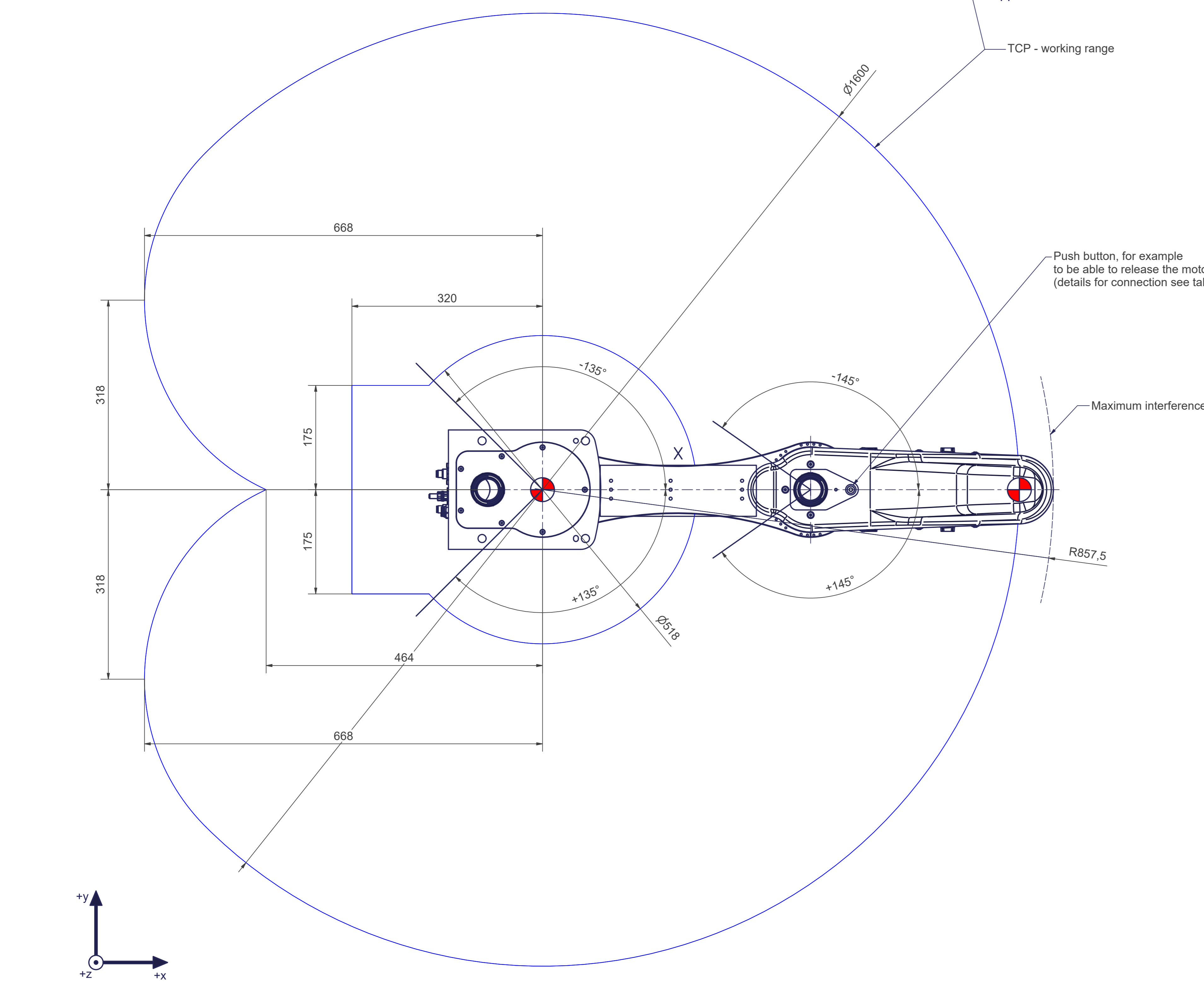

Z (1:1)

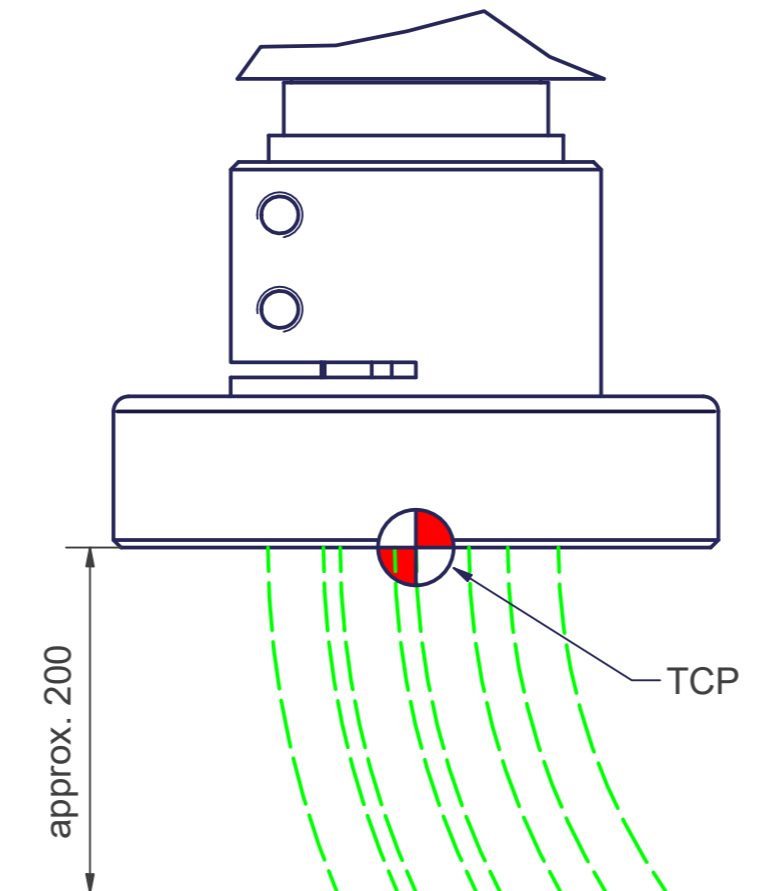

Incl. fourfold integrated media supply to the end effector (compressed air 8 bar / vacuum -1 bar / D = 6mm d = 4mm)

X (1:2)

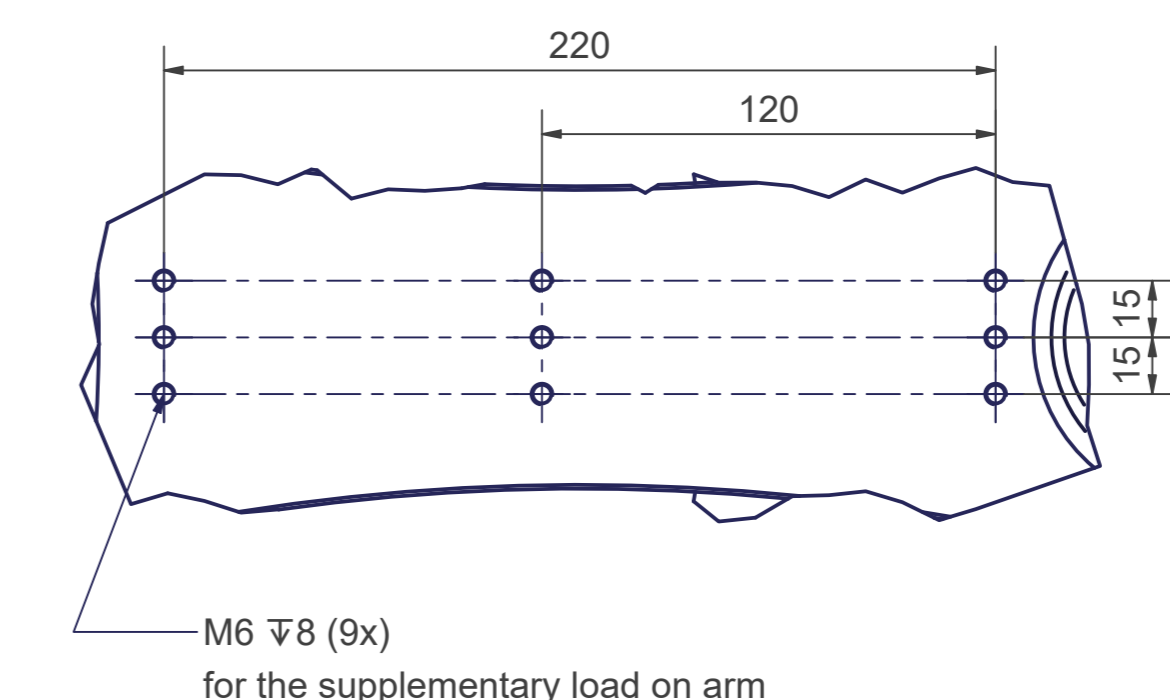

| sCara4-800-6kg | | Motion | |
|-------------------|----------------------|--------|---------------------|
| Axes | 4 | Axes | Range fully usable |
| Payload (on TCP) | 6kg | A1 | ± 135° |
| Reach | 800 mm | A2 | ± 145° |
| Mounting position | Floor, ceiling, wall | A3 | - 385 mm / - 785 mm |
| | | A4 | ± 360° |

More information can be found in the document "calibration dimensions"

Connecting dimensions, valid for article number: AT_00024-01-400

| | | | |
|------------------|------------------|----------------|-------|
| kg | kg | A | bar |
| m ² | m ² | P _z | l/min |
| U _z | U _z | V / Hz / Ph | |
| I _{max} | I _{max} | A | |

OPTIONAL:

Bellows MT_BGR00105809

