

Optional Bellows (1:2)

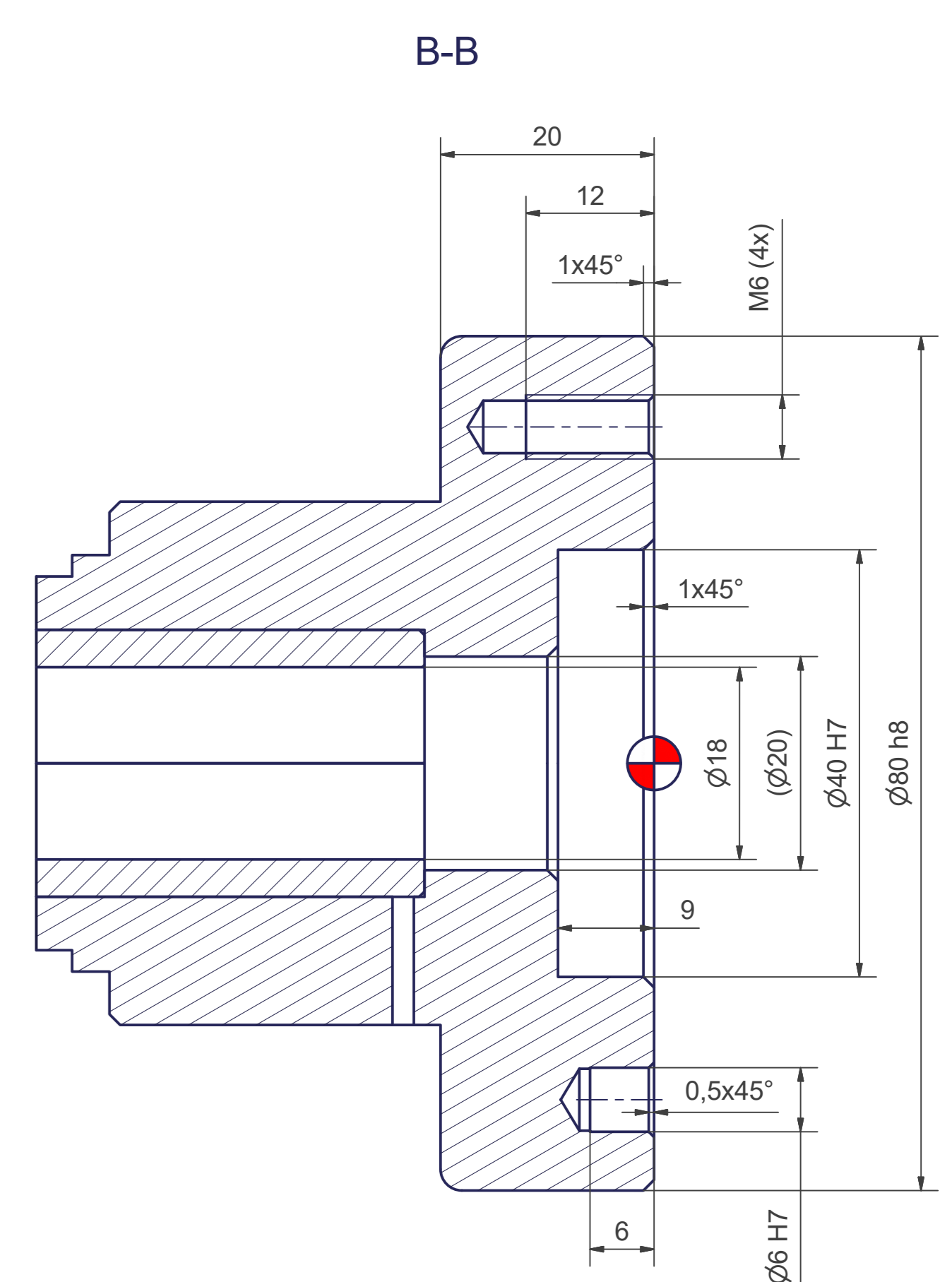

PIN assignment by autonox Robotics

PIN number	Connection to	M12 8-pin male
1	Push button	
2	Push button	
3 to 8	Not connected	

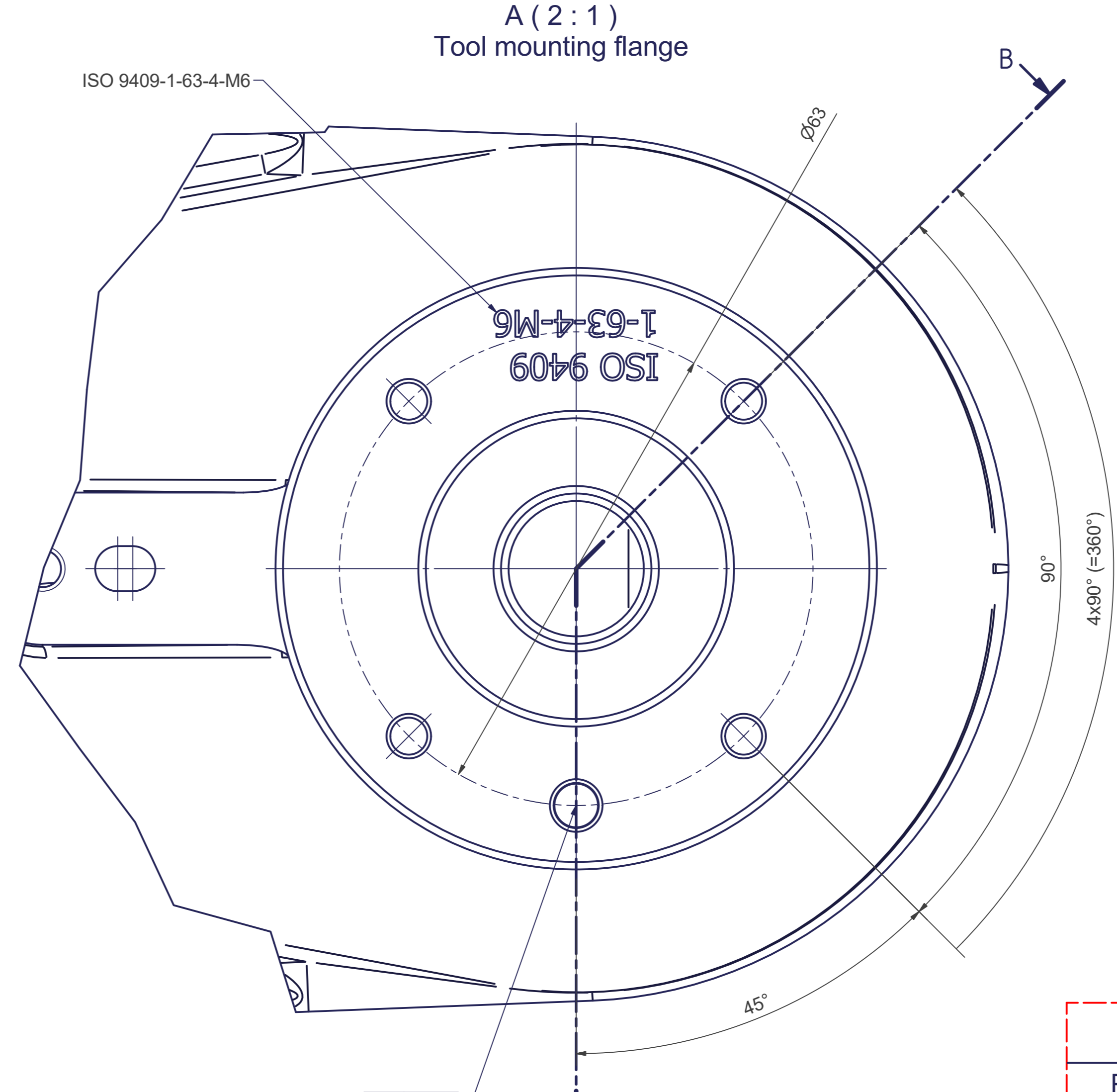
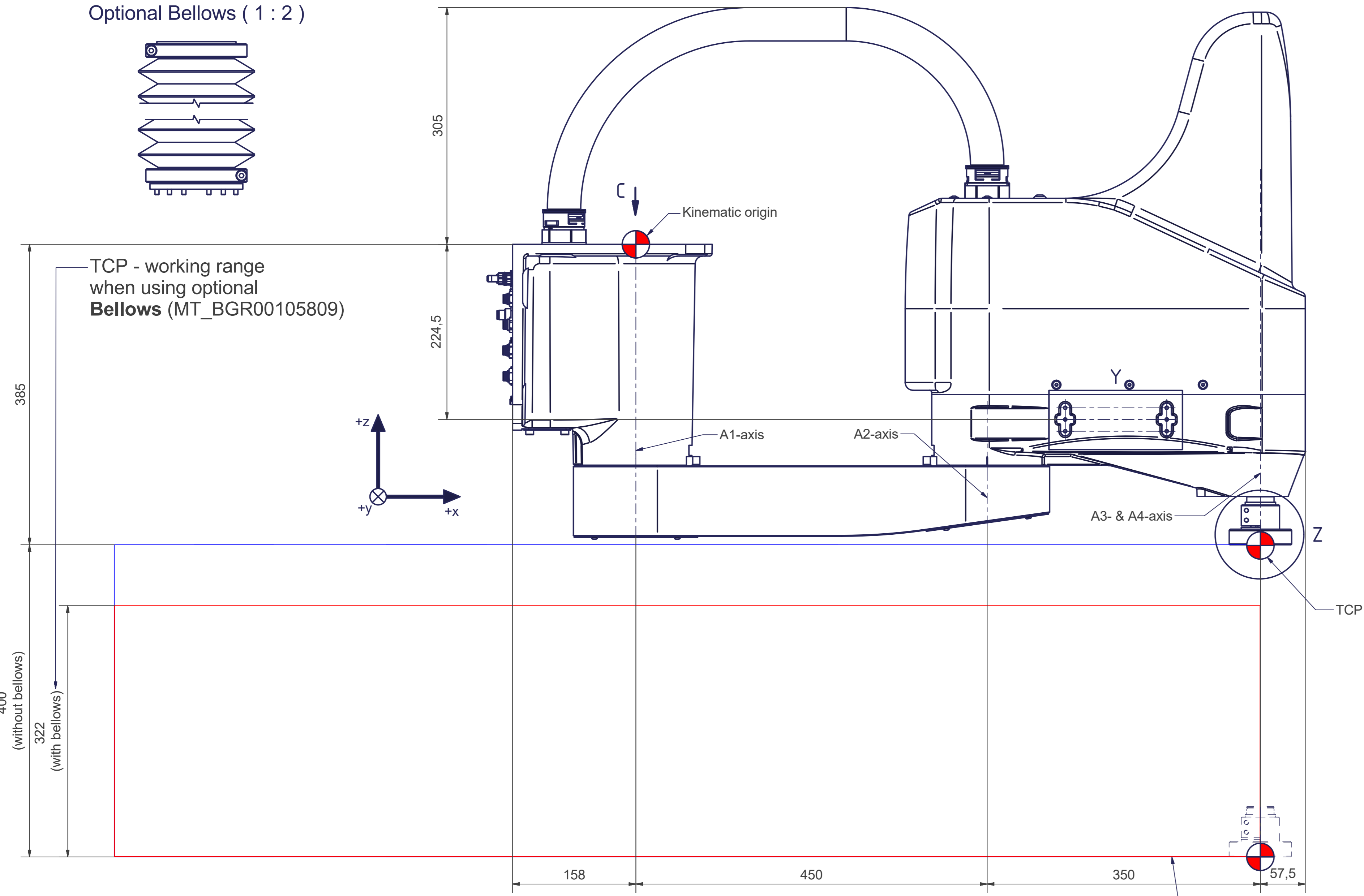
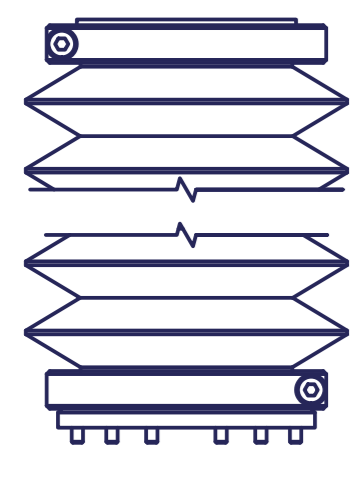
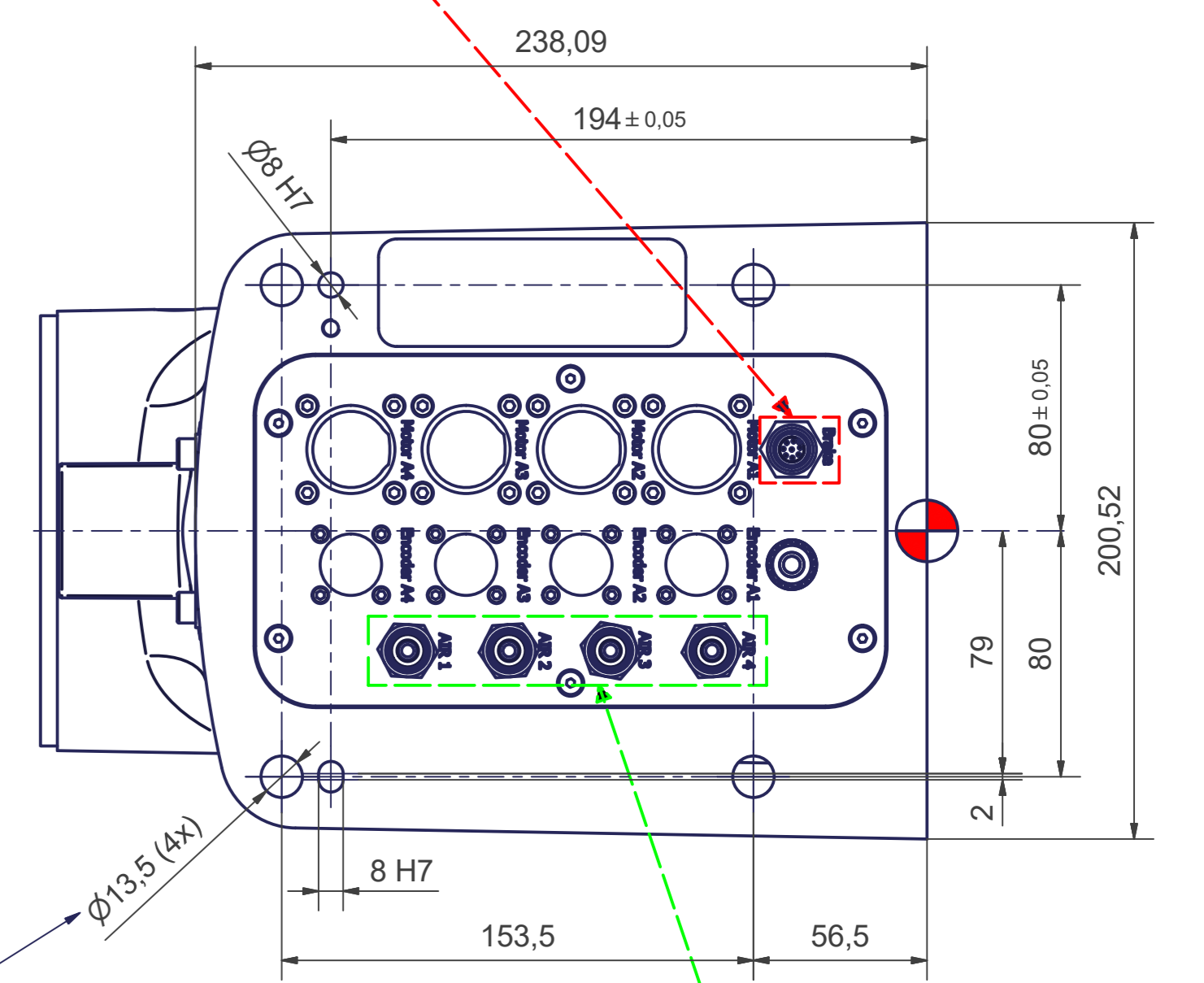
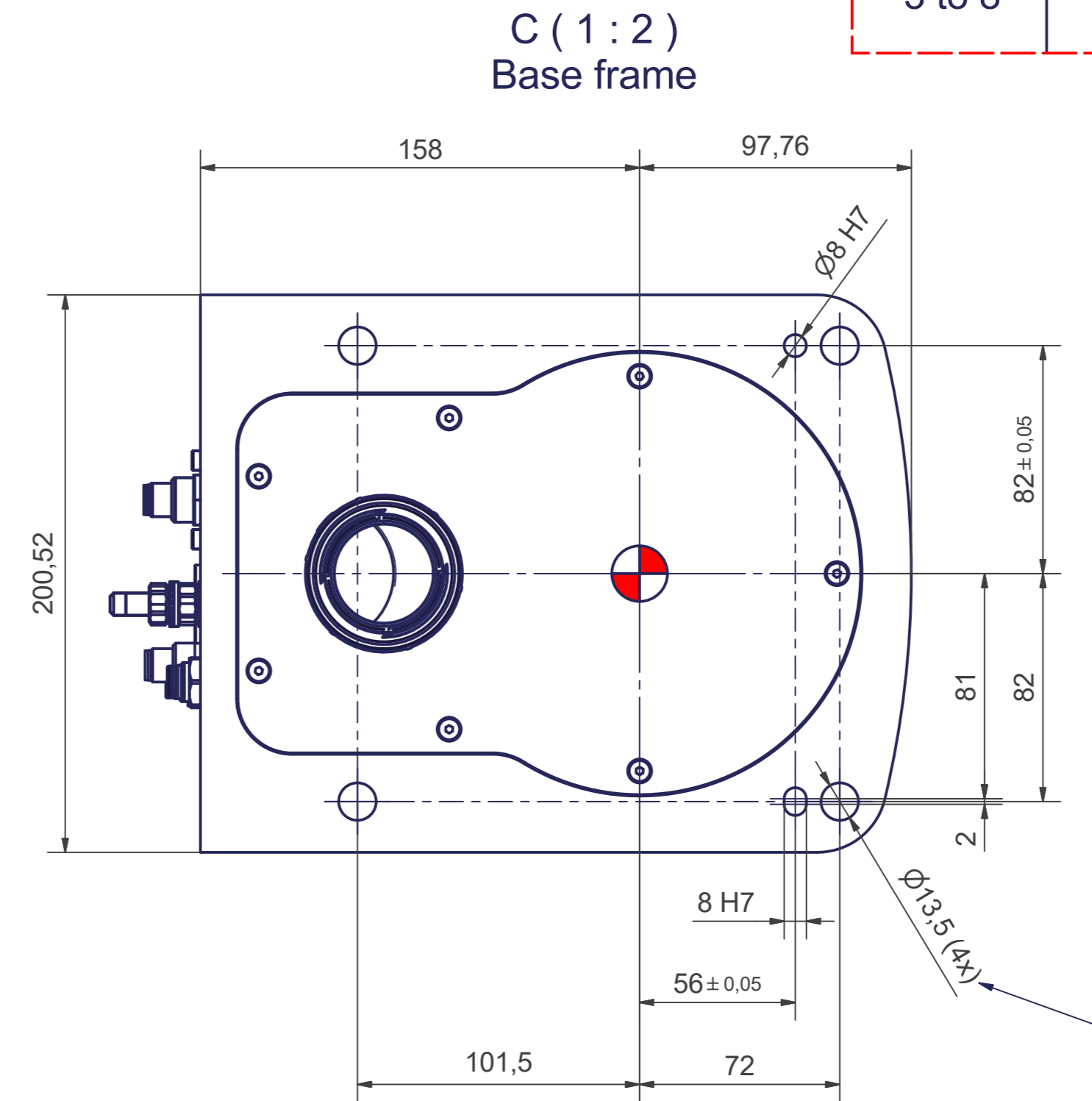
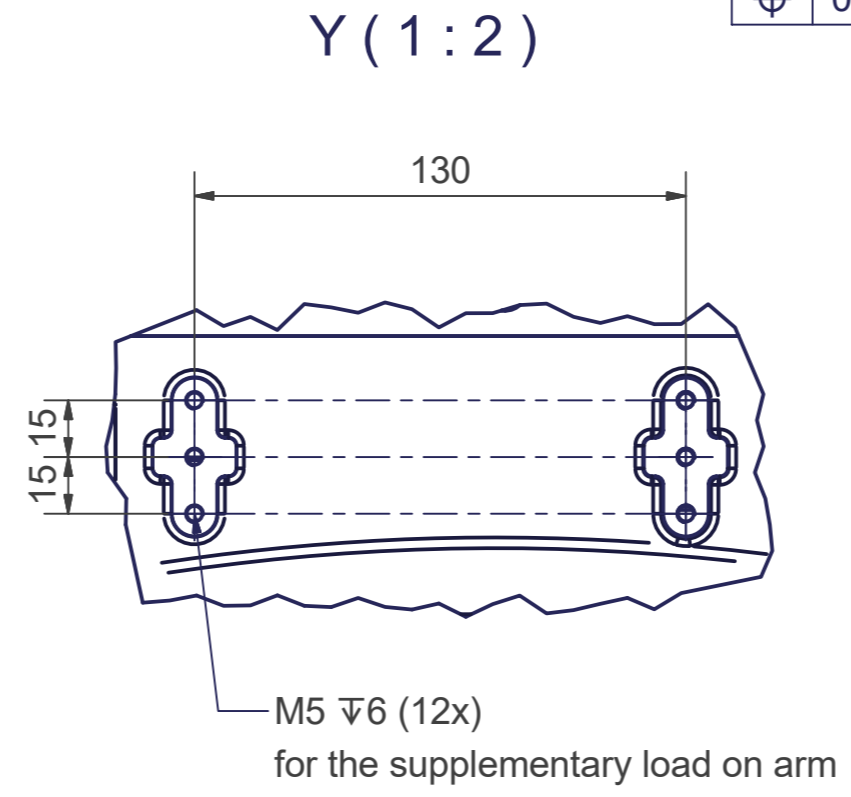

for screws M12 (DIN ISO 4014/4017-8.8) the tightening torque for these screws is 83 Nm (in steel frame).

Incl. fourfold integrated media supply to the end effector (compressed air 8 bar / vacuum -1 bar / D = 6mm d = 4mm)

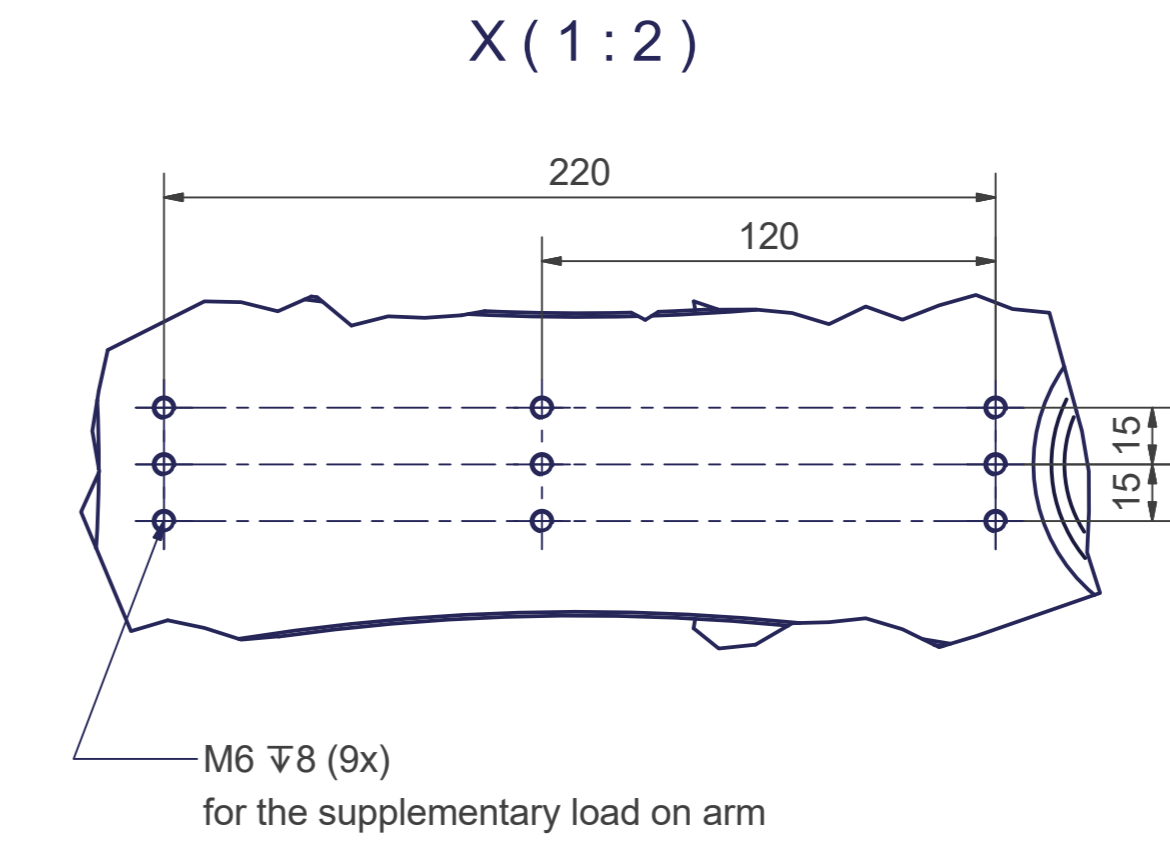
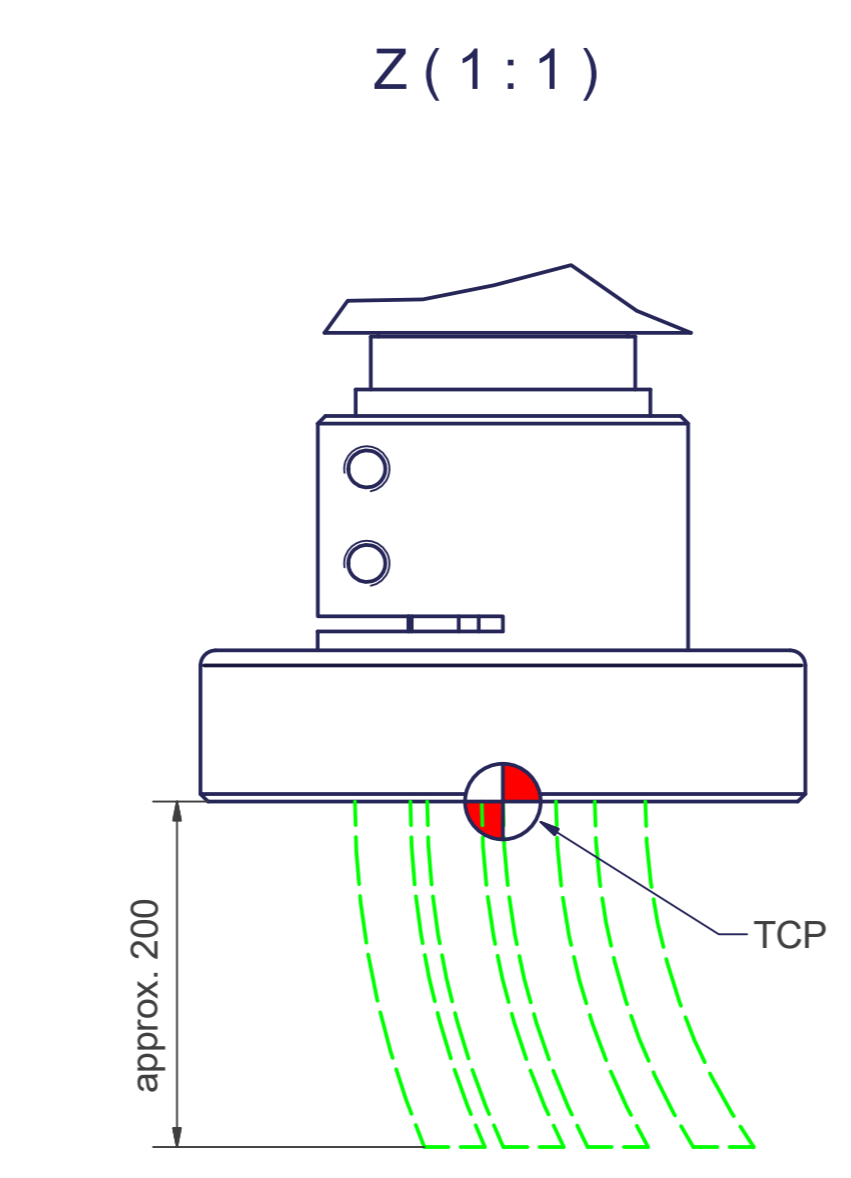
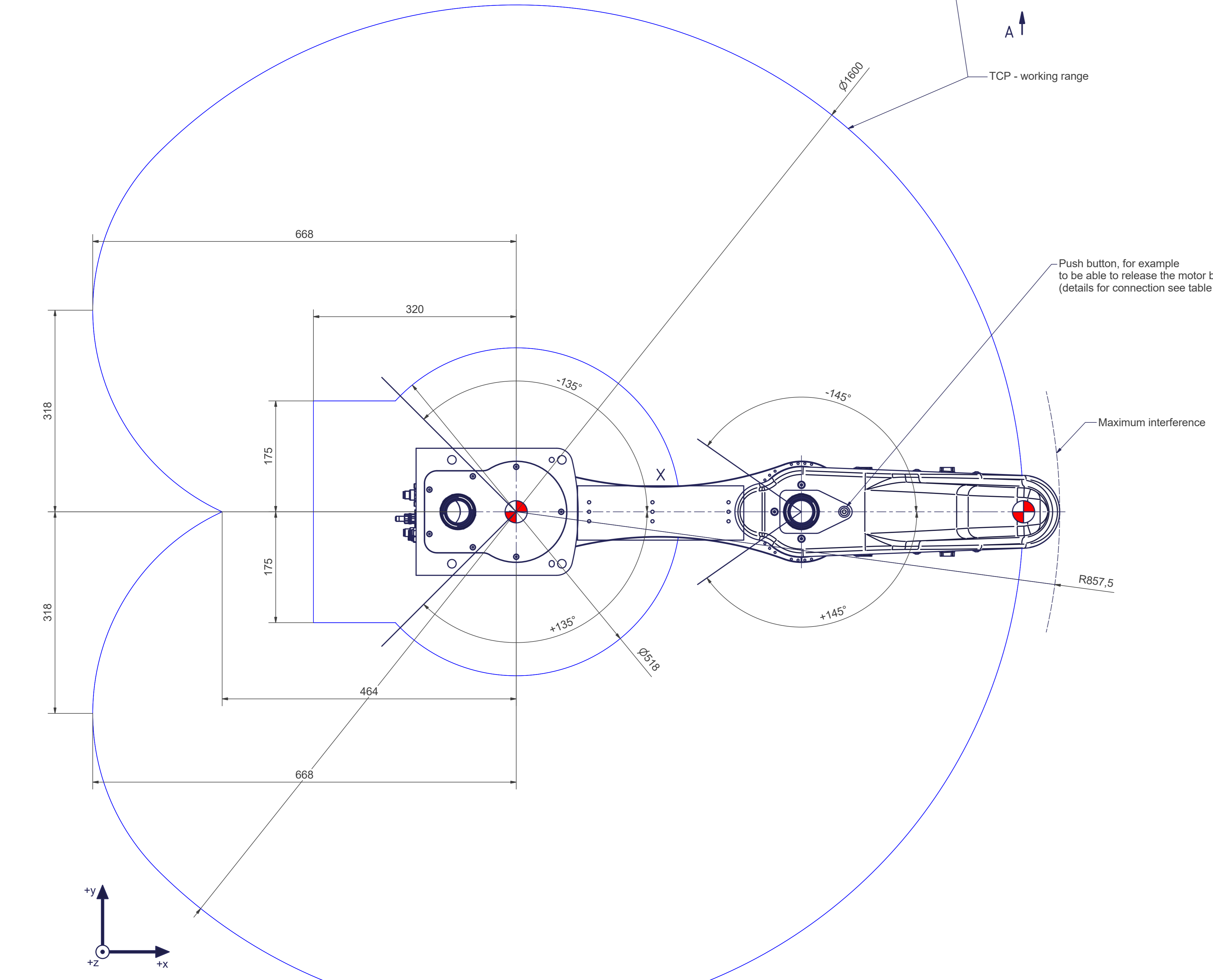

sCara4-800-6kg		Motion	
Axes	4	Axes	4
Payload (on TCP)	6kg	Range fully usable	
Reach	800 mm	A1	± 135°
Mounting position	Floor, ceiling, wall	A2	± 145°
		A3	- 385 mm / - 785 mm
		A4	± 360°

More information can be found in the document "calibration dimensions"

OPTIONAL:
Bellows MT_BGR00105809

Connecting dimensions, valid for article number: AT_00024-01-400

kg	kg	A	bar
m ²	m ²	P ₂	l/min
proj. storage surface =		U ₀	
		Imax _{ce}	
		V / Hz / Ph	
		A	