

Max. center of load (20kg)
 TCP (Tool Center Point)
 Max. area center of load
 More information can be found in the document "Load on tool flange"

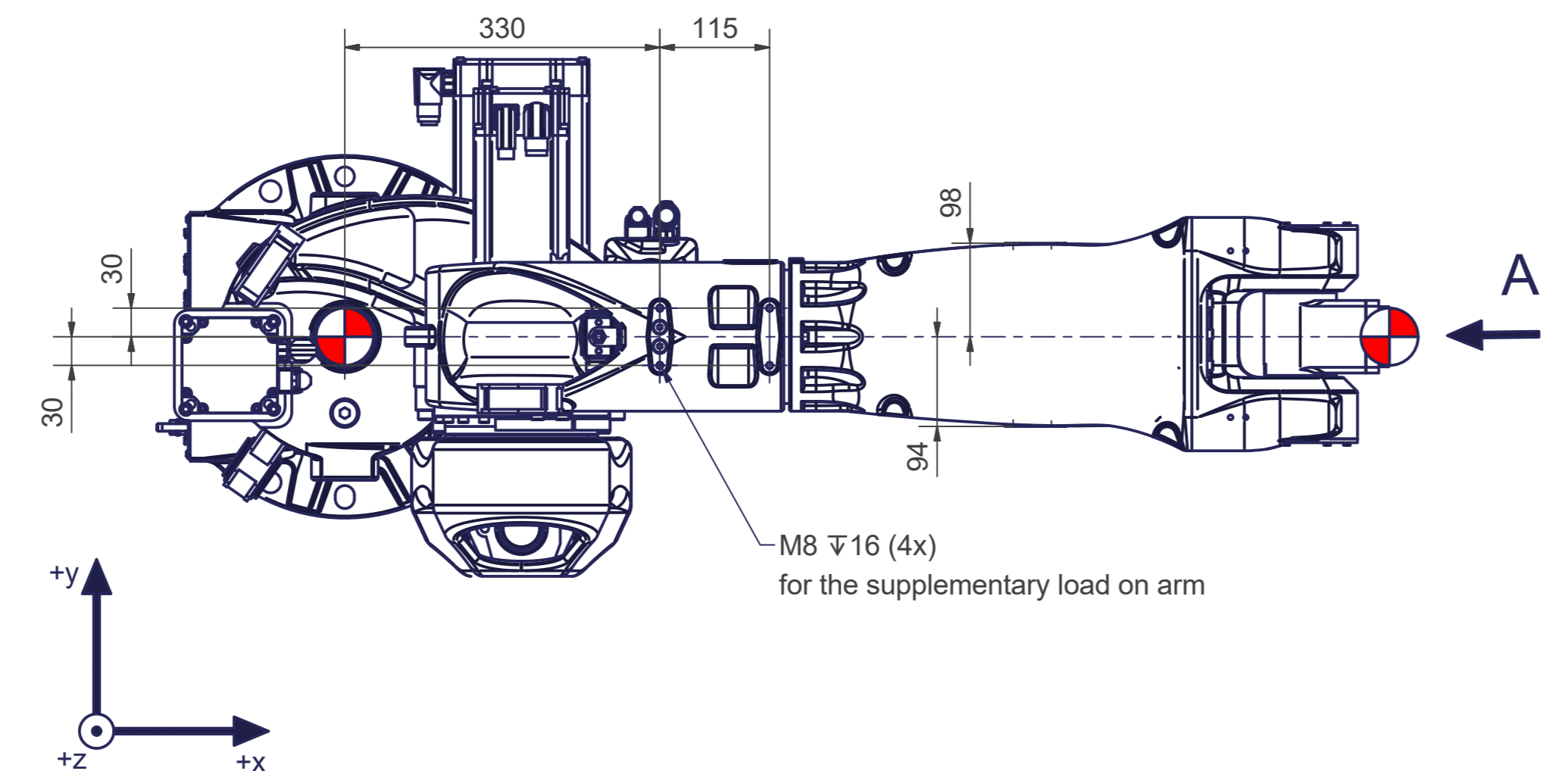
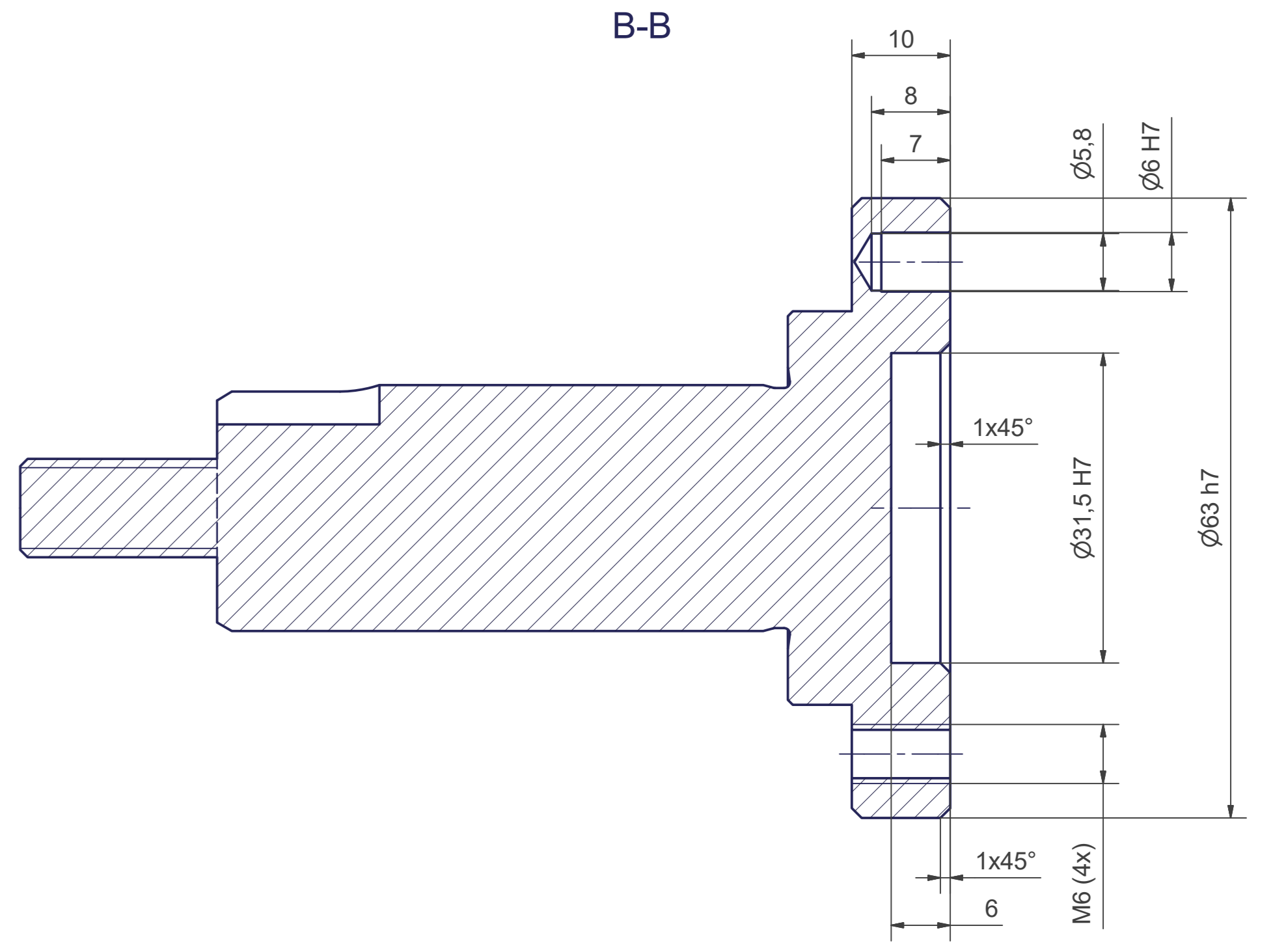
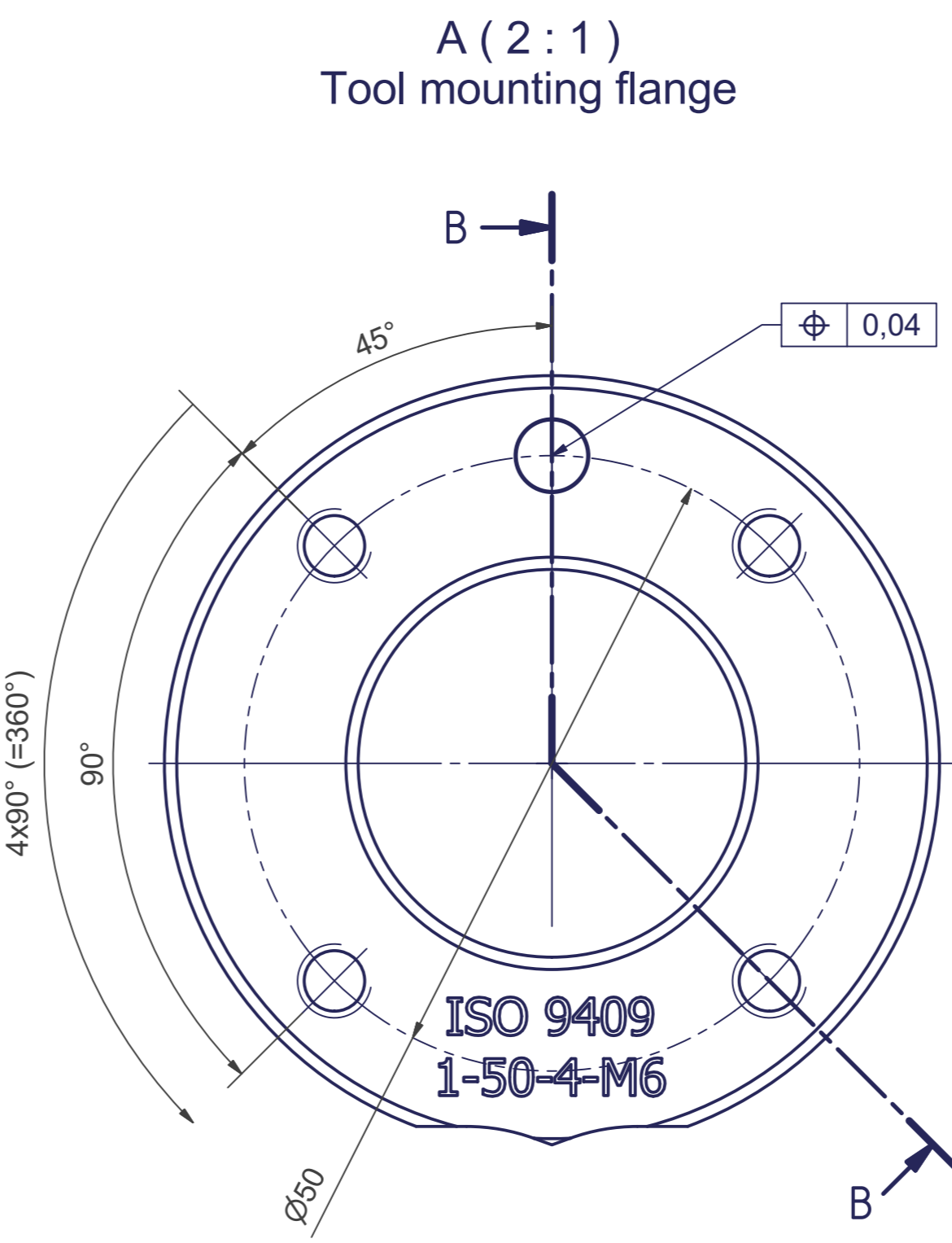
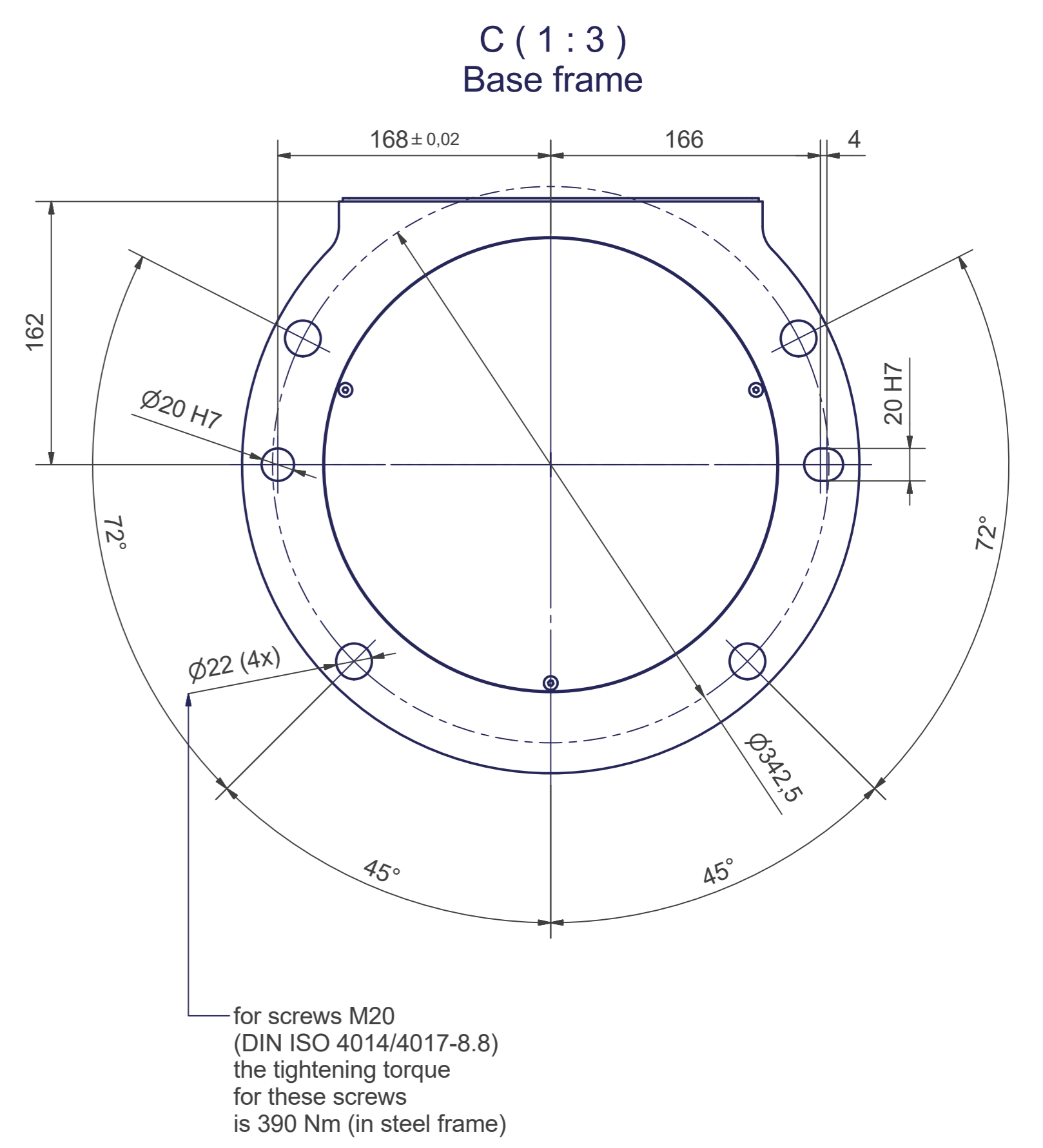
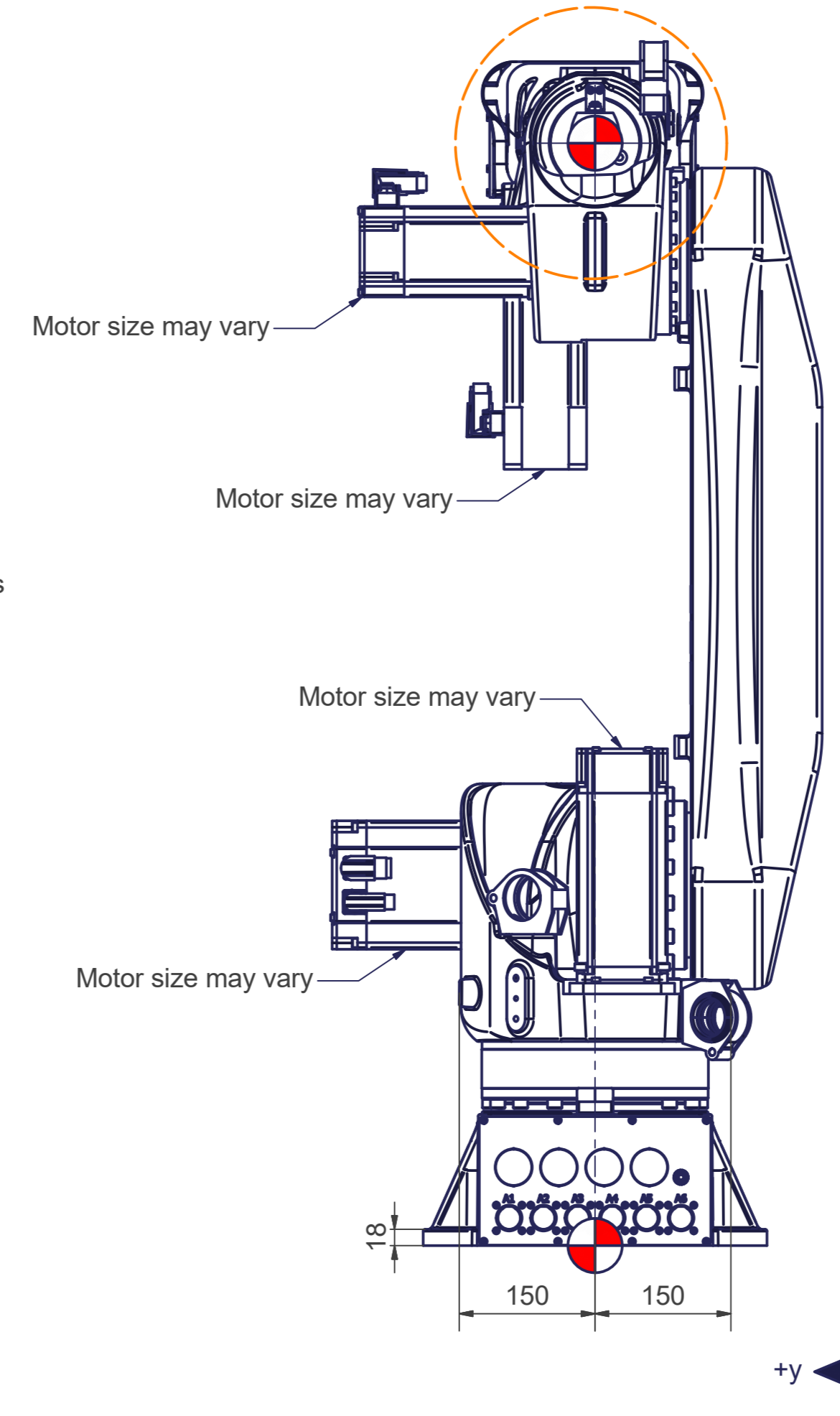

artic6-1803-20kg	
Axes	6
Payload (on TCP)	20 kg
Supplementary load on arm	10 kg
Reach	1803 mm
Mounting position	Angle, Ceiling, Floor, Wall

Motion	
Axes	Range fully usable
A1	± 185°
A2	- 88° / + 169° (*)
A3	- 142° / + 78° (*) (**)
A4	± 185°
A5	- 115° / + 125° (*)
A6	± 360°

(*) More information can be found in the document "calibration dimensions"
 (**) if axis 2 is between - 88° and - 80°, axis 3 must be limited on A3 = 78° - angle axis 2 + 80°

Connecting dimensions, valid for article number: AT_00014

