

A minimum distance of 100mm between the cable harness and any (machine) parts is recommended to avoid any collision

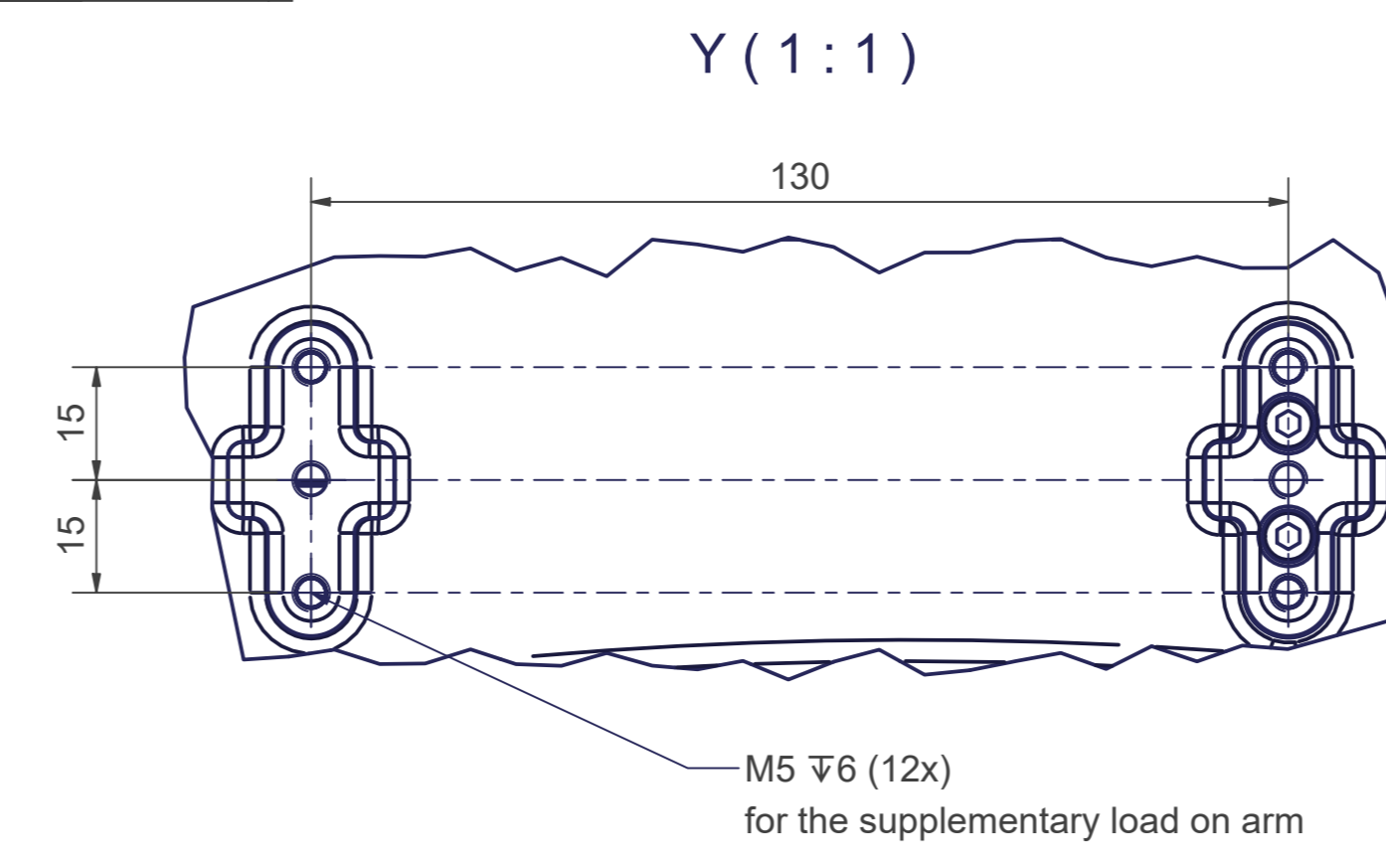

PIN assignment by autonox Robotics

PIN number	Connection to	M12 8-pin male
1	Push button	
2	Push button	
3 to 8	Not connected	

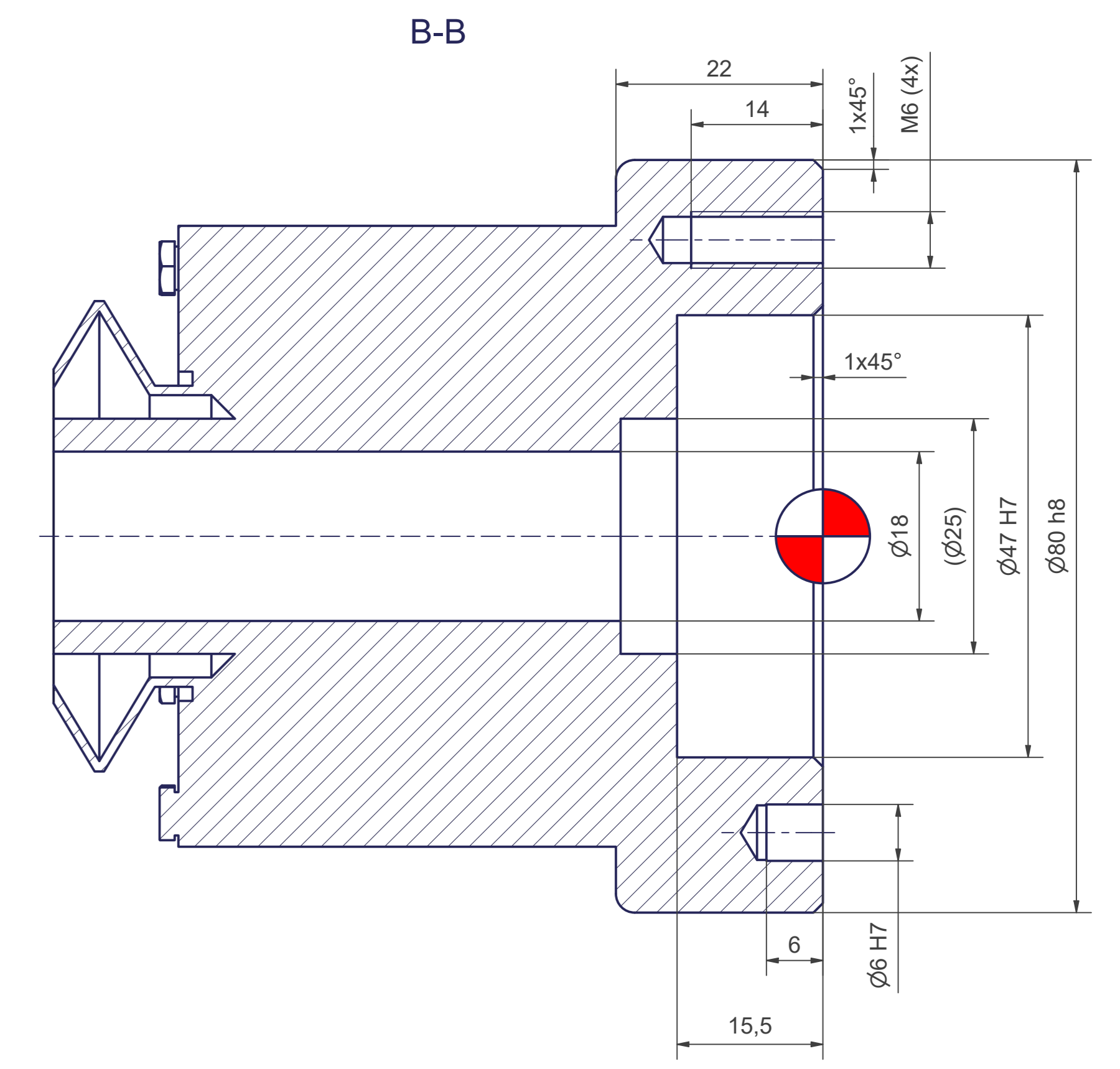
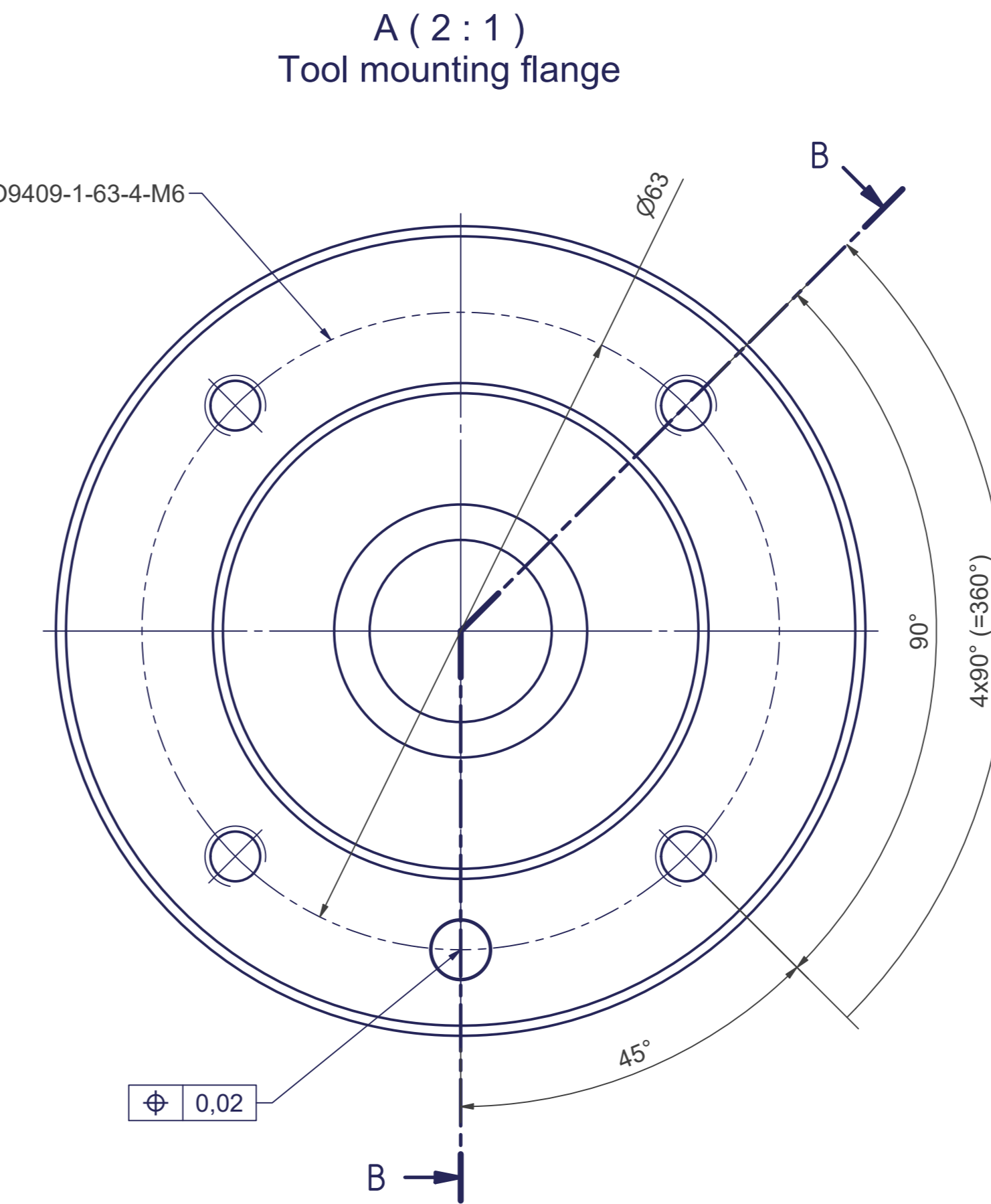
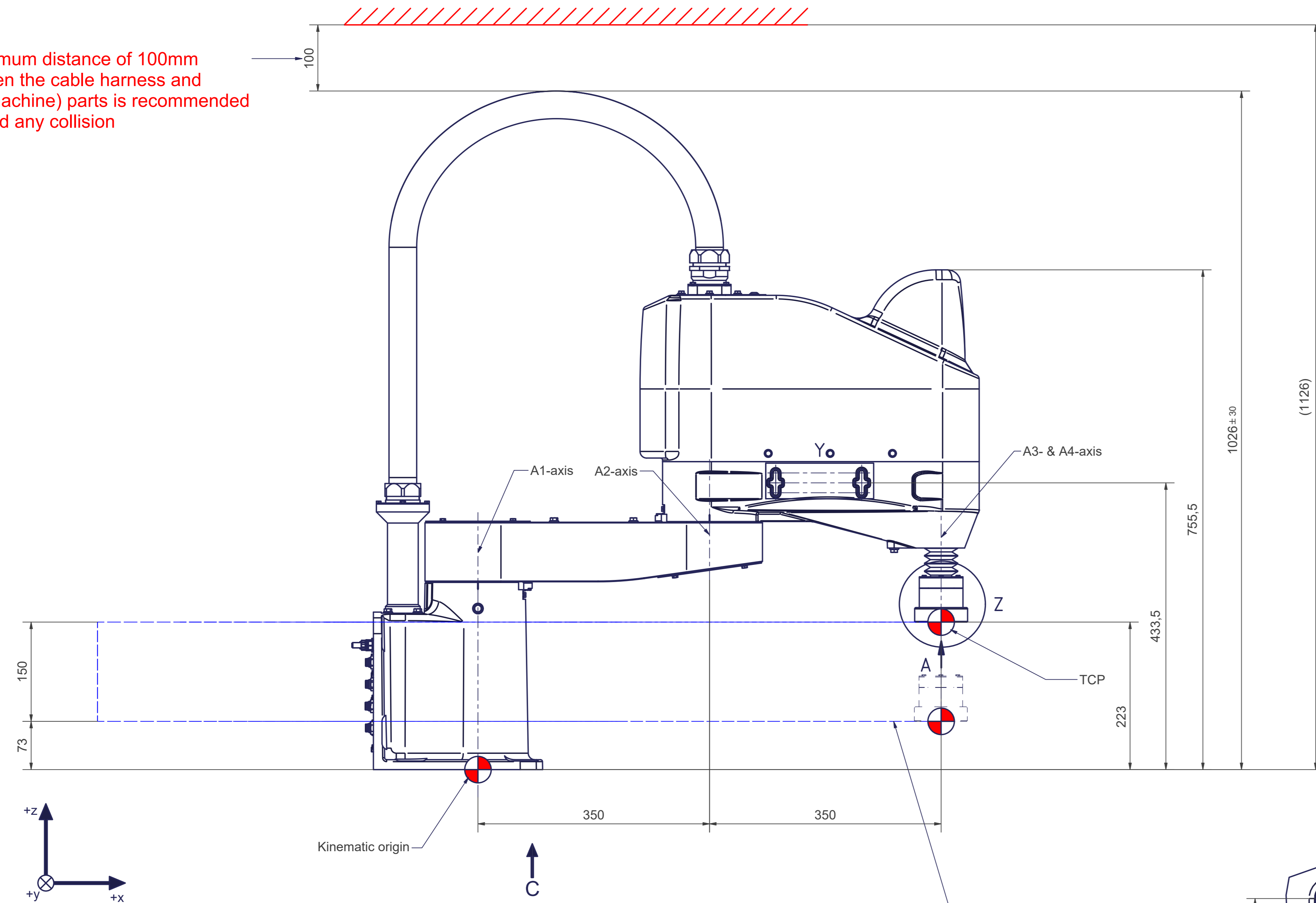
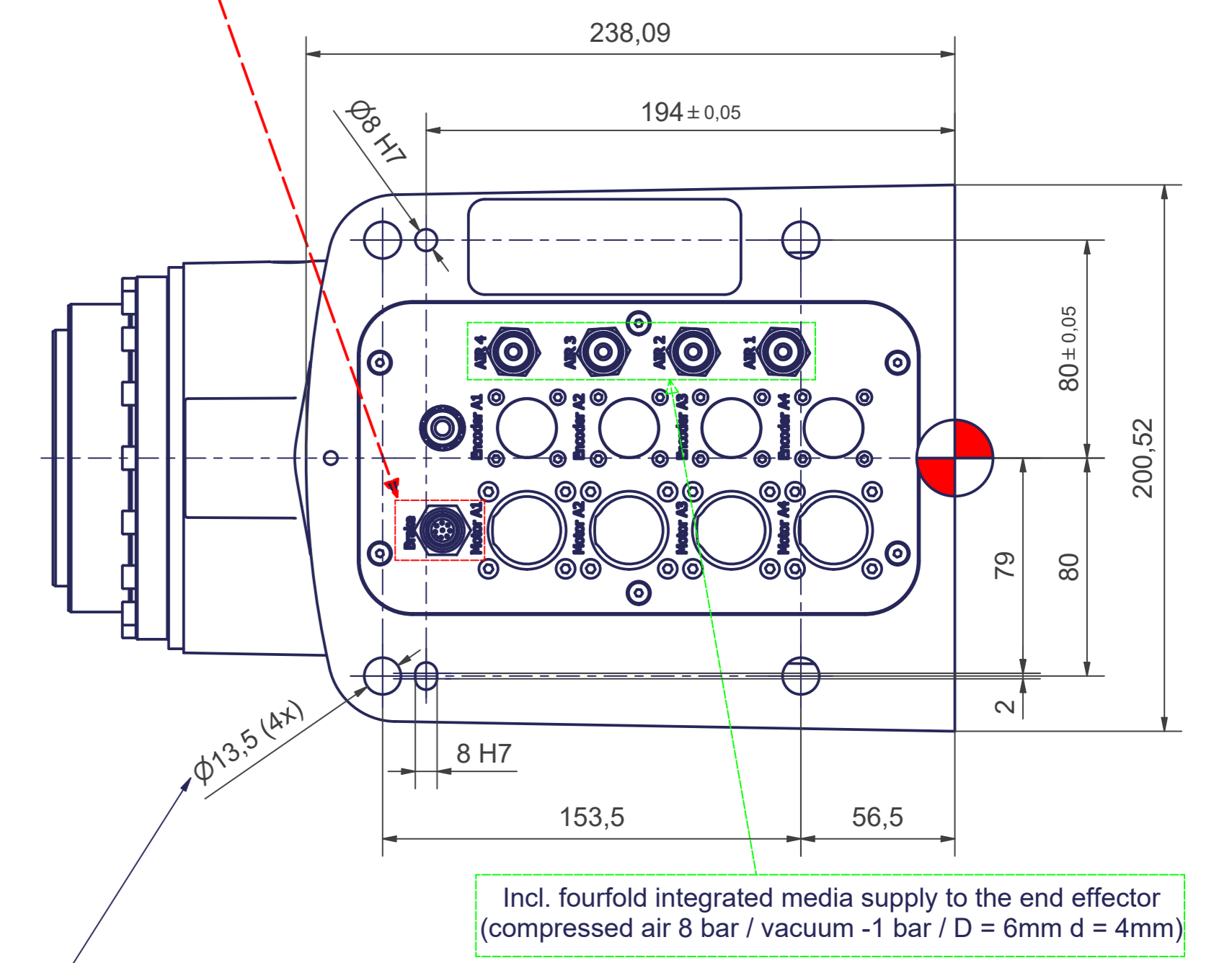
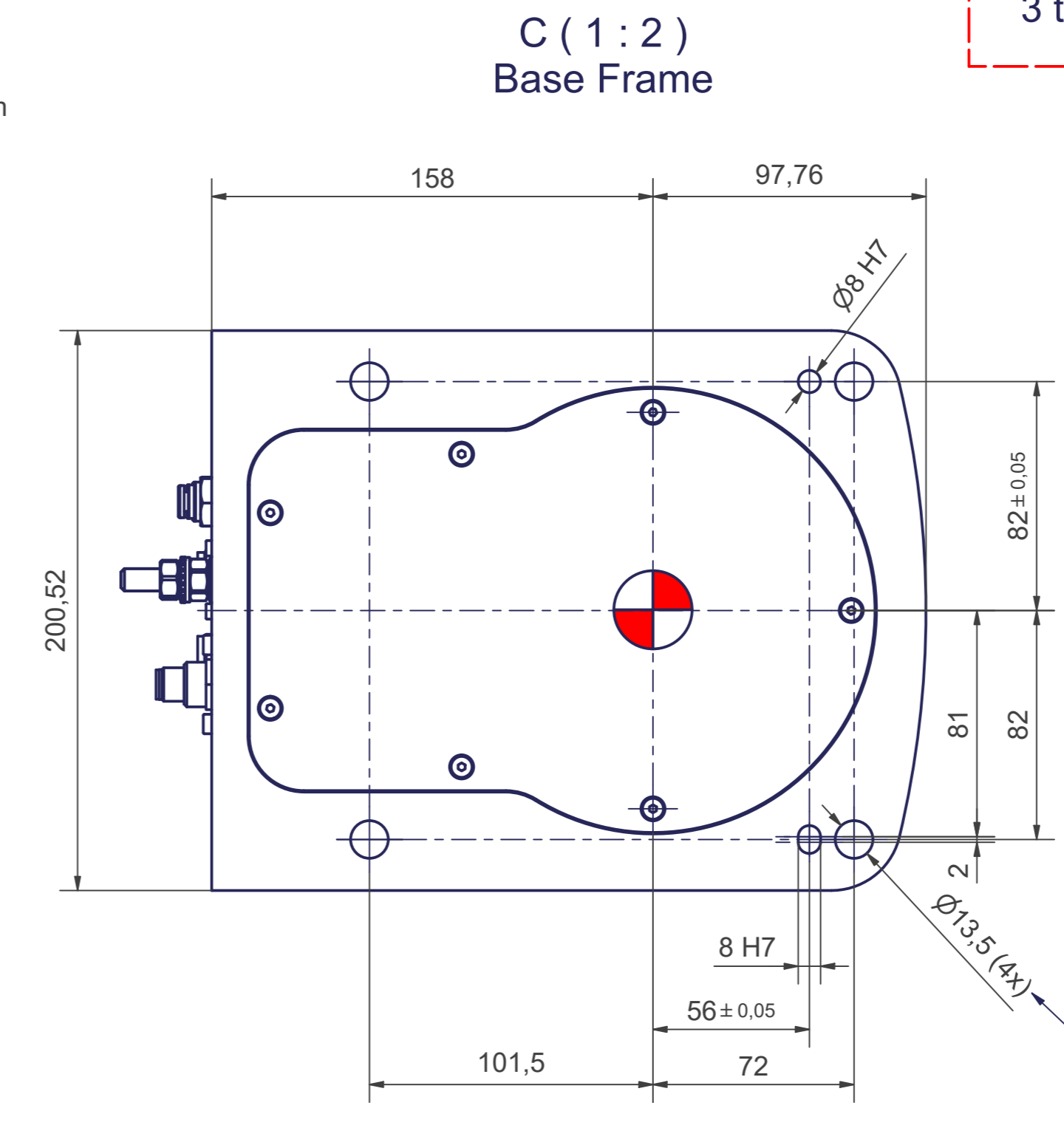
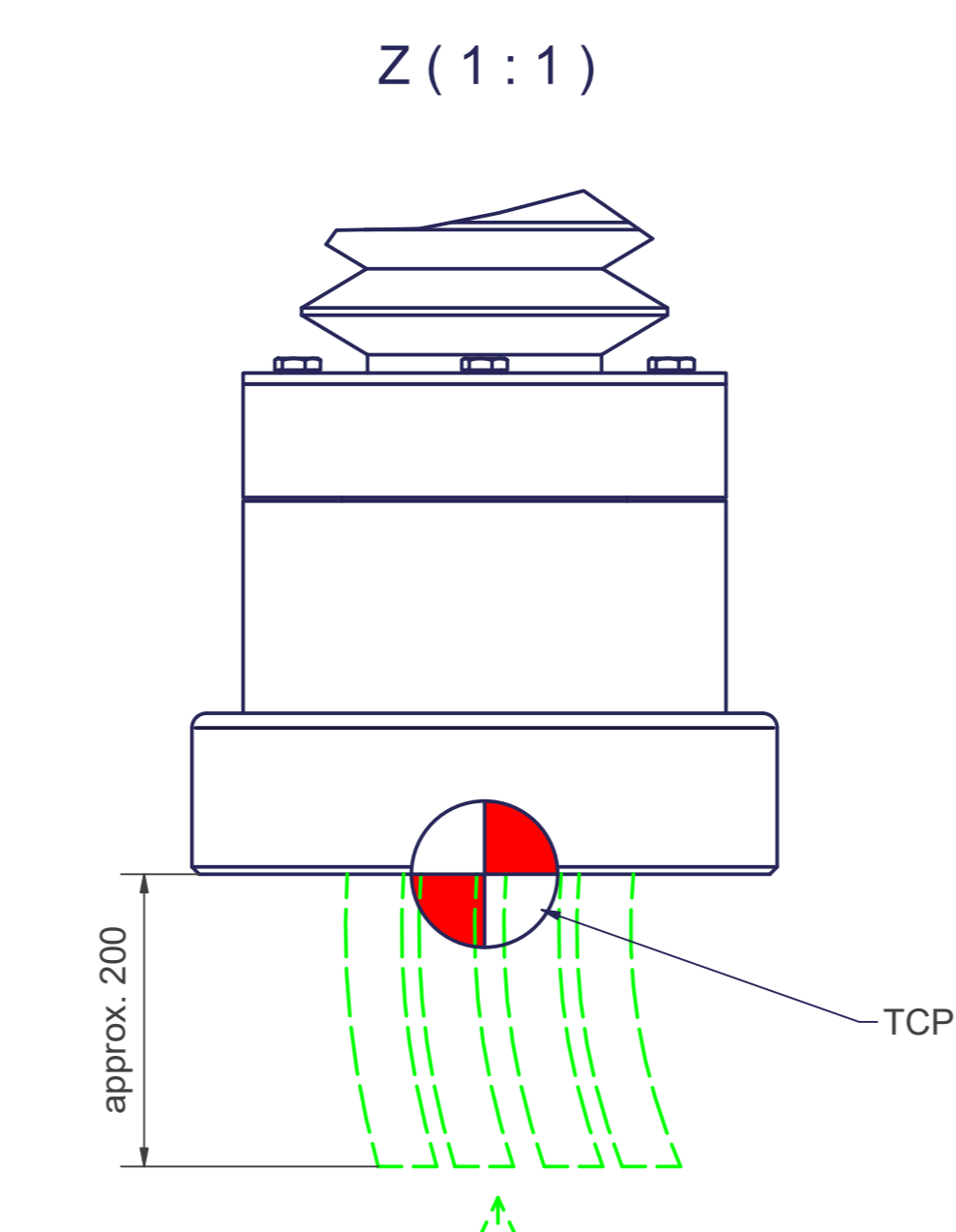
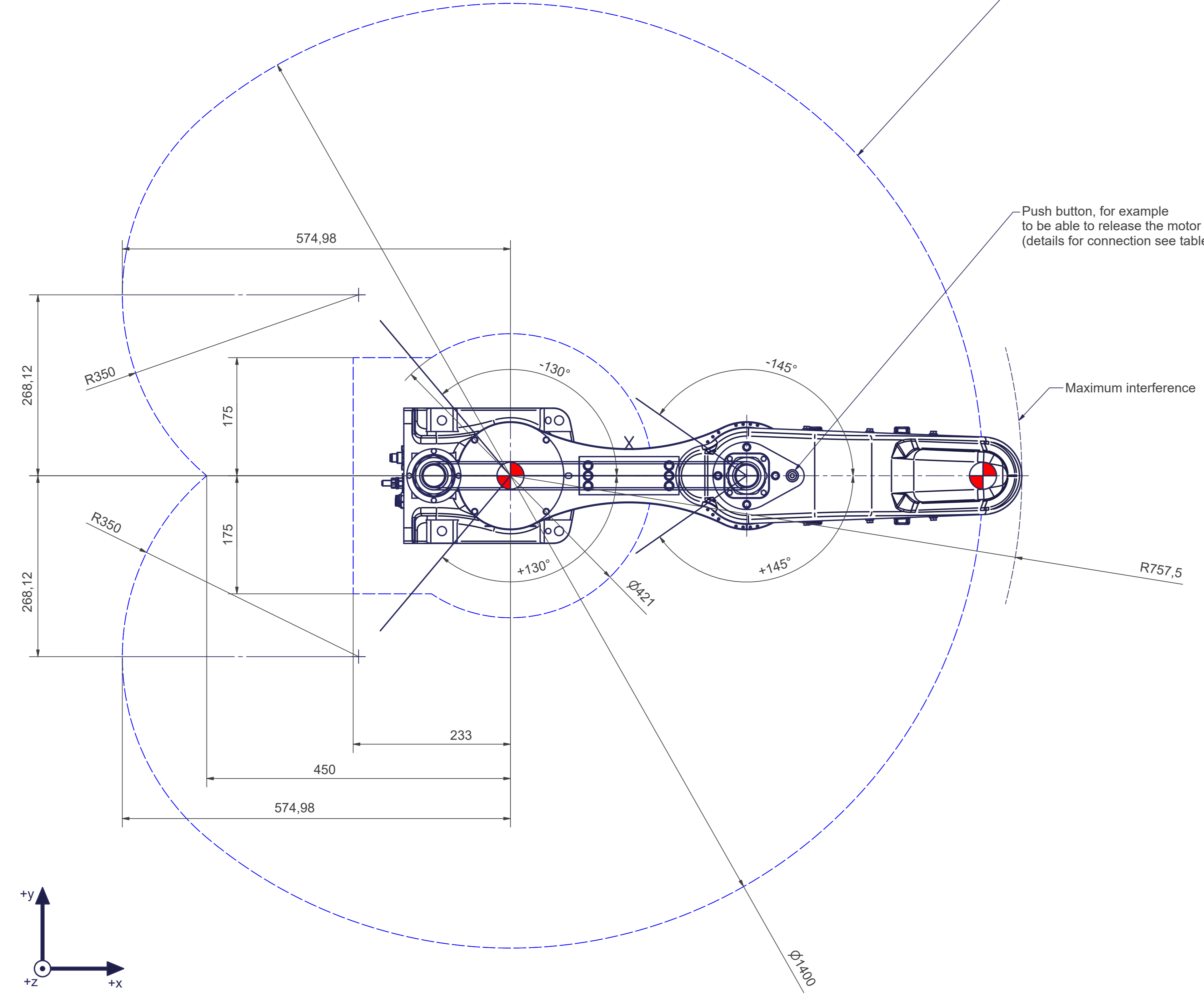

for screws M12 (DIN ISO 4014/4017-8.8) the tightening torque for these screws is 83 Nm (in steel frame).

sCara4-700-6kg		Motion	
Axes	4	Axes	Range fully usable
Payload (on TCP)	6kg	A1	± 130°
Reach	700 mm	A2	± 145°
Mounting position	Floor, ceiling, wall	A3	+ 73 mm / + 223 mm
		A4	± 360°

More information can be found in the document "calibration dimensions"

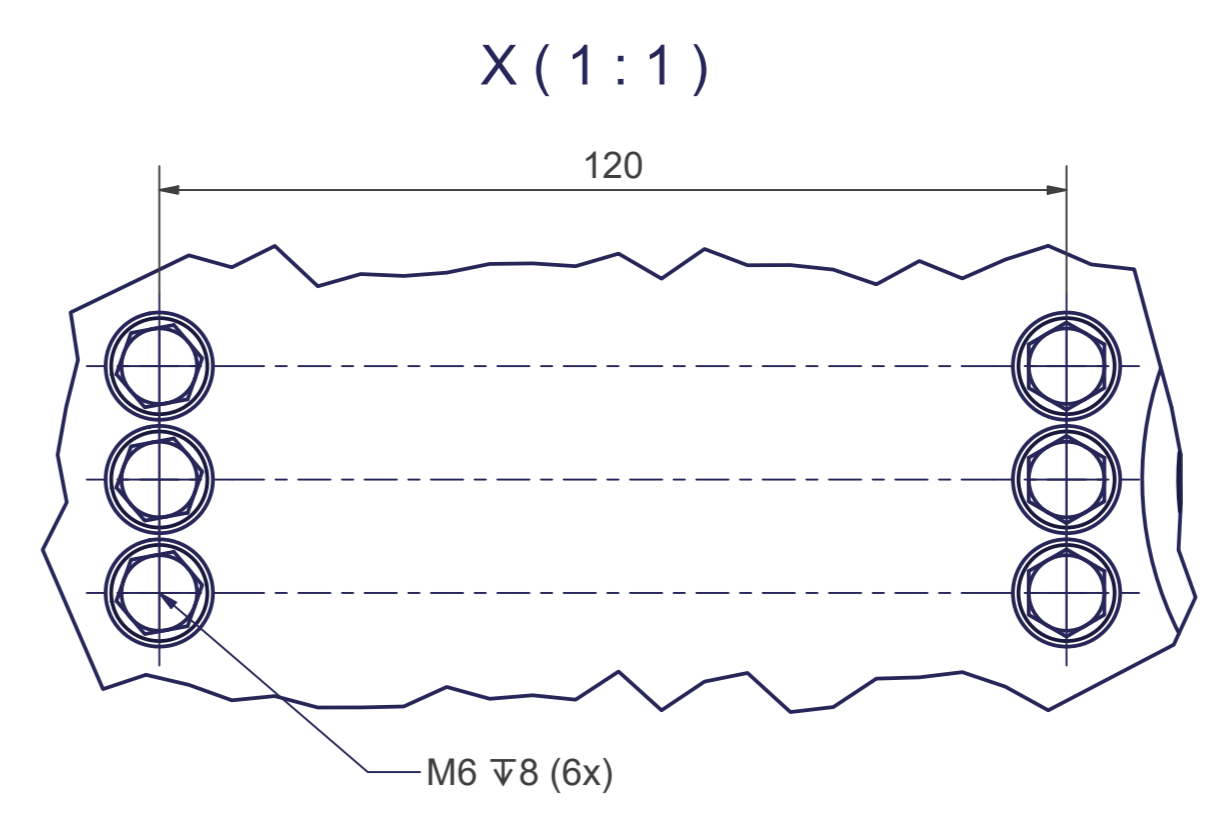

Connecting dimensions, valid for article number: AT_00020-HND

kg	A	bar	
m ⁻	kg	l/min	
proj. storage surface =	m ²	kw	
	P _z	V / Hz / Ph	
	U _n	Imax ^e	