

A minimum distance of 100mm between the cable harness and any (machine)parts is recommended to avoid any collision

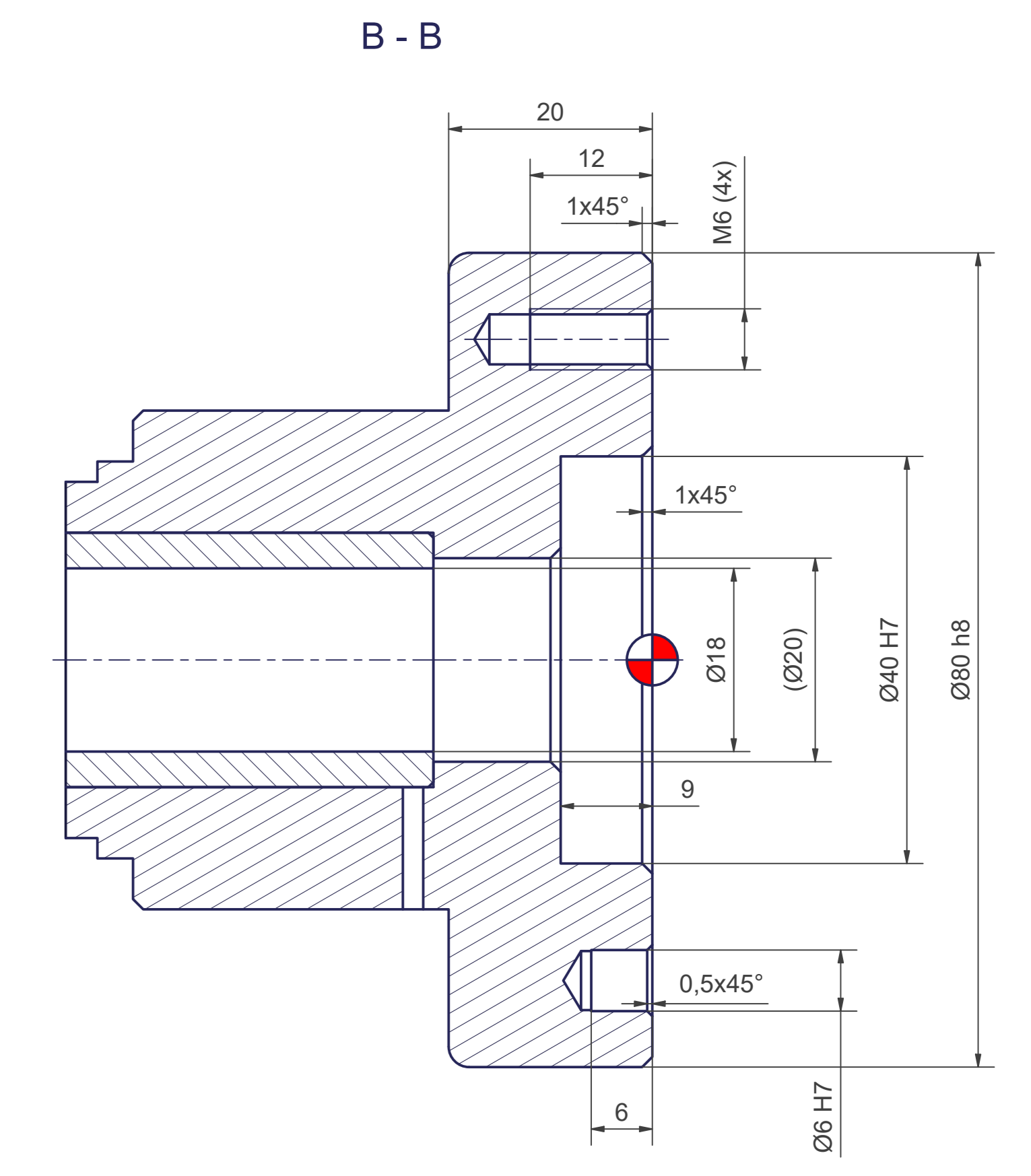

PIN assignment by autonox Robotics

PIN number	Connection to	M12 8-pin male
1	Push button	
2	Push button	
3 to 8	Not connected	

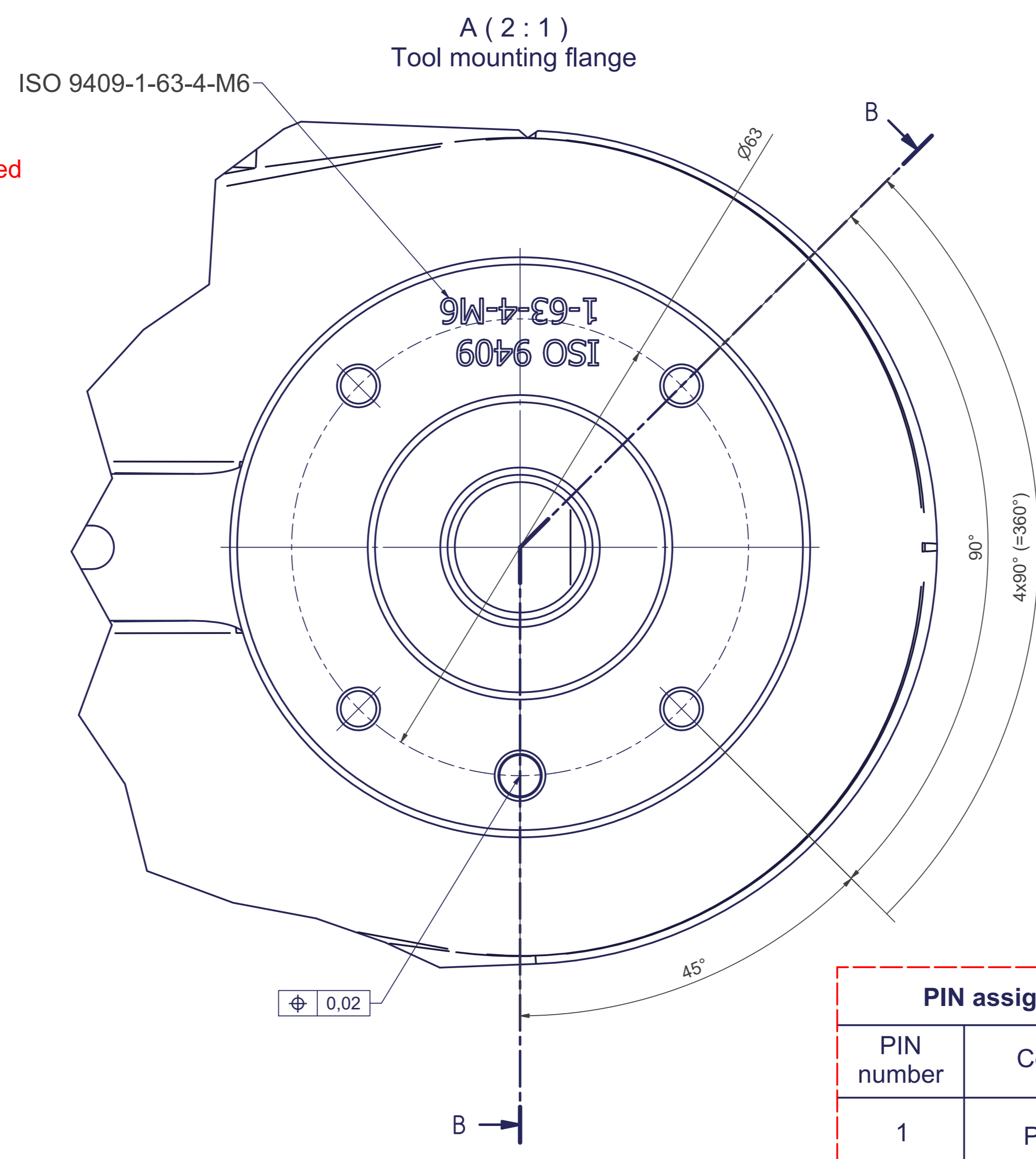
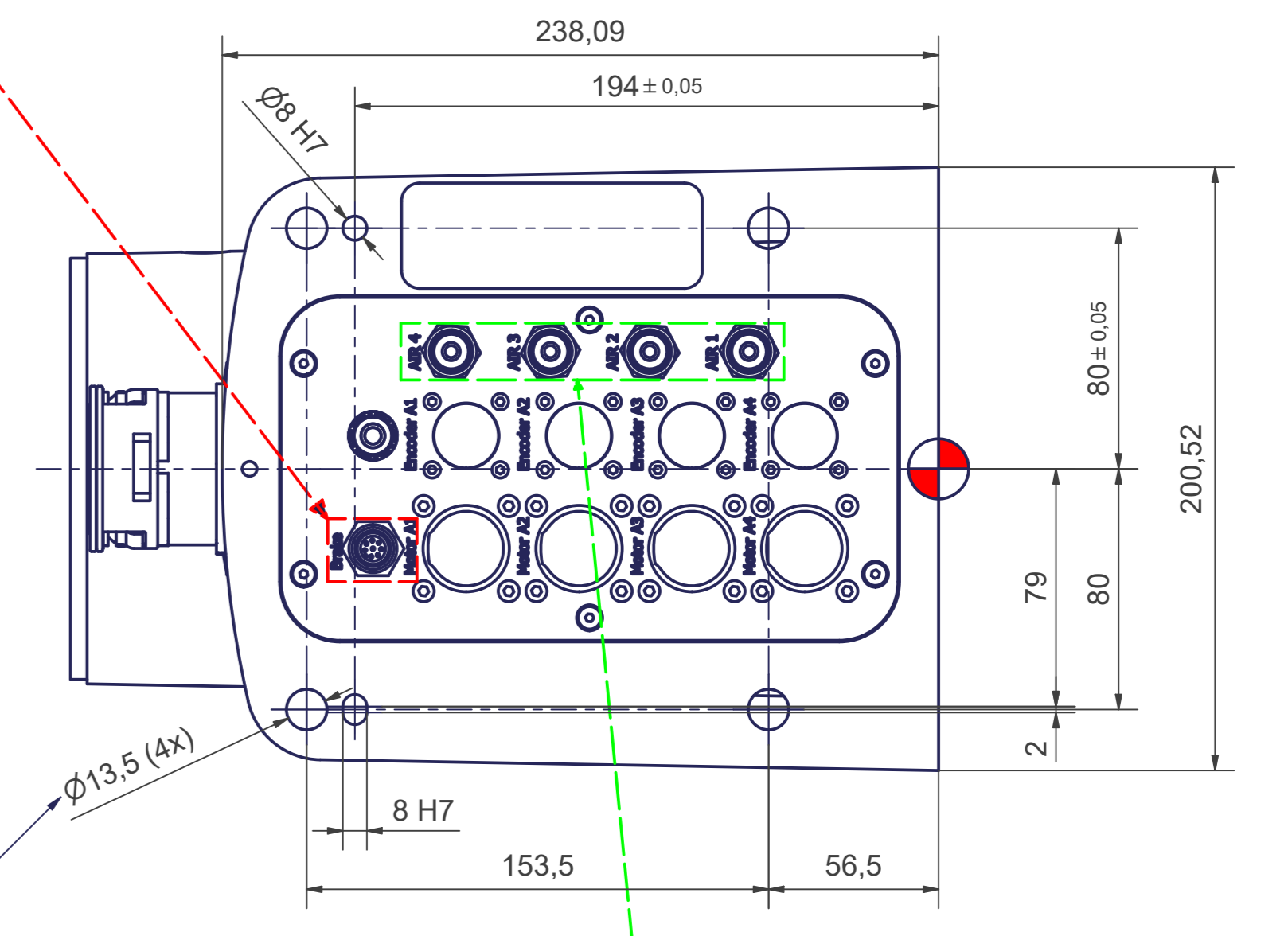
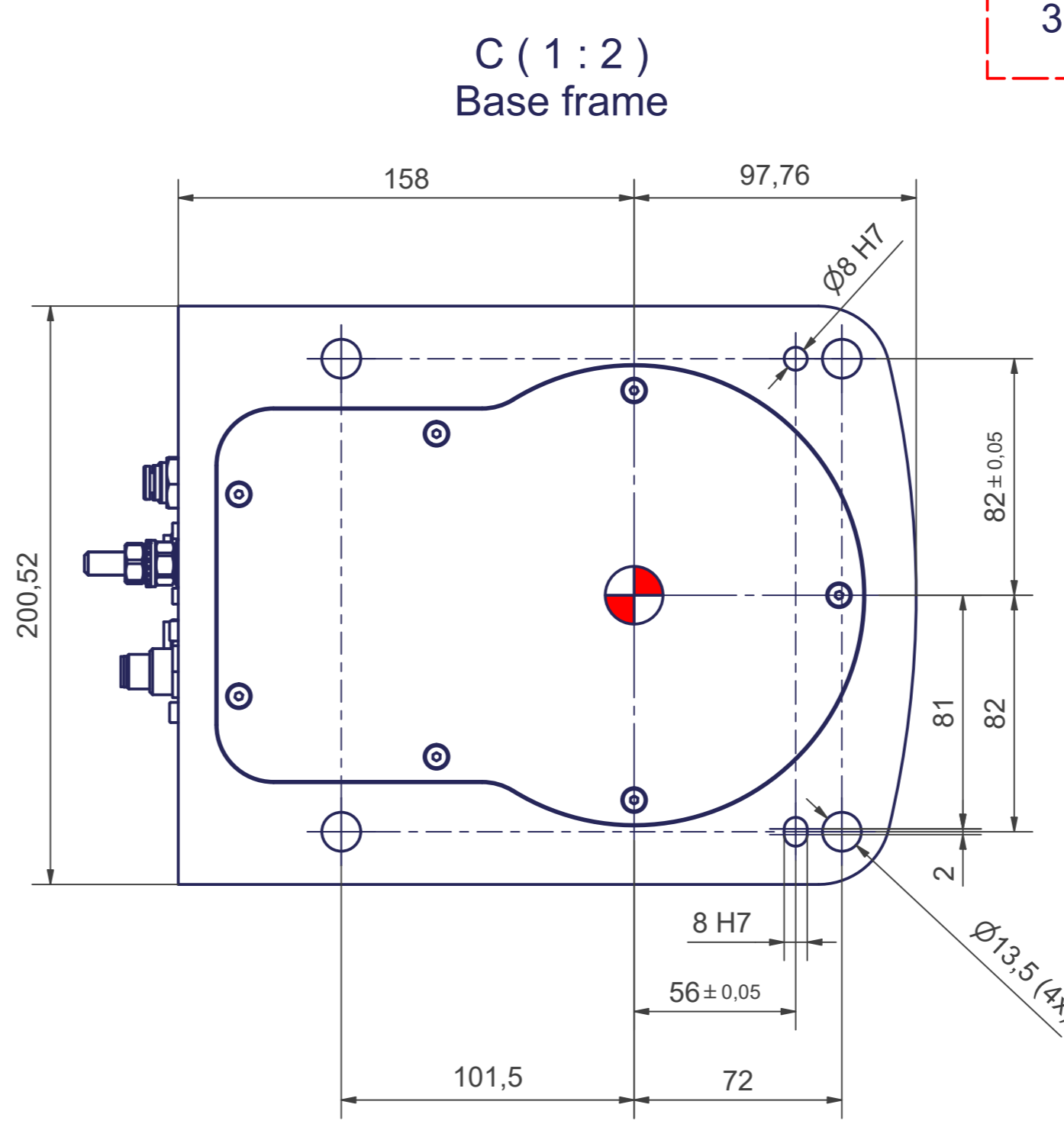
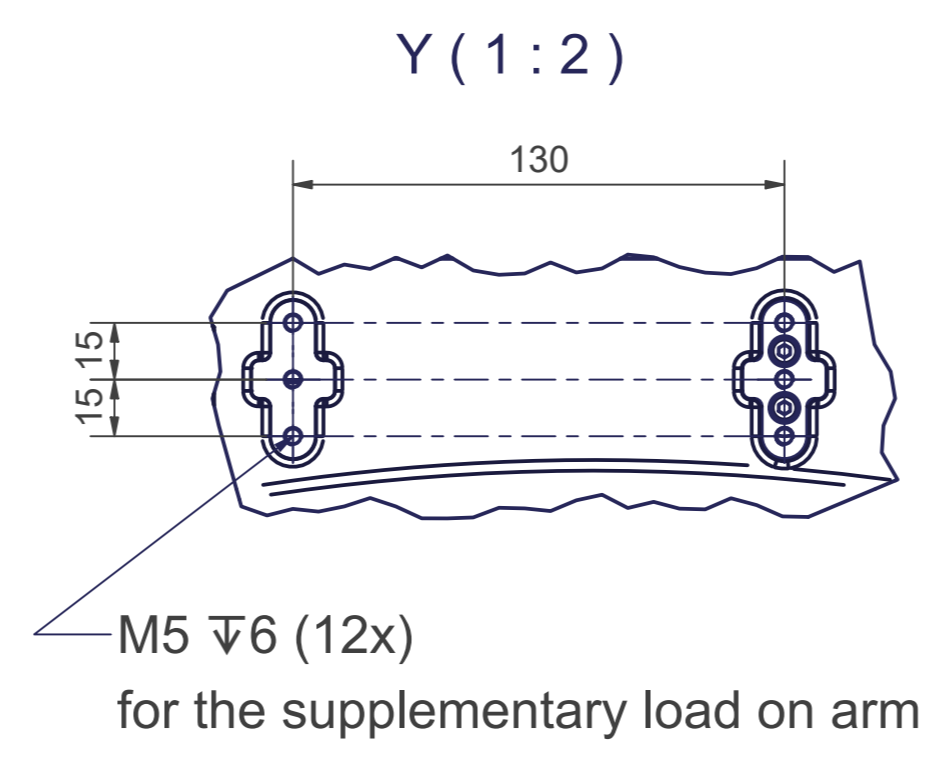

for screws M12 (DIN ISO 4014/4017-8.8) the tightening torque for these screws is 83 Nm (in steel frame).

Incl. fourfold integrated media supply to the end effector (compressed air 8 bar / vacuum -1 bar / D = 6mm d = 4mm)

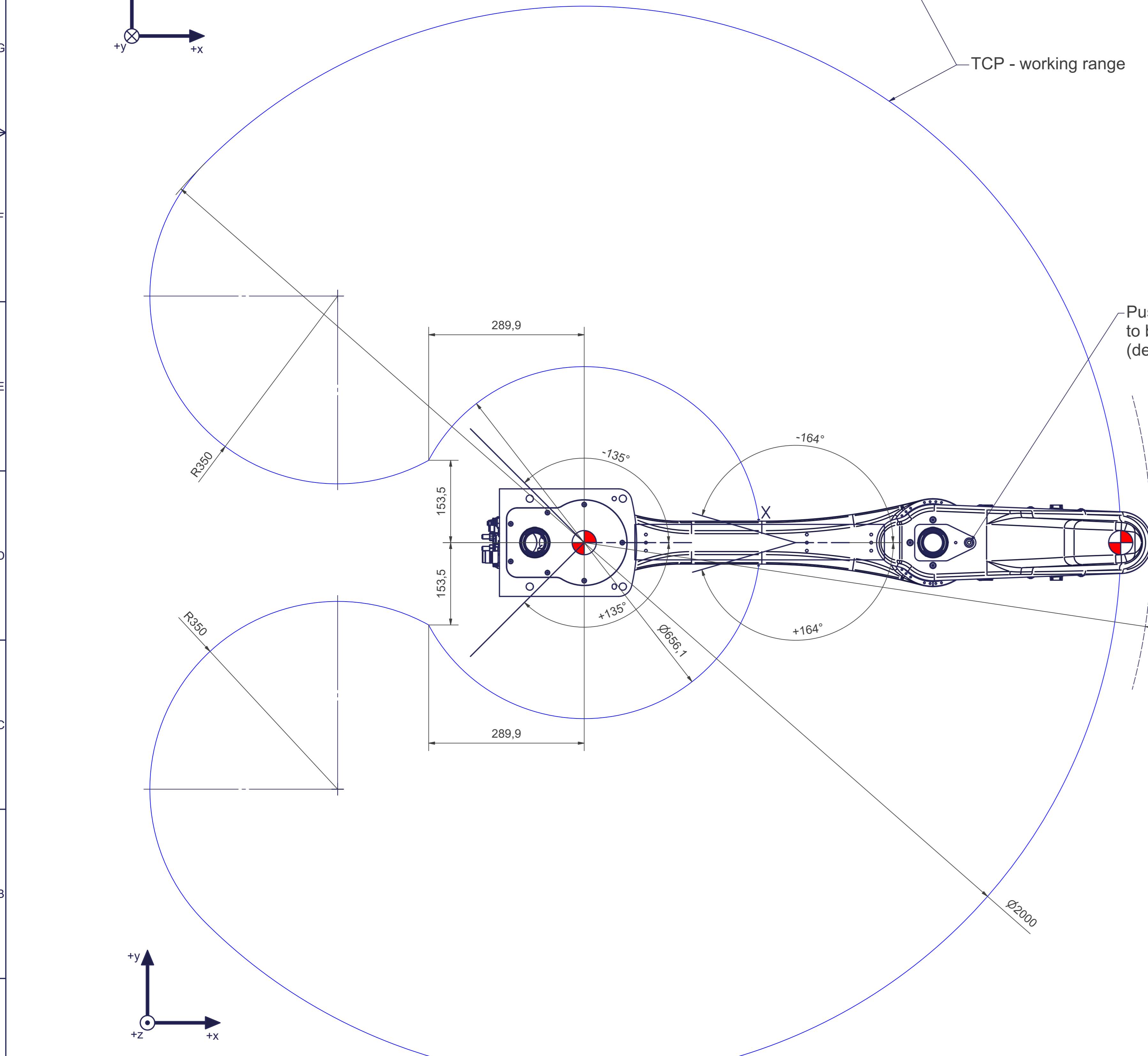

Push button, for example to be able to release the motor brakes (details for connection see table "PIN assignment")

Maximum interference

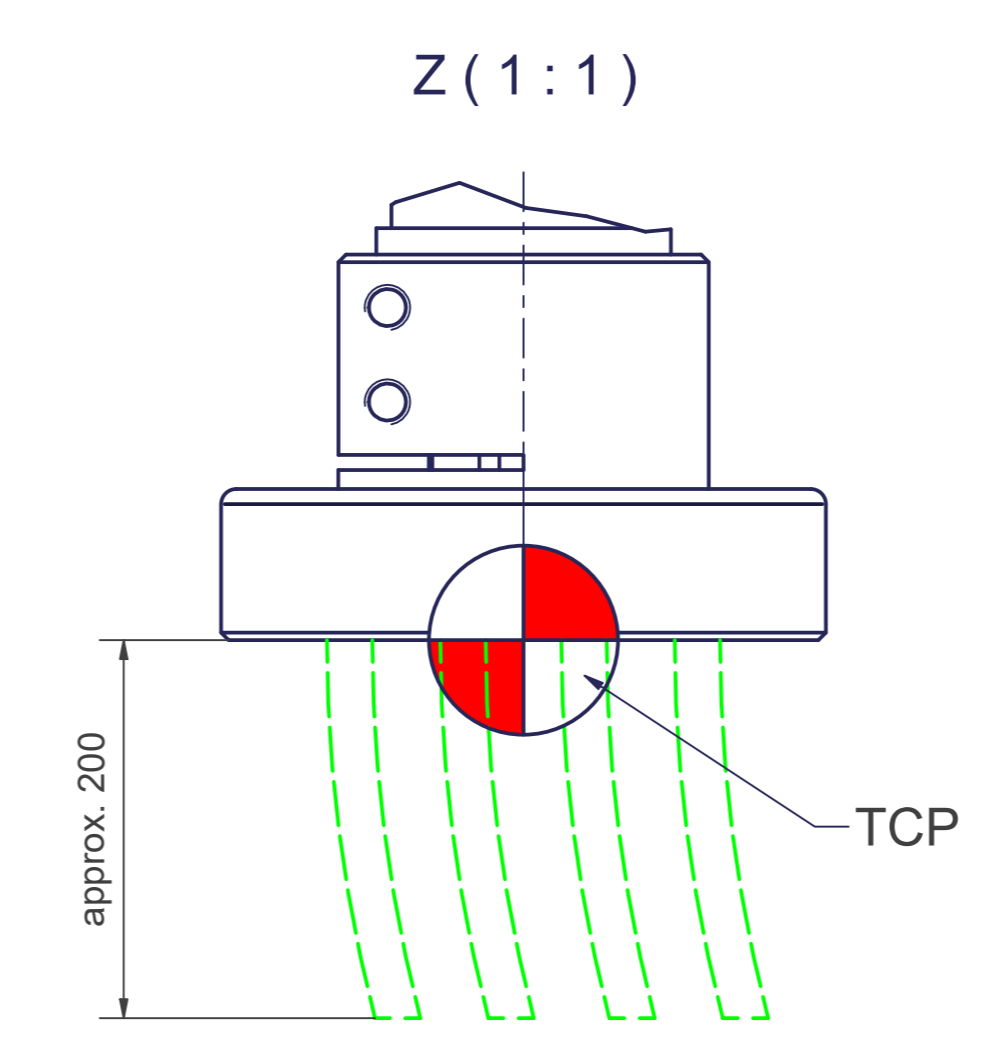

Incl. fourfold integrated media supply to the end effector (compressed air 8 bar / vacuum -1 bar / D = 6mm d = 4mm)

sCara4-1000-6kg		Motion	
Axes	4	Axes	Range fully usable
Payload (on TCP)	6 kg	A1	± 135°
Reach	1000 mm	A2	± 164°
Mounting position	Floor, ceiling, wall	A3	- 127 mm / + 273 mm
		A4	± 360°

More information can be found in the document "calibration dimensions"

Connecting dimensions, valid for article number: AT_00027-01

kg	kg	A	bar
m ⁻	kg	A	l/min
proj. storage surface =	m ²	P _z	mm
		U _n	V / Hz / Ph
		l _{max}	A

