

Optional Bellows (1 : 2)

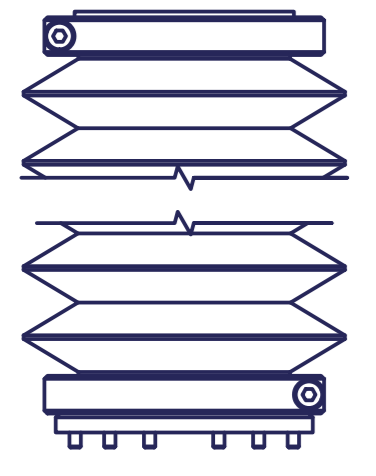

TCP - working range when using optional Bellows (MT_BGR00105809)

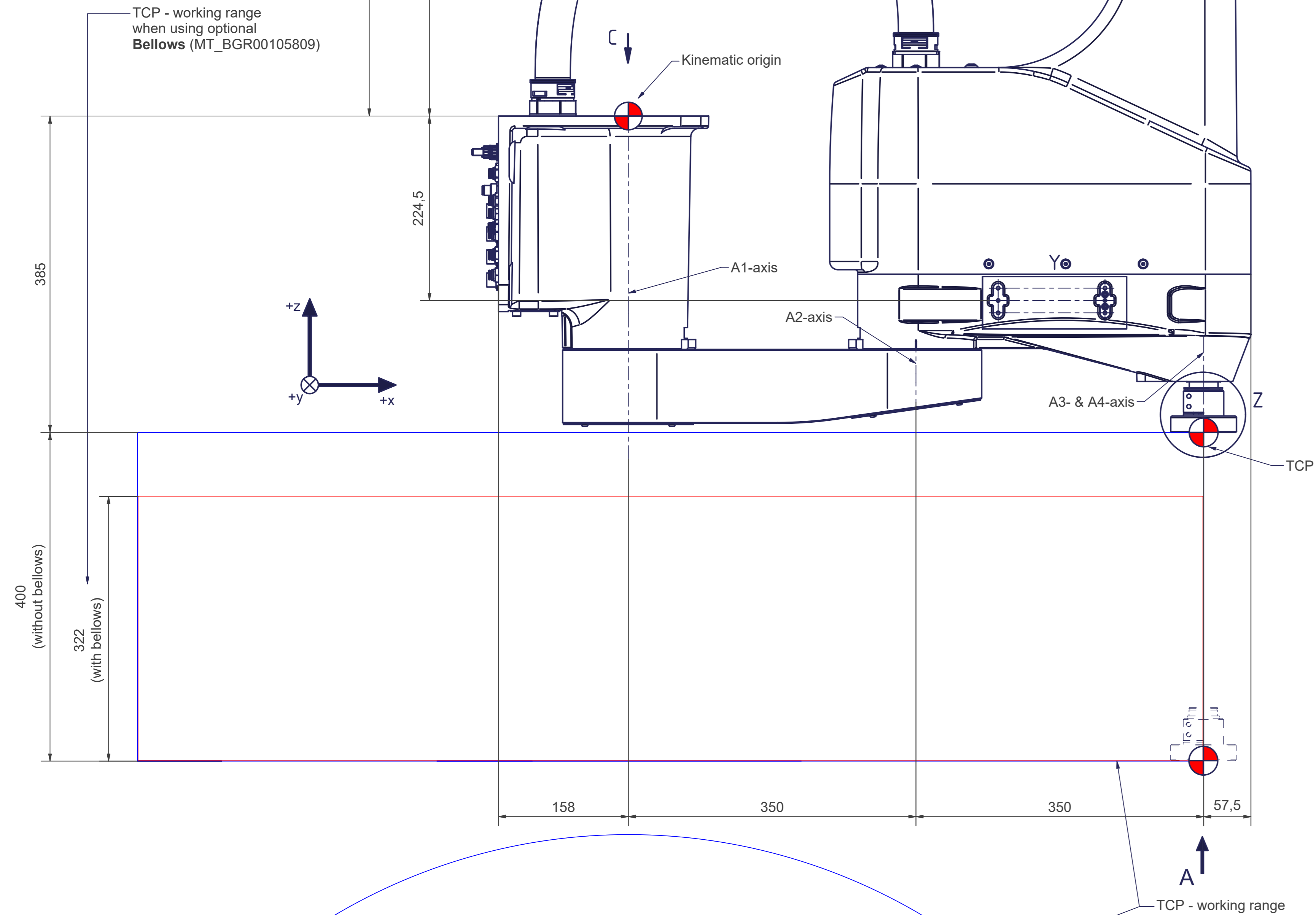

A minimum distance of 100mm between the cable harness and any (machine)parts is recommended to avoid any collision

A (2 : 1) Tool mounting flange

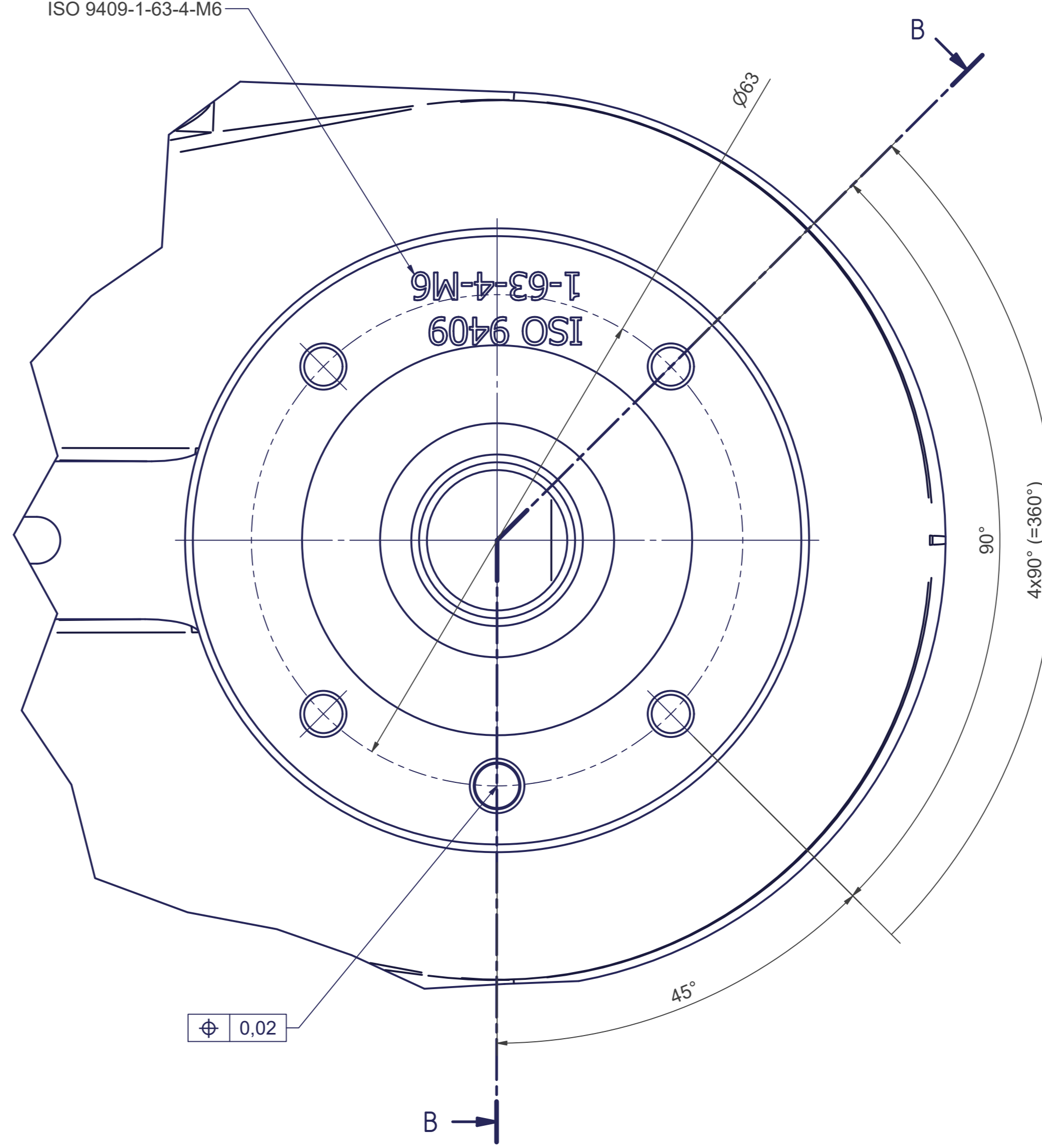

B-B

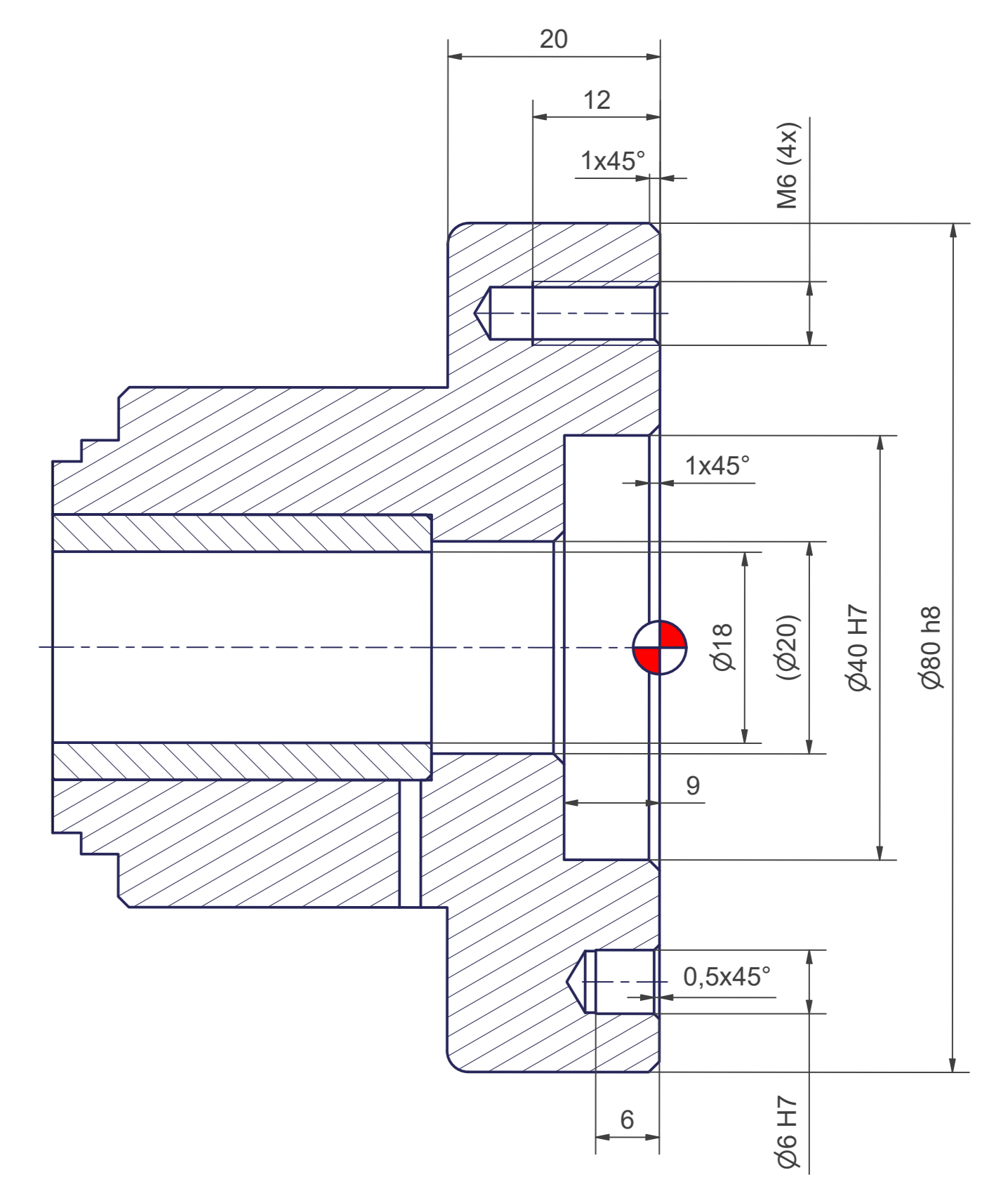

PIN assignment by autonox Robotics		
PIN number	Connection to	M12 8-pin male
1	Push button	
2	Push button	
3 to 8	Not connected	

Y (1 : 2)

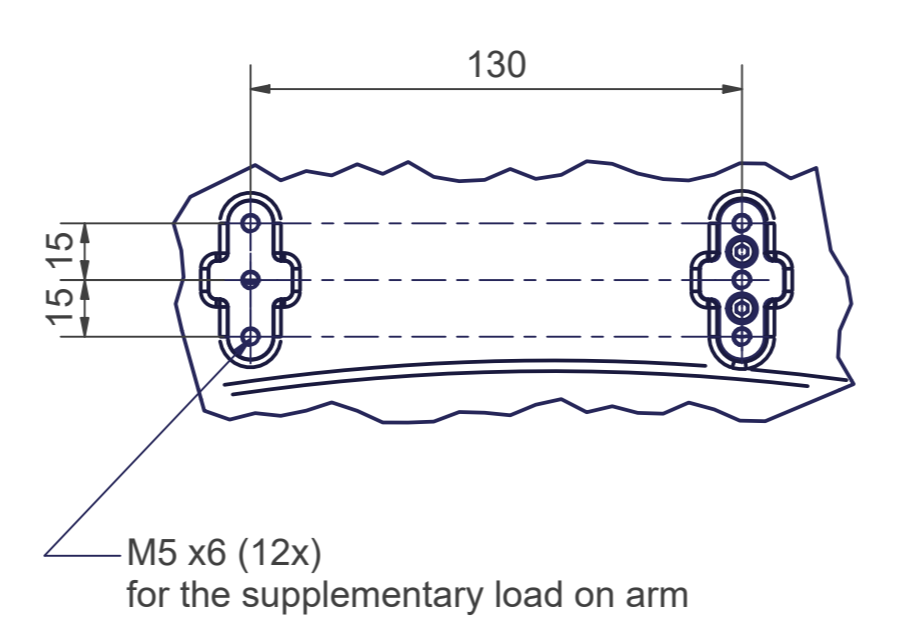

C (1 : 2) Base frame

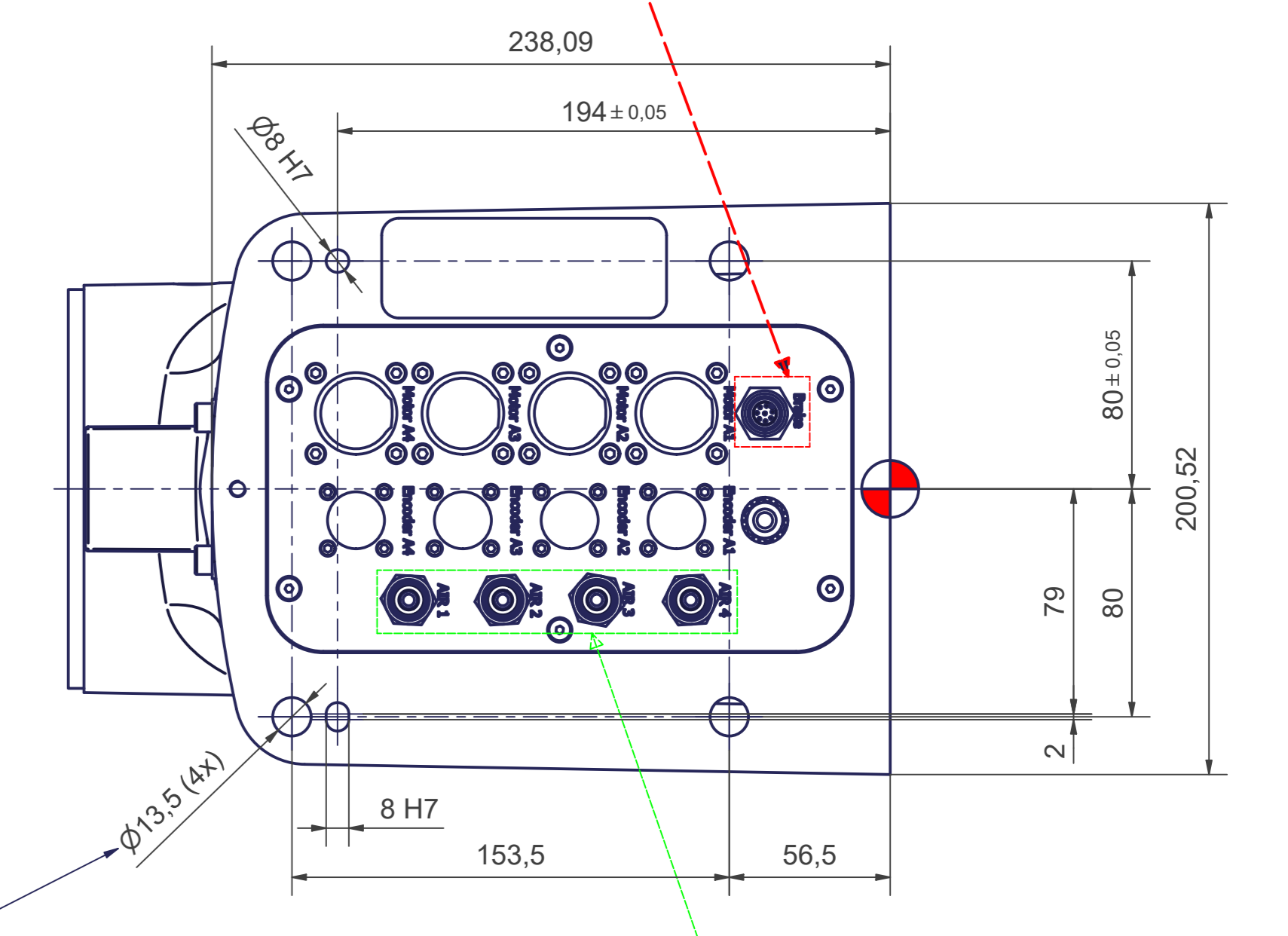
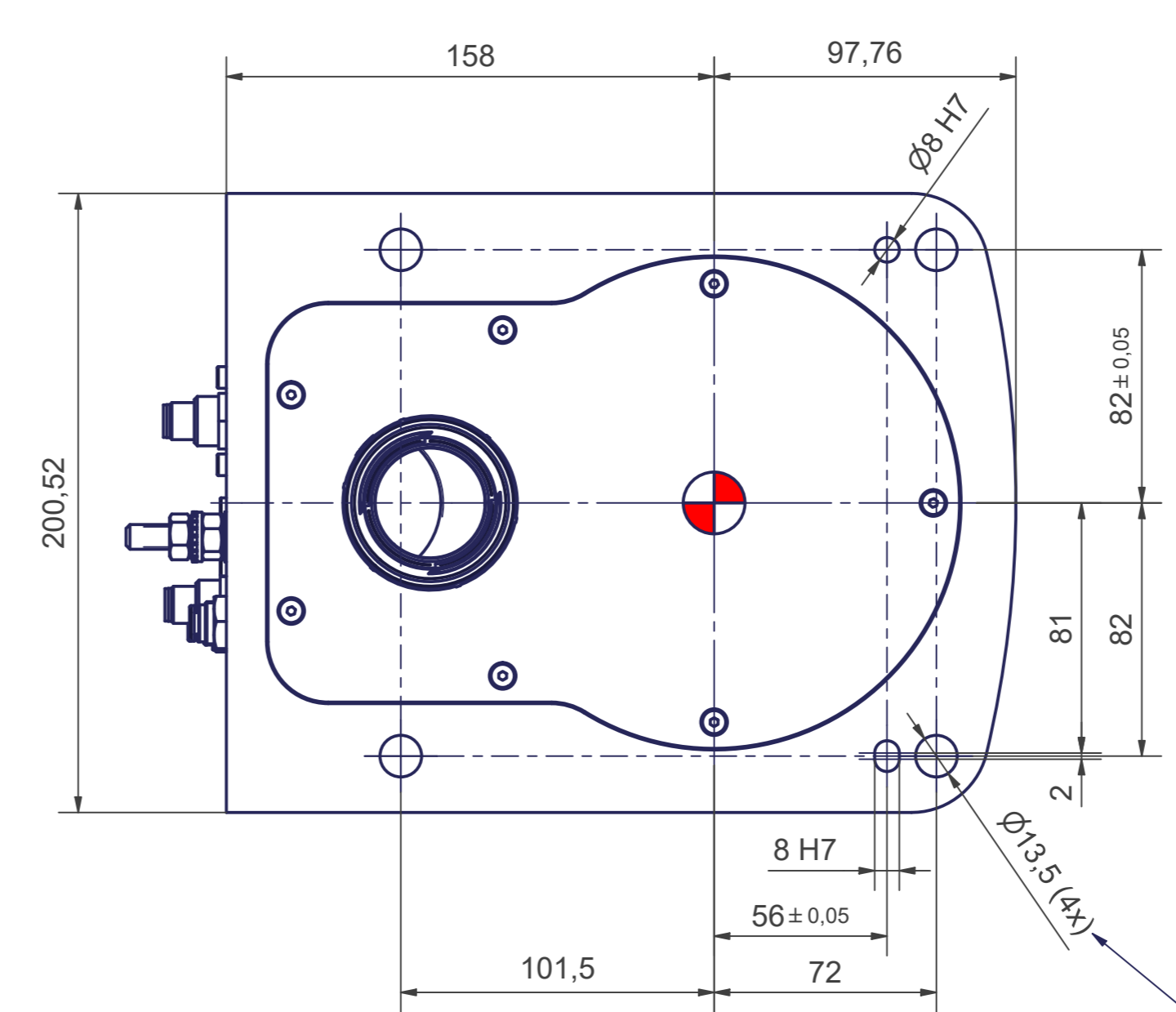

for screws M12 (DIN ISO 4014/4017-8.8) the tightening torque for these screws is 83 Nm (in steel frame).

Incl. fourfold integrated media supply to the end effector (compressed air 8 bar / vacuum -1 bar / D = 6mm d = 4mm)

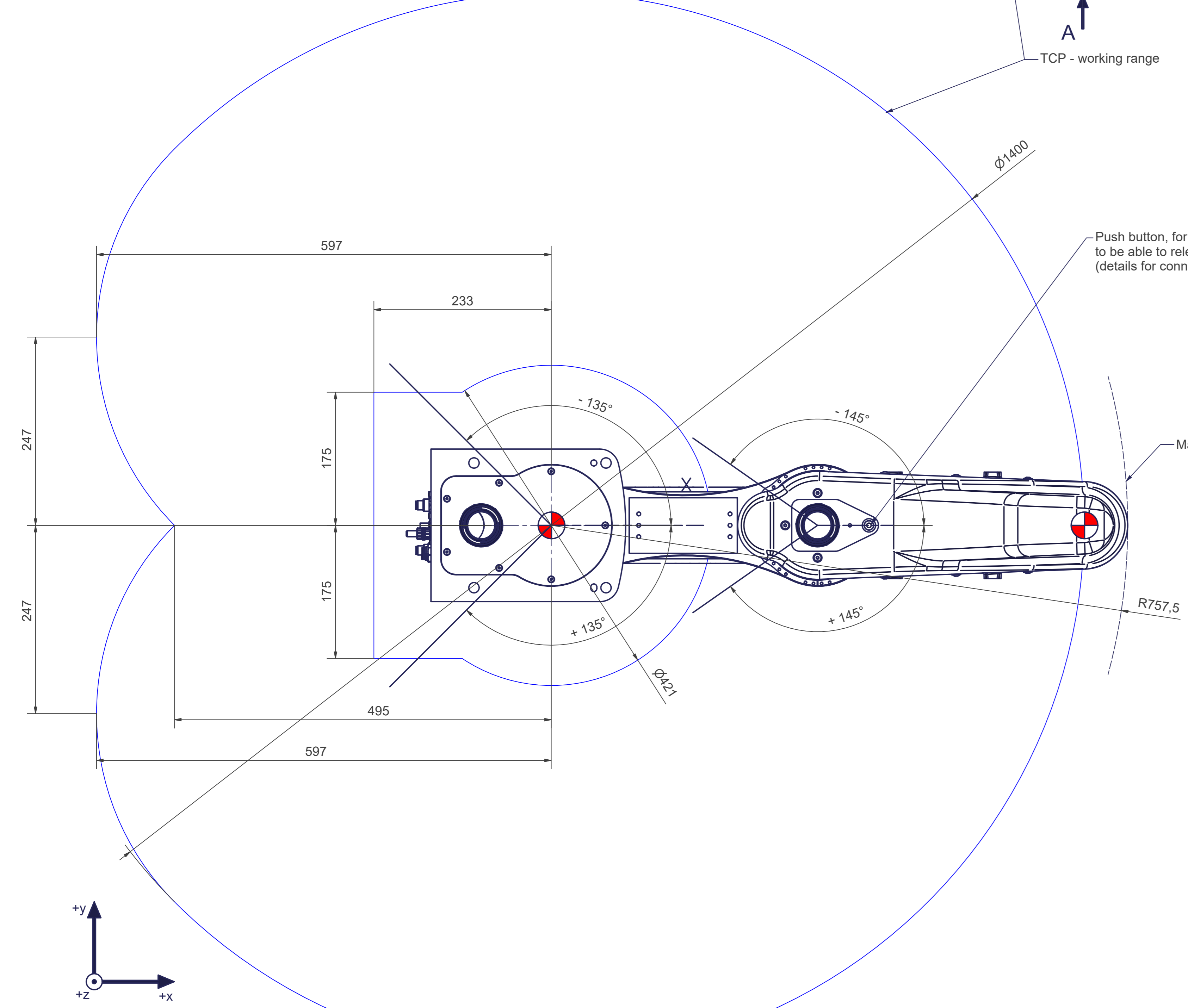

Z (1 : 1)

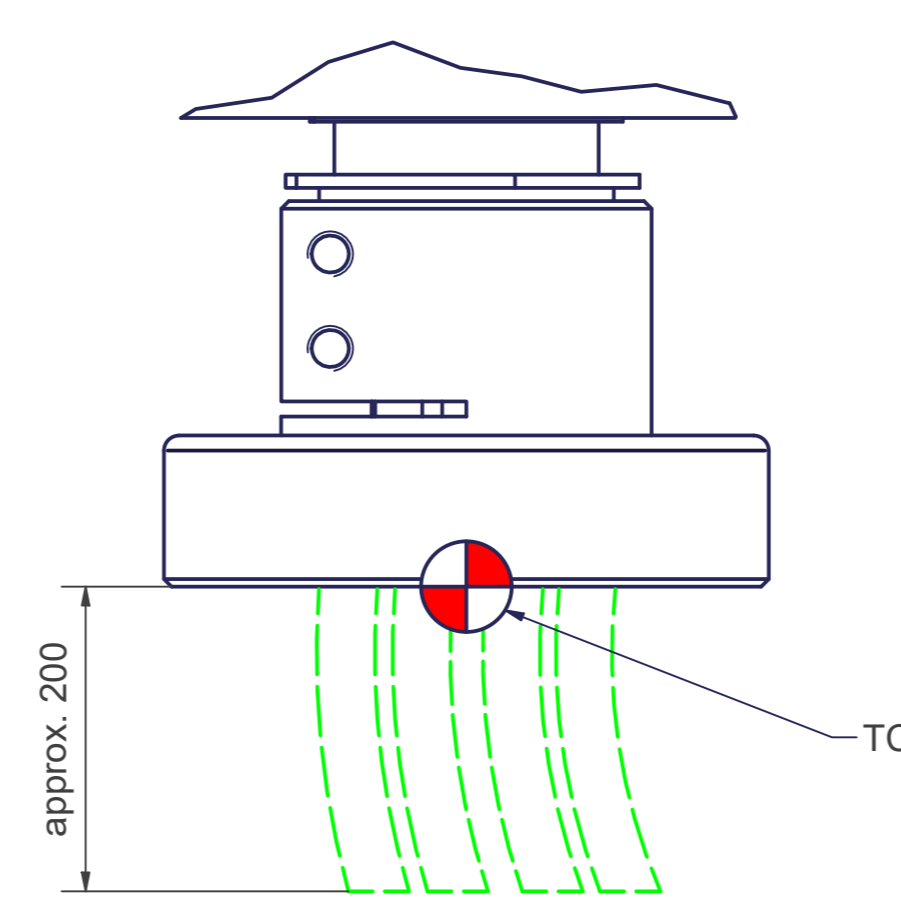

Incl. fourfold integrated media supply to the end effector (compressed air 6 bar / vacuum -1 bar / D = 6mm d = 4mm)

X (1 : 2)

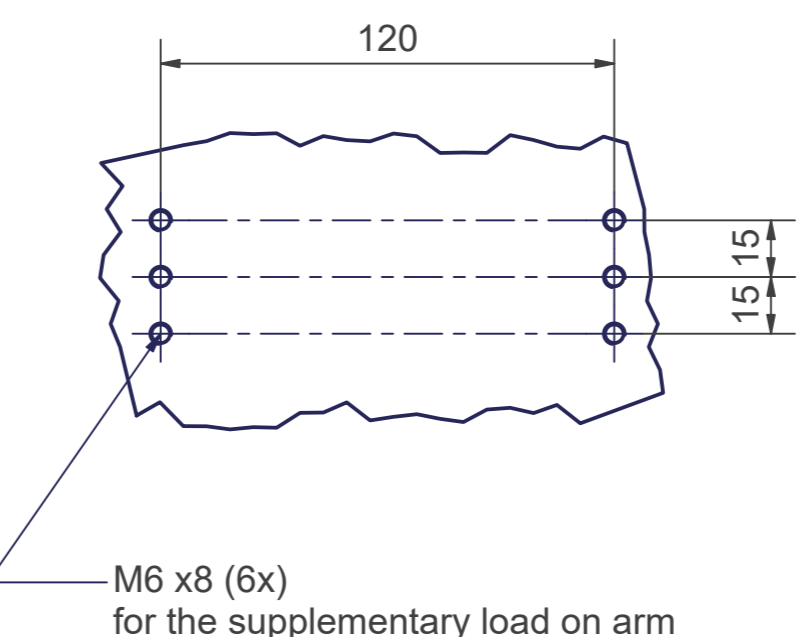

sCara4-700-6kg		Motion	
Axes	4	Axes	Range fully usable
Payload (on TCP)	6 kg	A1	± 135°
Reach	700 mm	A2	± 145°
Mounting position	Floor, ceiling, wall	A3	- 385 mm / - 785 mm
		A4	± 360°

More information can be found in the document "calibration dimensions"

Connecting dimensions, valid for article number: AT_00020-01-400

kg	kg	A	bar
m ²	m ²	mm	l/min
proj. storage surface =		kw	
		V / Hz / Ph	
		Imax	

OPTIONAL:
Bellows MT_BGR00105809