



Connecting dimensions, valid for article number A_00805-T1

m= kg	A	p= bar
proj. storage surface = m ²	P= kW	v= l/min
First angle projection	U= V / Hz / Ph	
	Imax= A	



1 2 3 4 5 6 7 8 9 10 11 12

-  All fastening holes $\varnothing 17,5$ mm for screws M16 (DIN ISO 4014/4017 -8.8) without washers. Fastening holes are coloured red.
-  Fastening holes filled blue are difficult to access. We recommend using fastening holes coloured red.
-  Drilling holes for locating pins are filled red. Recommend dimensions of locating pins: $\varnothing 12$ h6.

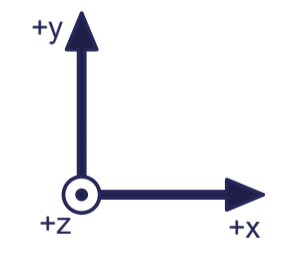
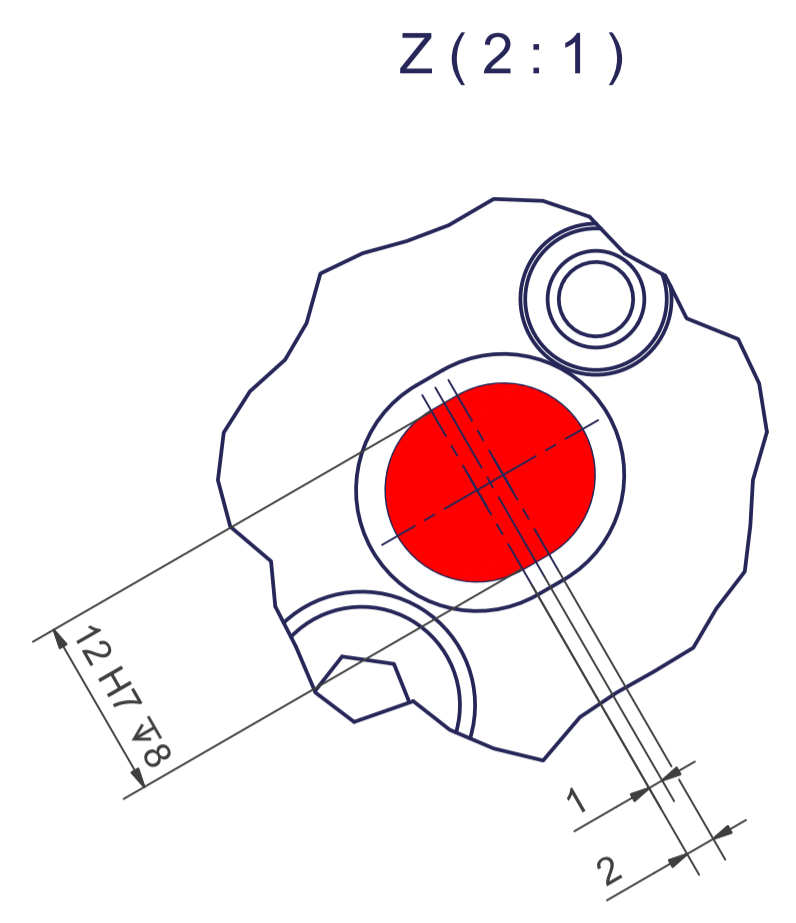
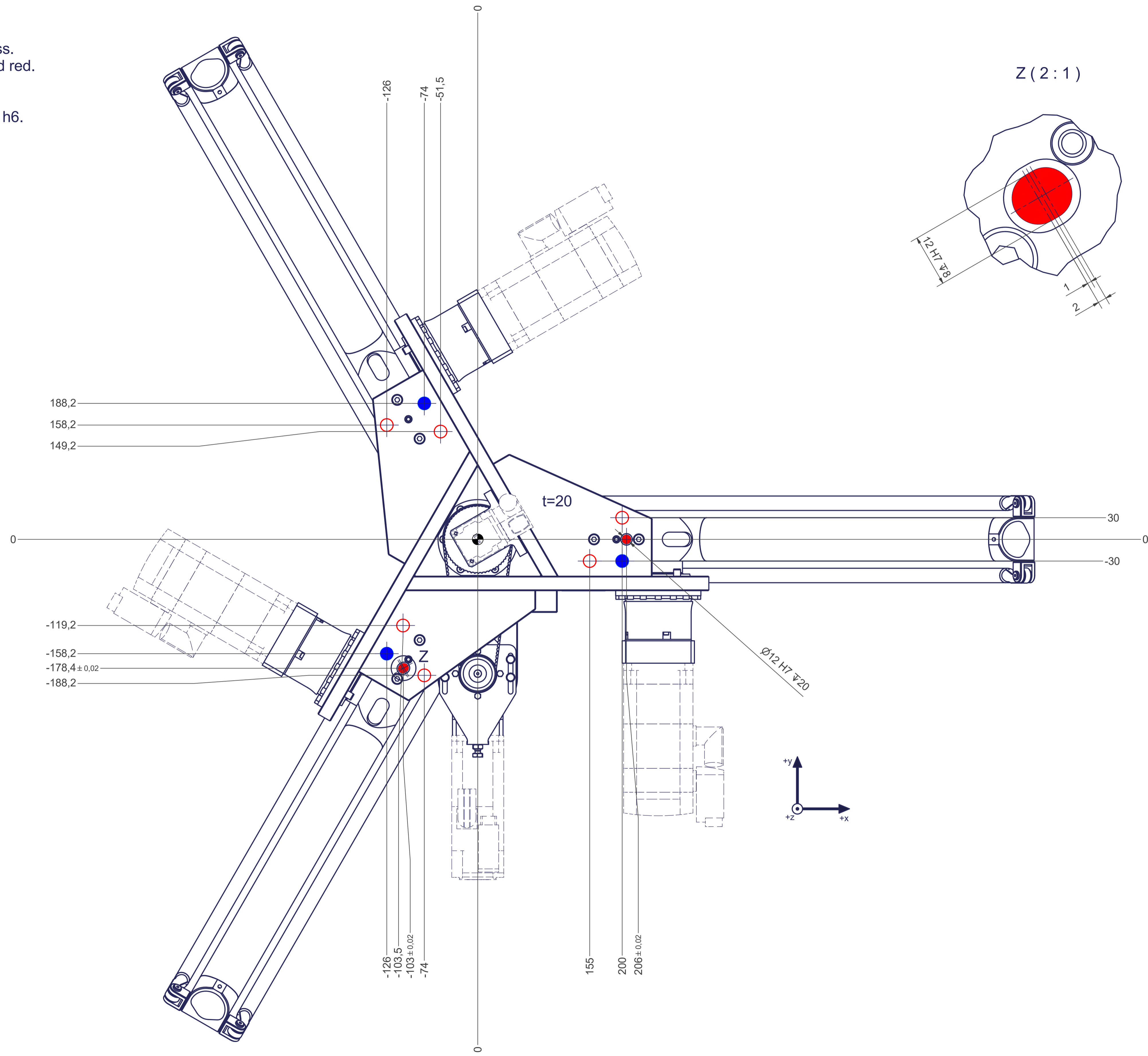

1 2 3 4 5 6 7 8 9 10 11 12