

Valid for article number: A_00902-T1

| | | |
|-----------------------|----------------------|----------|
| | | |
| m= kg | A | p= bar |
| proj. Stellfläche= m² | P= kW | v= l/min |
| | U= V / Hz / Ph | |
| | I _{max} = A | |

12 11 10 9 8 7 6 5 4 3 2 1

All fastening holes coloured red:
ø22 (7x), 30 mm deep for screws M20

Fastening screw threads coloured green:
M20 (8x) 30 mm deep

Drilling holes for locating pins are coloured orange:
Recommended dimensions of locating pins: ø12 h6

Z (2:1)

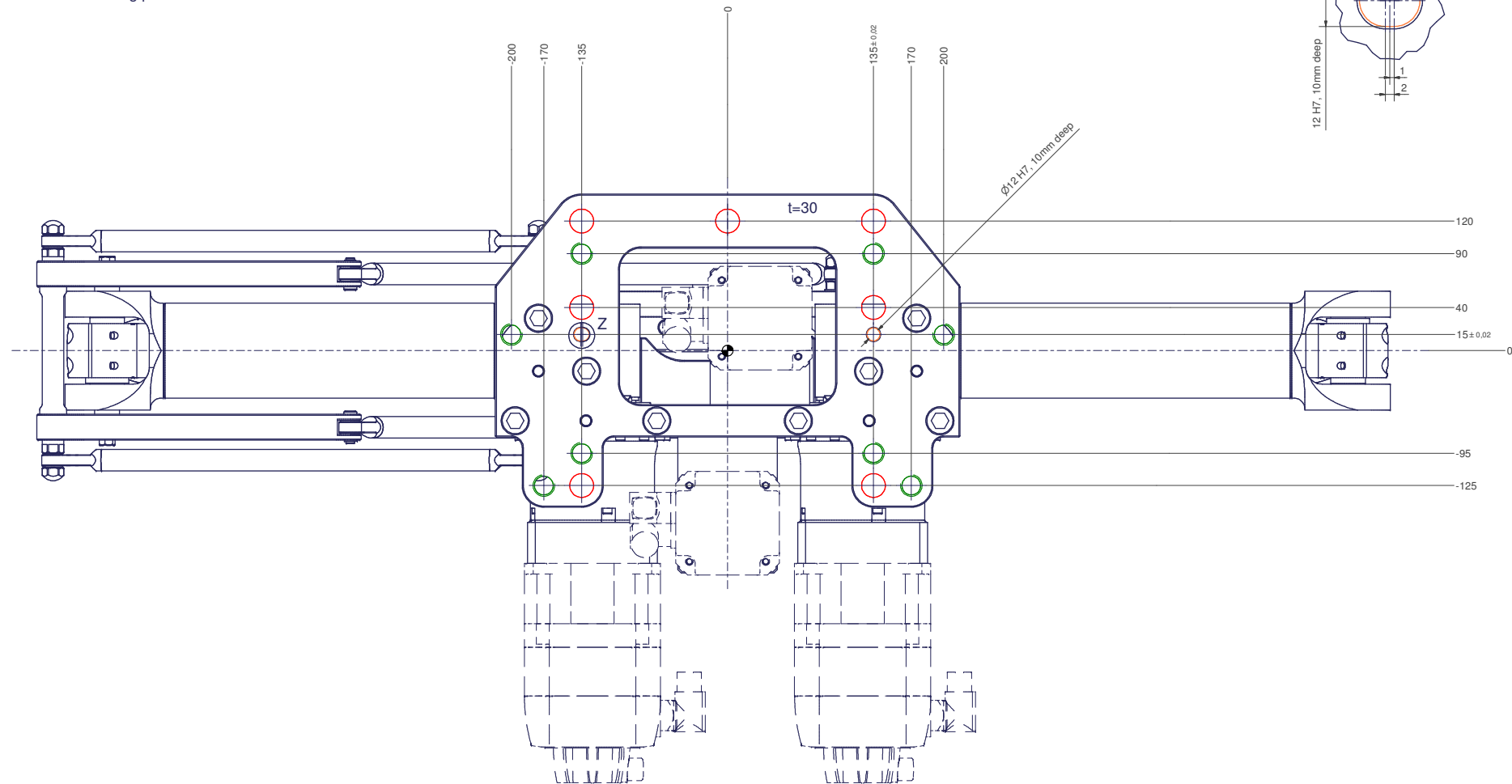
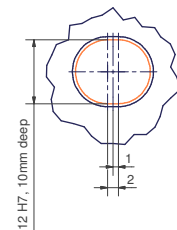

12 11 10 9 8 7 6 5 4 3 2 1