

Tool Center Point
TCP (on the plane of the flange)

TCP - working range

Kinematic origin
(within the plane
of the upper arm axes)

Maximum interference contour
from machine body

Maximum interference contour

A (2:1)

B-B

Z (1:2)

Connecting dimensions,
valid for article number A_00876

m= kg	A	p= bar
proj. storage surface = m²		v̇= l/min
First angle projection	P= kW	
	U= V / Hz / Ph	
	Imax= A	

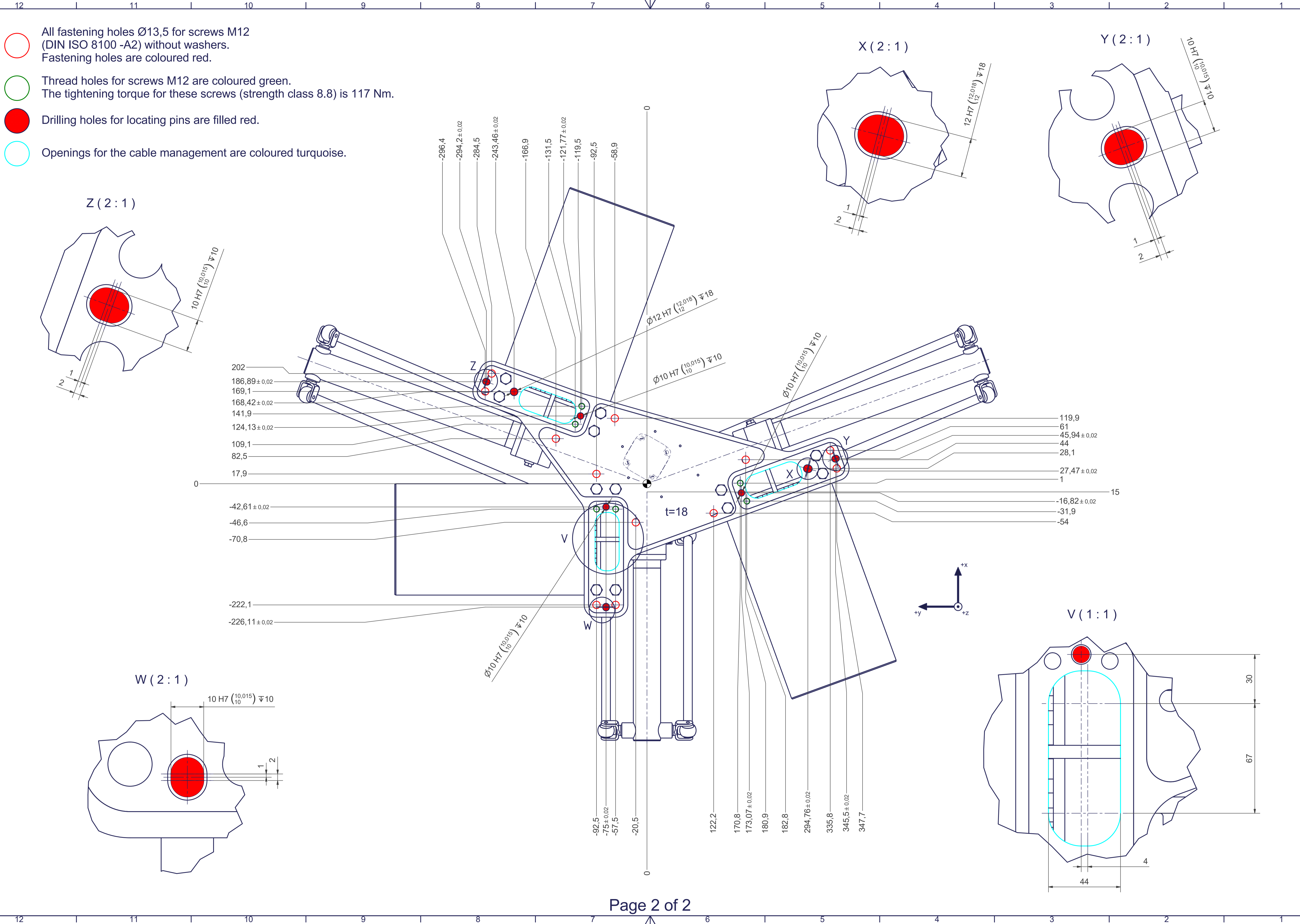

○ All fastening holes Ø13,5 for screws M12 (DIN ISO 8100 -A2) without washers. Fastening holes are coloured red.

○ Thread holes for screws M12 are coloured green. The tightening torque for these screws (strength class 8.8) is 117 Nm.

● Drilling holes for locating pins are filled red.

○ Openings for the cable management are coloured turquoise.

Z (2:1)

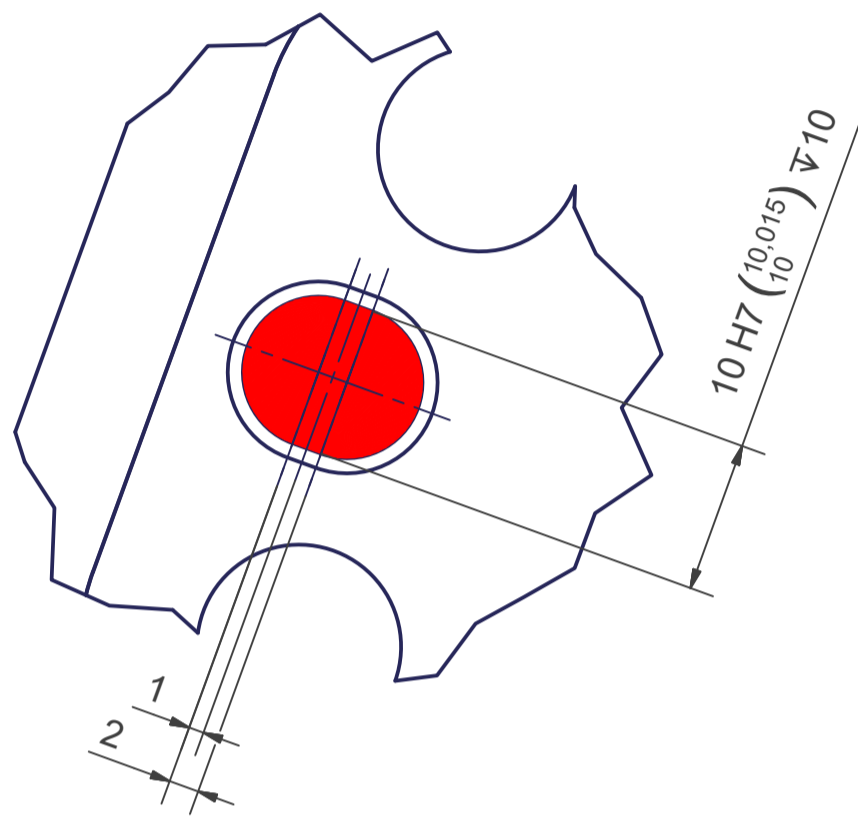

X (2:1)

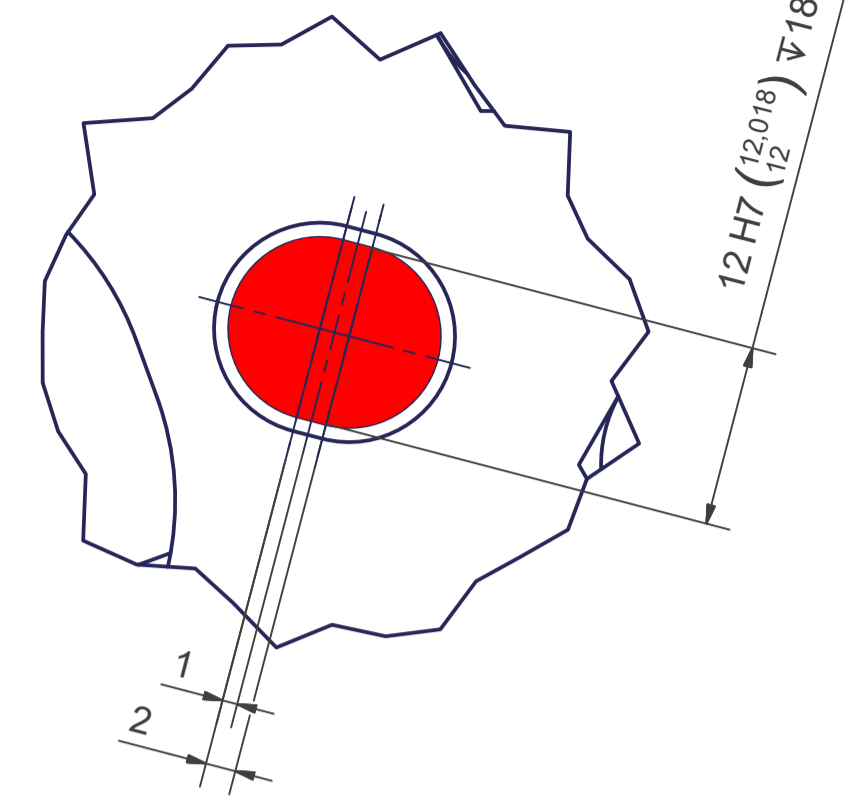

Y (2:1)

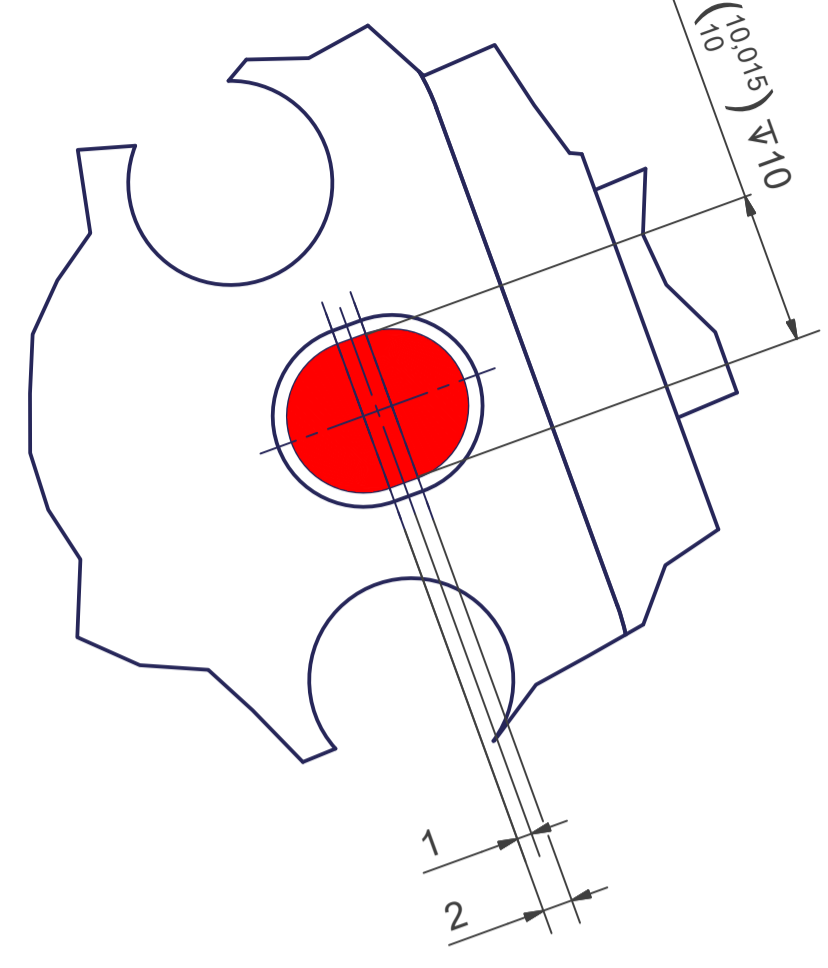

W (2:1)

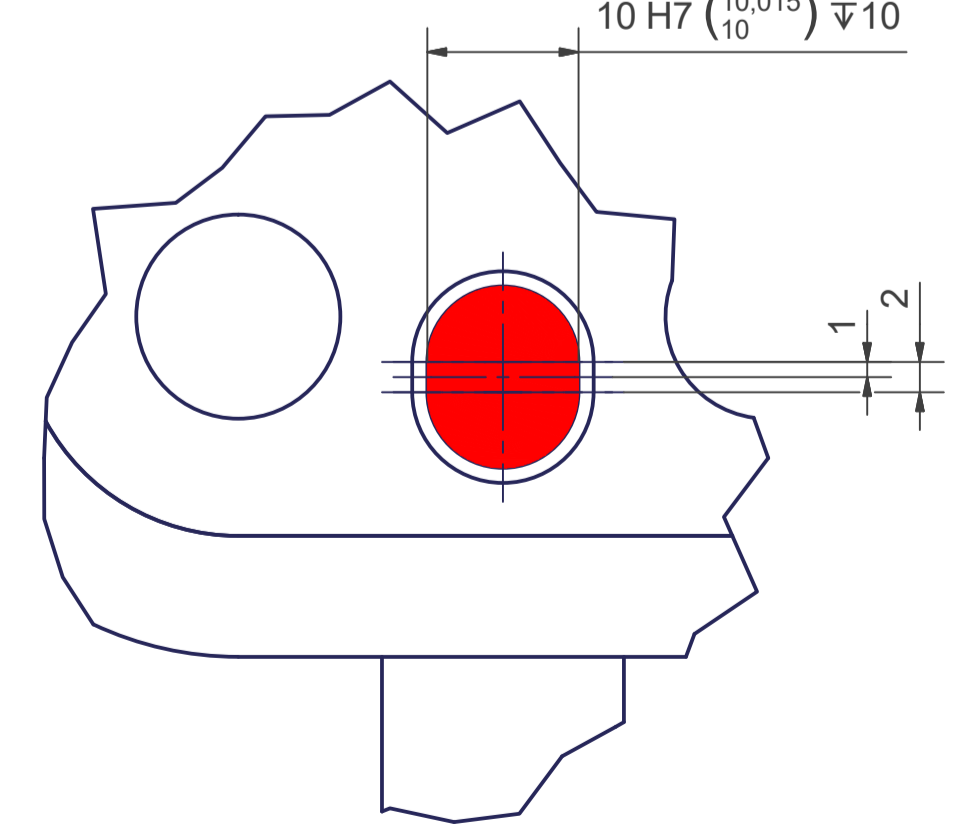

V (1:1)

