

12

11

10

9

8

7

6

5

4

3

2

1

H

G

F

E

D

C

B

A

Maximum deflection of the upper arm

Depending on the drive type

Depending on the drive type

approx. 134

750

approx. 370

300

Ld

approx. 80

approx. 38

750

R1039.40

TCP - working range

Tool Center Point  
TCP (on the plane of the flange)

950

II

II

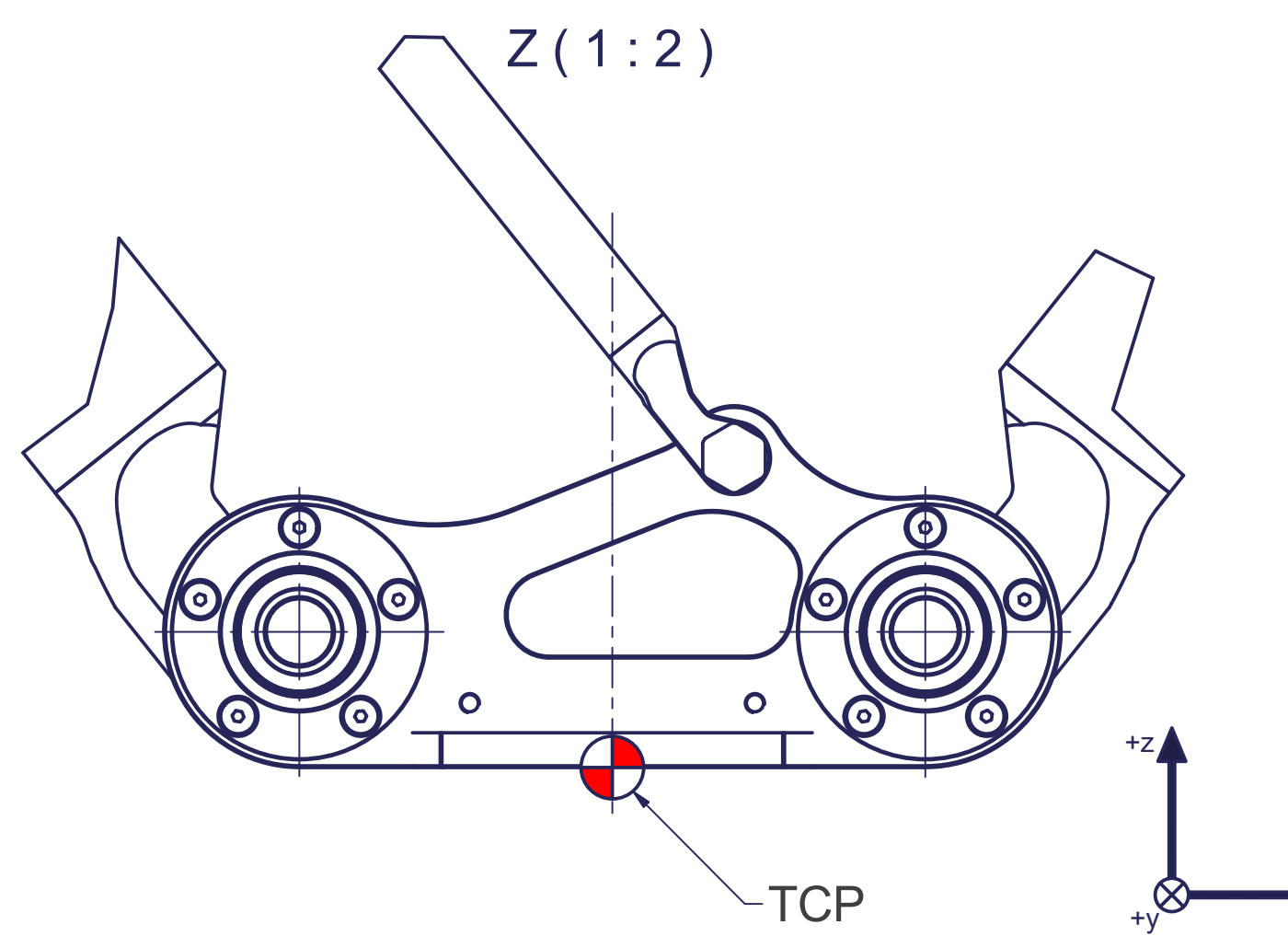
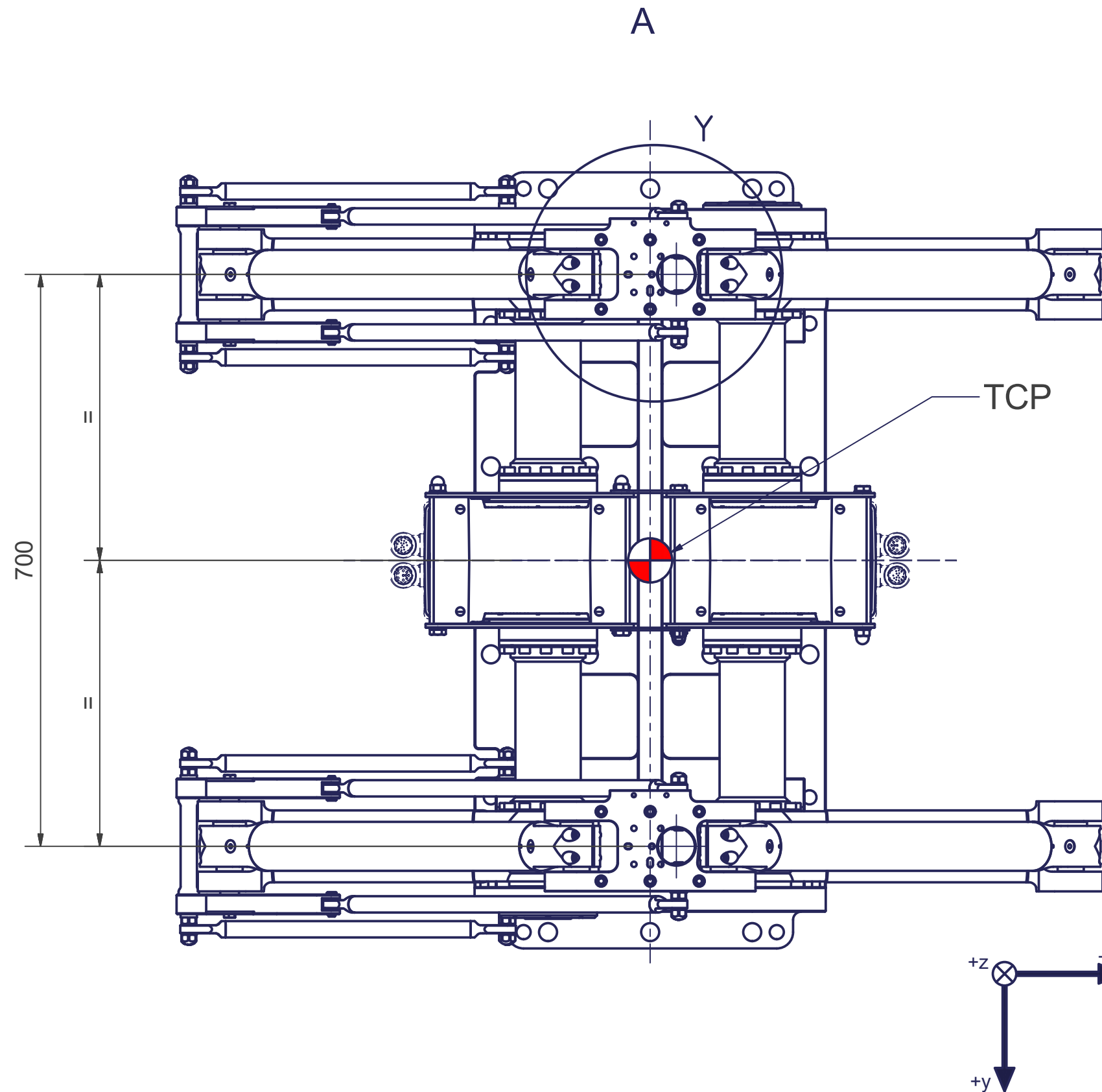
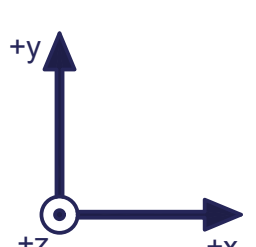
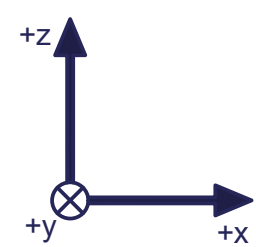

Y (1:2)

Both tool holders are identical

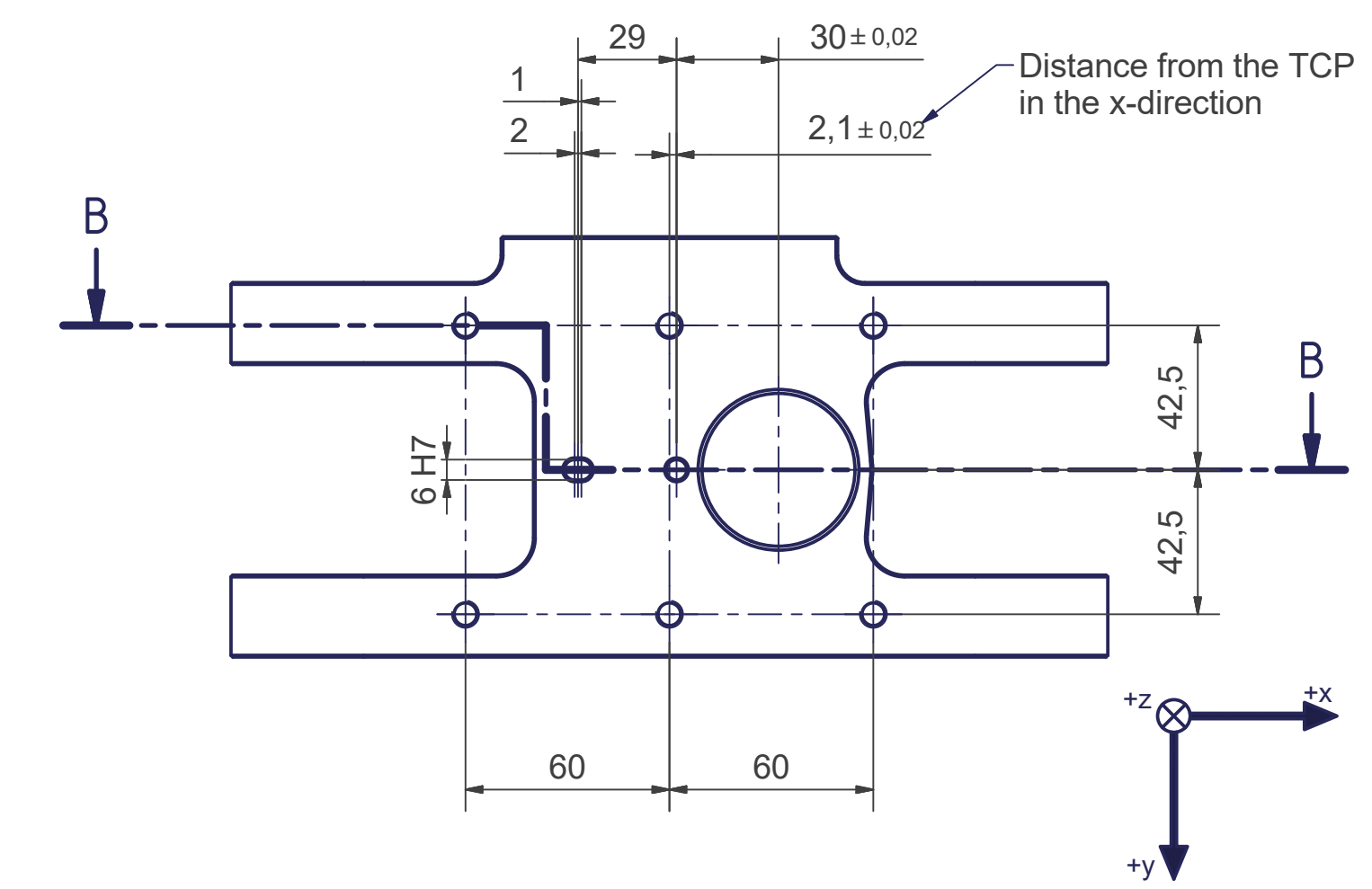



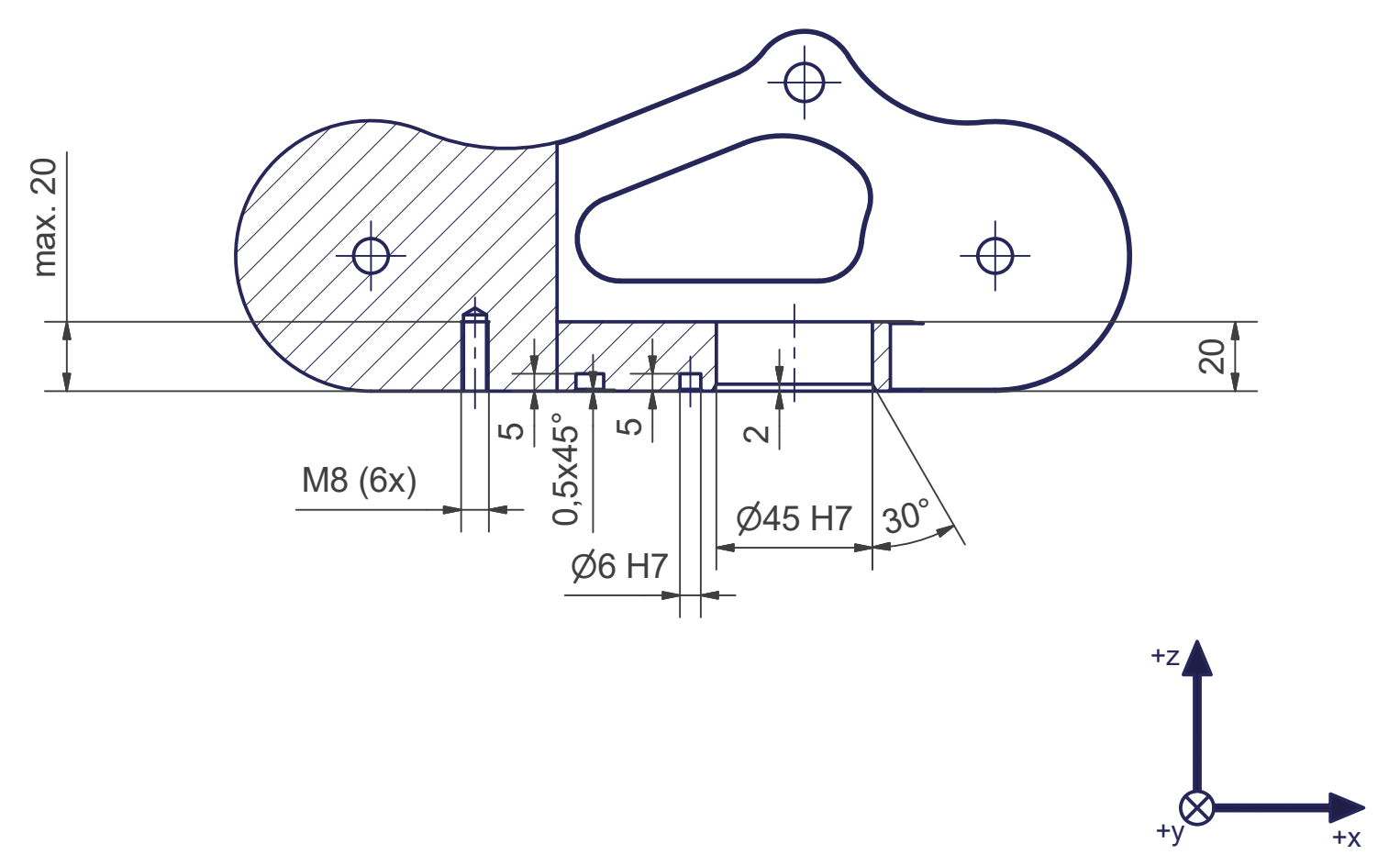

B-B



Connecting dimensions, valid for article number A\_00858

m= kg	A	p= bar
proj. storage surface = m²		v̇= l/min
First angle projection		kW
	U=	V / Hz / Ph
	lmax=	A

12 11 10 9 8 7 6 5 4 3 2 1

-  All fastening holes  $\varnothing 22$  for screws M20 (DIN ISO 4014/4017 -8.8) without washer. Fastening holes are coloured red.
-  Drilling holes for locating pins are filled red. Recommended dimensions of locating pins:  $\varnothing 12$  h6
-  Thread holes for screws M20 are coloured green. The tightening torque for these screws (strenght class 8.8) is 170 Nm.
-  All the screws M16x40 (DIN ISO 4762 -A2) and pins  $\varnothing 10$ m6x28 (DIN ISO 8735) are marked blue must be accessible in case of service.

Z (2:1)

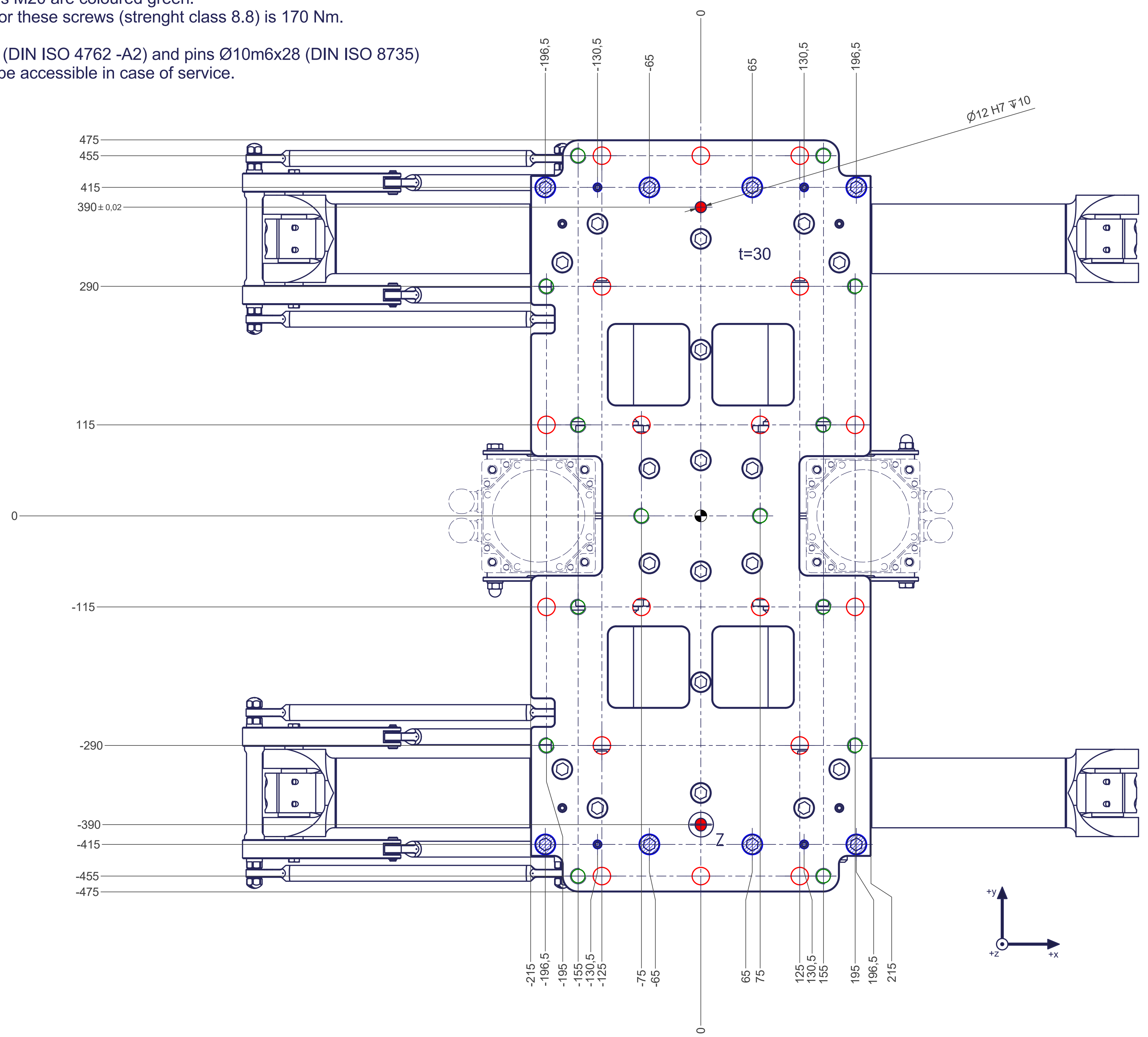
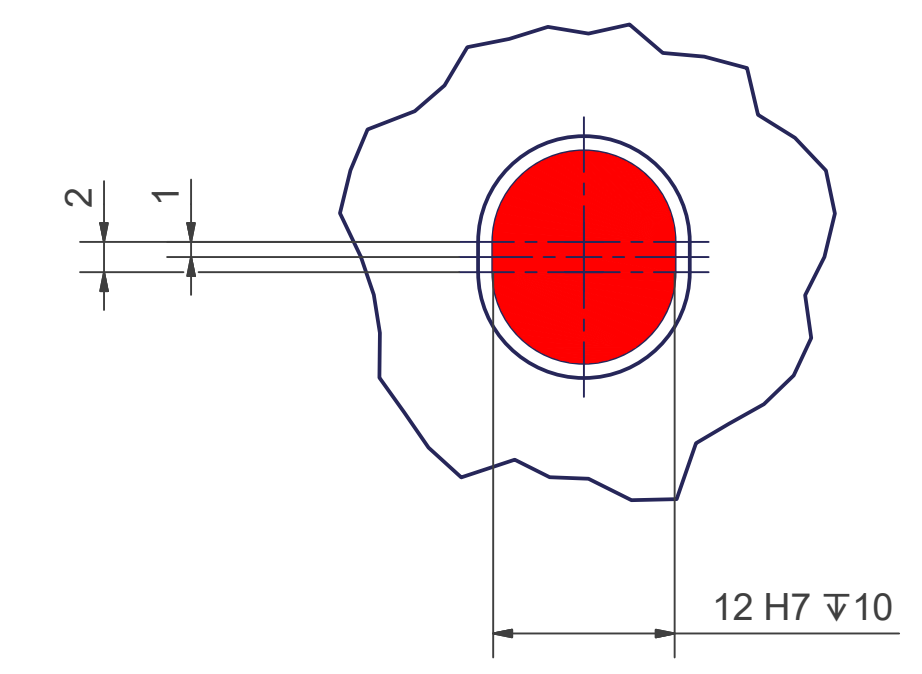

12 11 10 9 8 7 6 5 4 3 2 1