

Flange diagram according to ISO 9409-1-40-4-M6

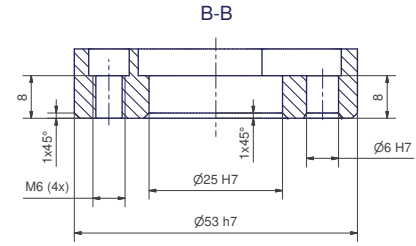

Z (1:1)

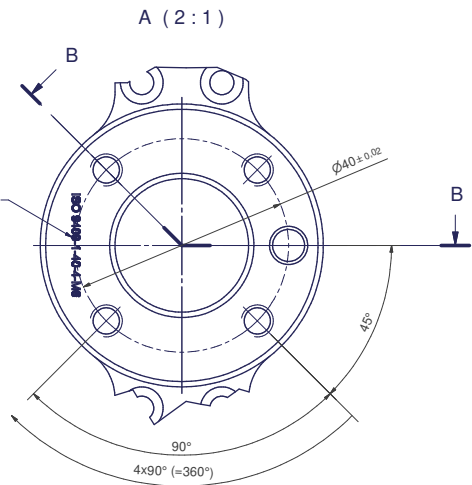
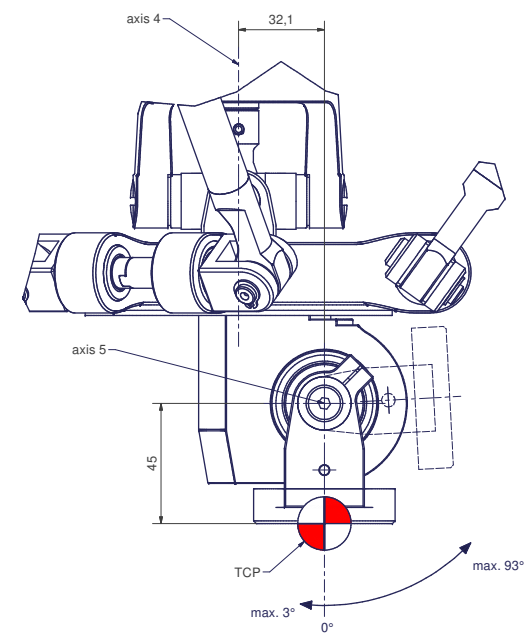

Tool Center Point
TCP (on the plane of the flange)

TCP - working range

Interference contour
from machine body

Maximum interference contour

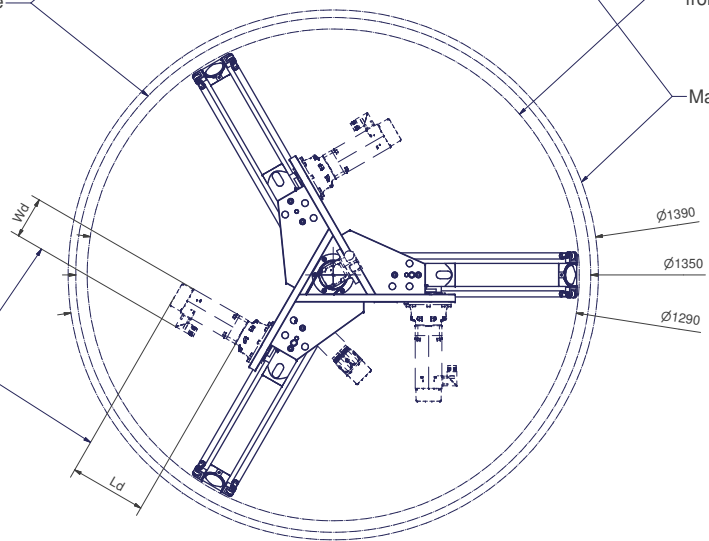

Depending on
the drive type



Connecting dimensions,
valid for article number A_00045.01

m= kg	A	p= bar
proj. storage surface = m ²	P= kW	v= l/min
	U= V / Hz / Ph	
	I _{max} = A	



A_00045.01

12 11 10 9 8 7 6 5 4 3 2 1

-  All fastening holes $\varnothing 17,5$ mm for screws M16 (DIN ISO 4014/4017 -8.8) without washers. Fastening holes are coloured red.
-  Drilling holes for locating pins are filled red.
- Recommended dimensions of locating pins: $\varnothing 12$ h6 mm

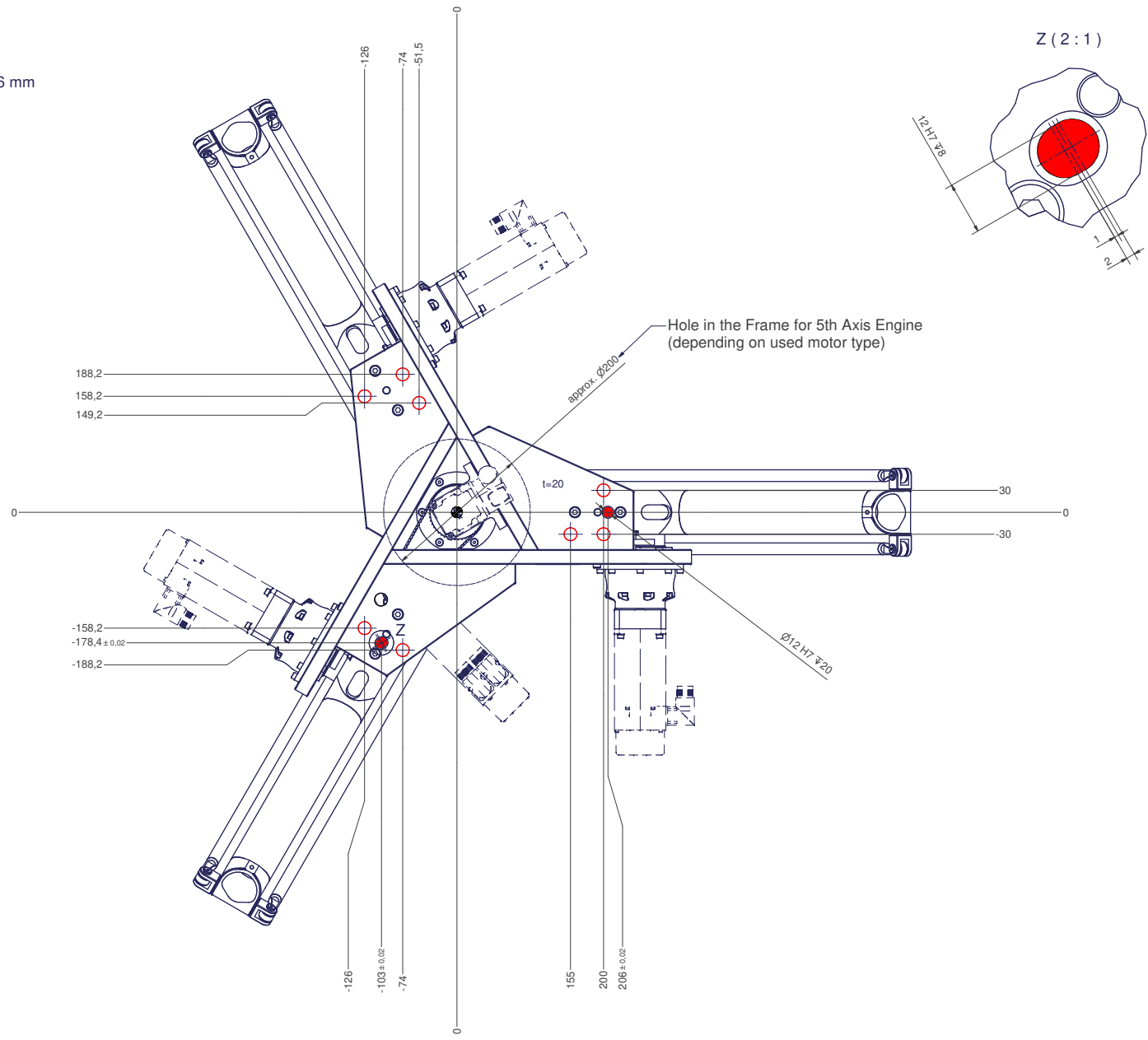

12 11 10 9 8 7 6 5 4 3 2 1