

The T1-rotation has to be bearing in the gripper: there is axial- and tilting clearance in the T1-flange avoiding overdefined system when mounted on the gripper.

m= kg	A	bar
proj. storage surface = m <sup>2</sup>	P= kW	v= l/min
U= V / Hz / Ph	I <sub>max</sub> = A	

Connecting dimensions, valid for article number A\_00921-T1

12 11 10 9 8 7 6 5 4 3 2 1

- All fastening holes  $\varnothing 22$  for screws M20 (DIN ISO 4014/4017 -8.8) without washer. Fastening holes are coloured red. The tightening torque for these screws (strength class 8.8) is 360 Nm (in a steel frame).
- Drilling holes for locating pins are filled red. Recommended dimensions of locating pins:  $\varnothing 12$  h6
- Thread holes for screws M20 are coloured green. The tightening torque for these screws (strength class 8.8) is 170 Nm.

Z (2:1)

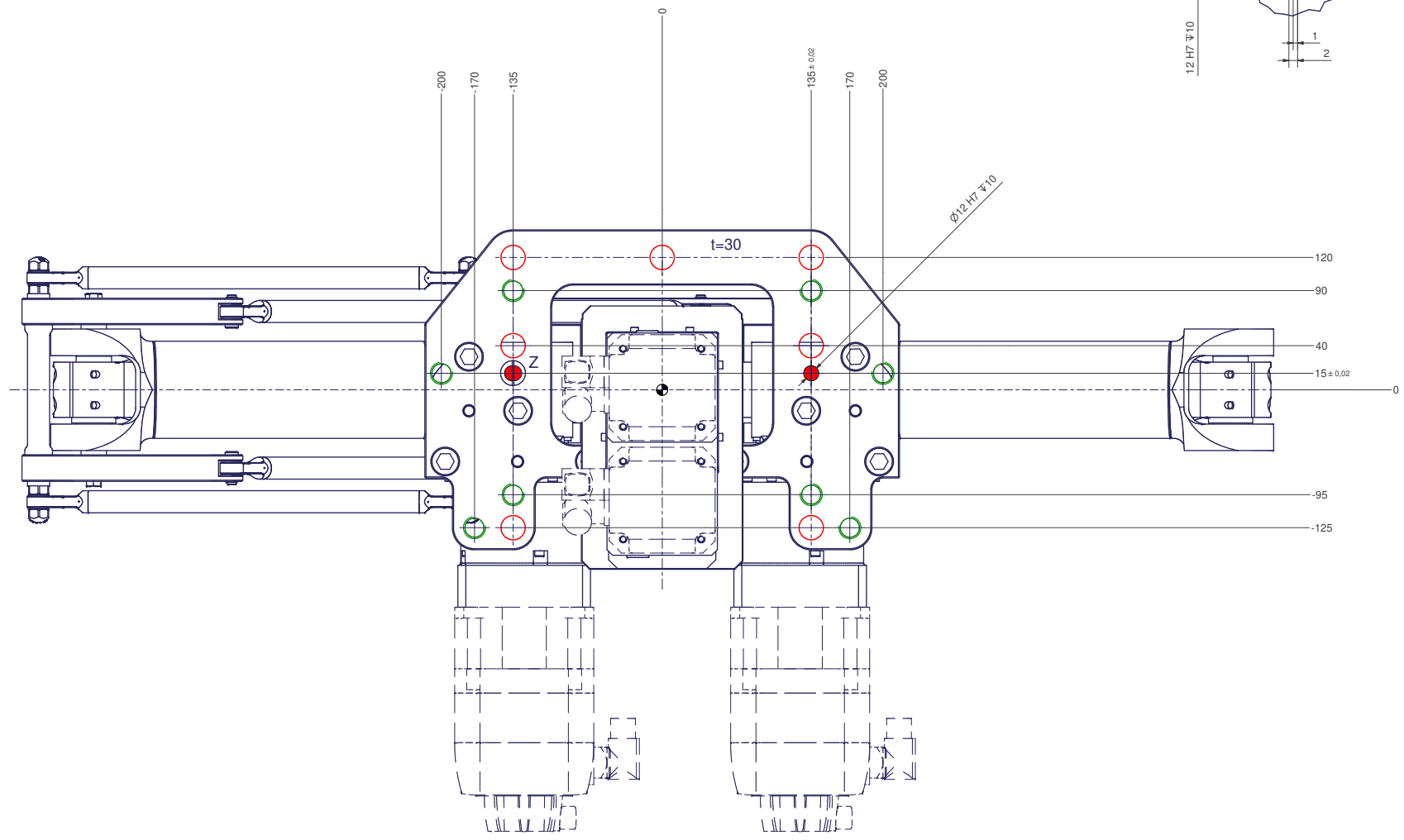
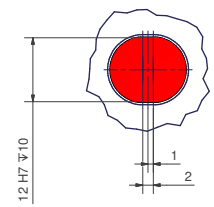

12 11 10 9 8 7 6 5 4 3 2 1