

B (1:5)

M6 (6x) (12mm deep)
(to fix some tools
like ejectors for example)

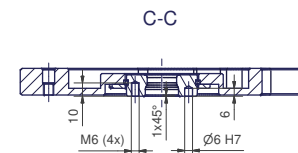

Z (1:2)

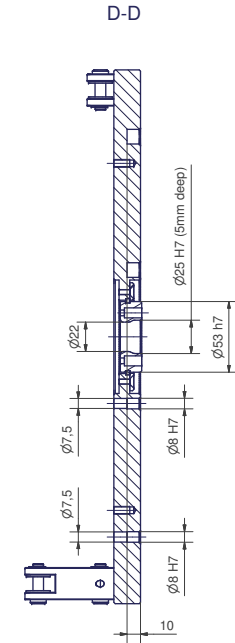
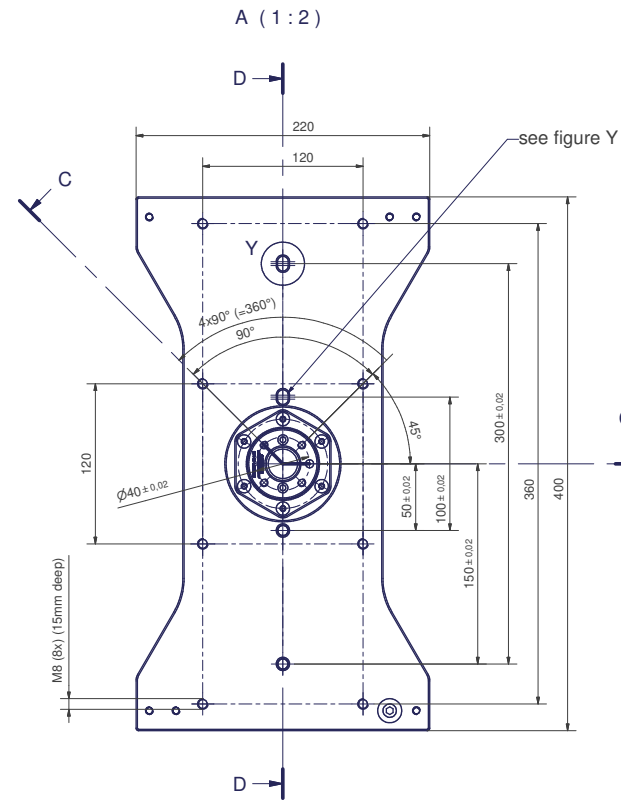
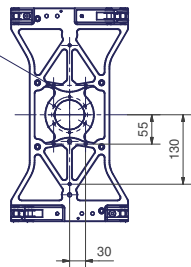
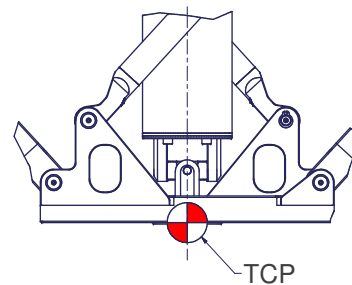

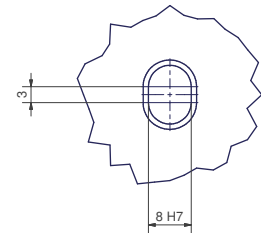

Y (2:1)



m= kg	A	bar
projected storage surface = m ²	P= kW	v= l/min
U= V / Hz / Ph	I _{max} = A	

12 11 10 9 8 7 6 5 4 3 2 1

-  All fastening holes $\text{\O}17,5$ mm for screws M16 (DIN ISO 4014/4017 -8.8) without washers. Fastening holes are coloured red.
-  Fastening screw threads coloured green: M8 (8x) (15mm deep).
-  Drilling holes for locating pins are filled red.

Z (2:1)

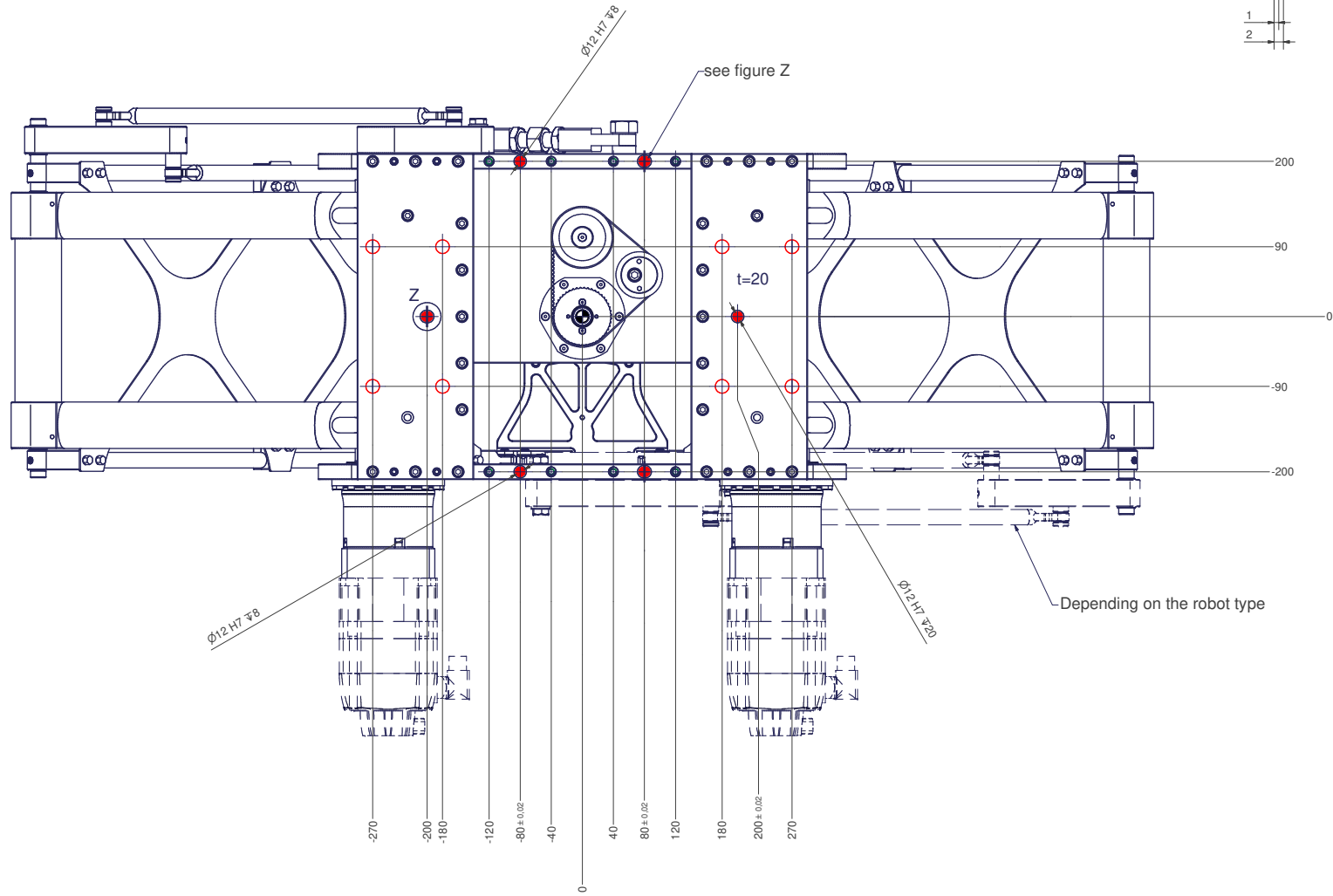
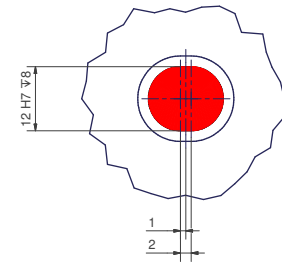

12 11 10 9 8 7 6 5 4 3 2 1