

**Tool Center Point**  
TCP (on the plane of the flange)

TCP - working range

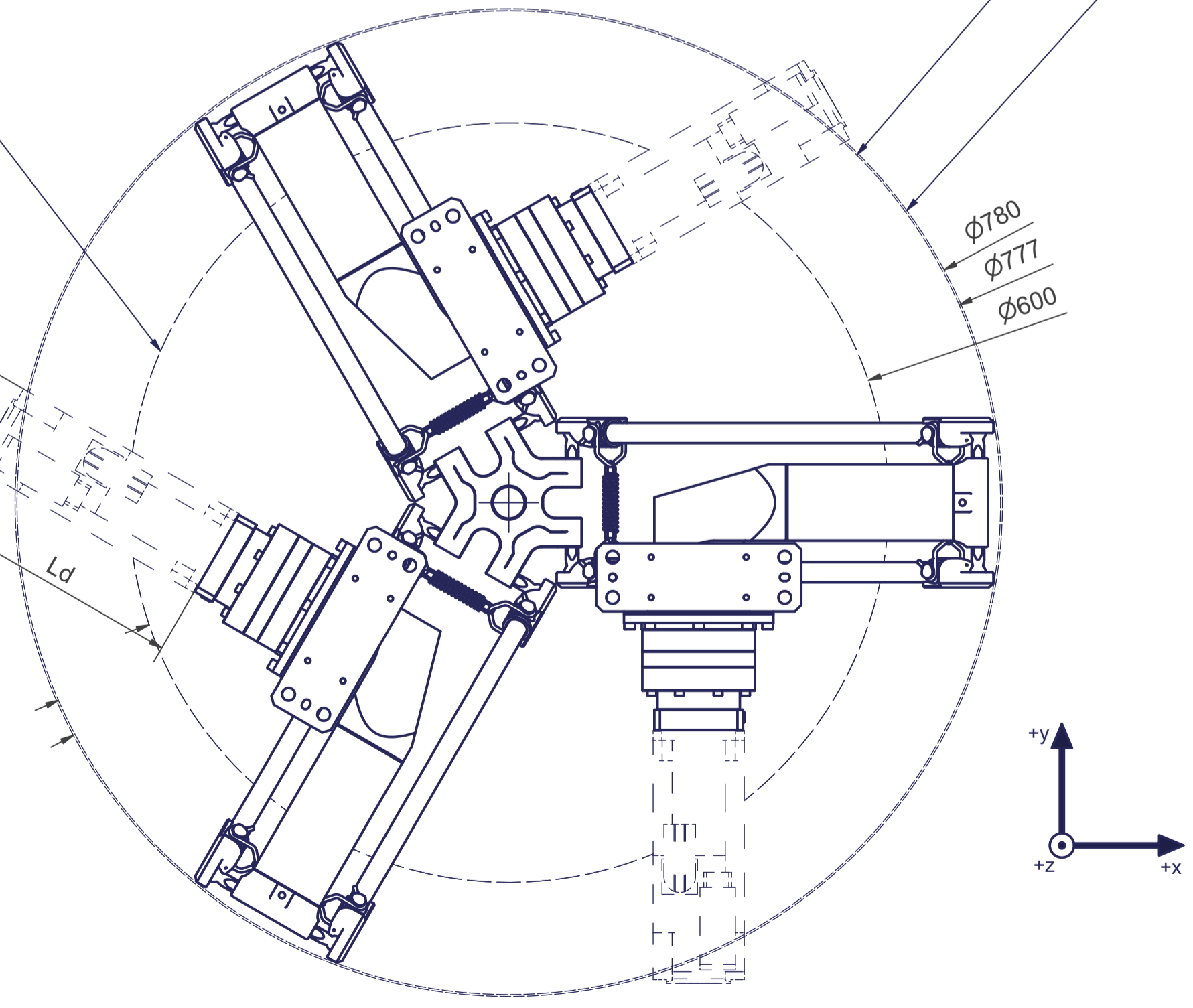

Interference contour from machine body

Maximum interference contour

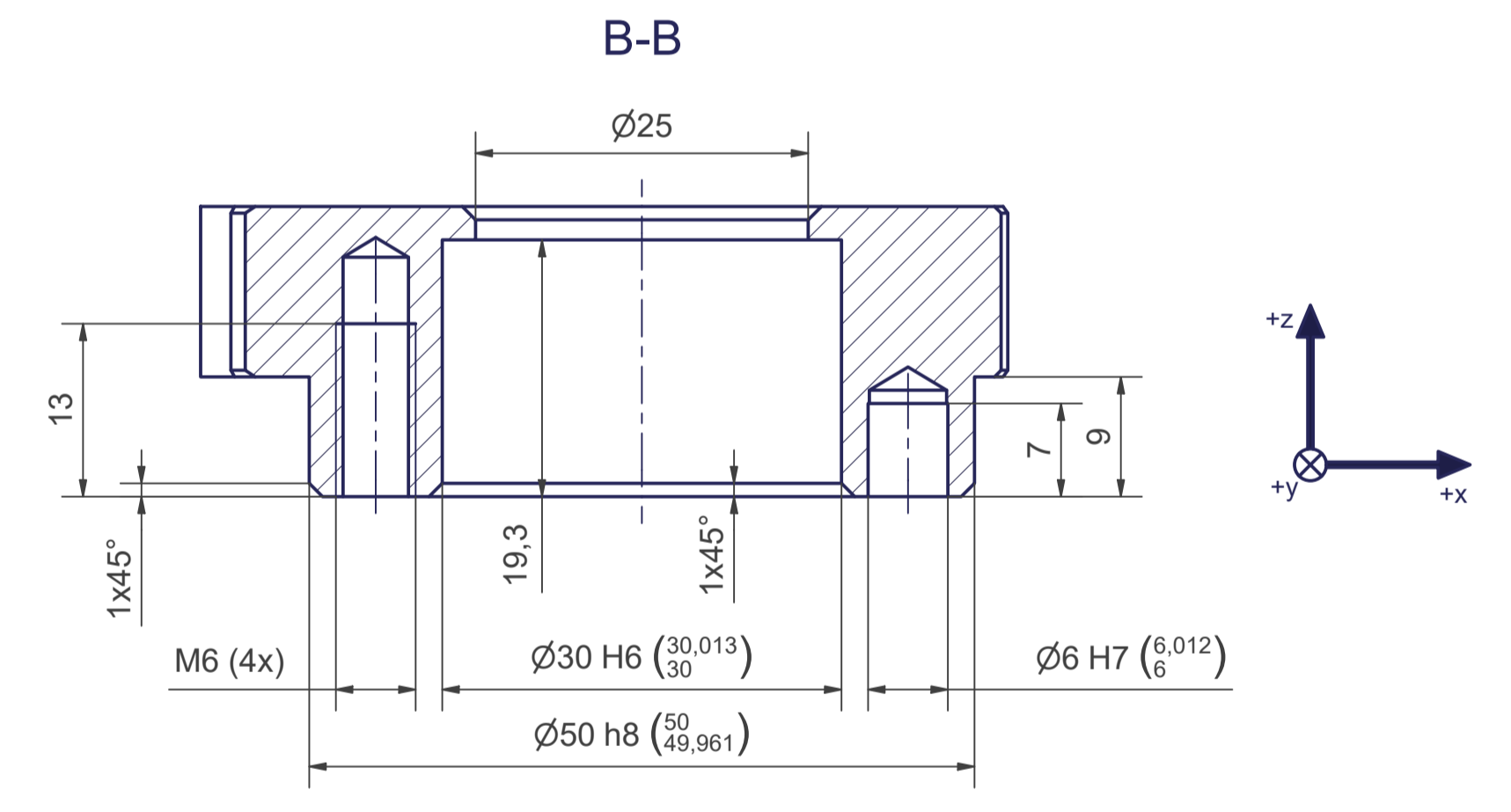
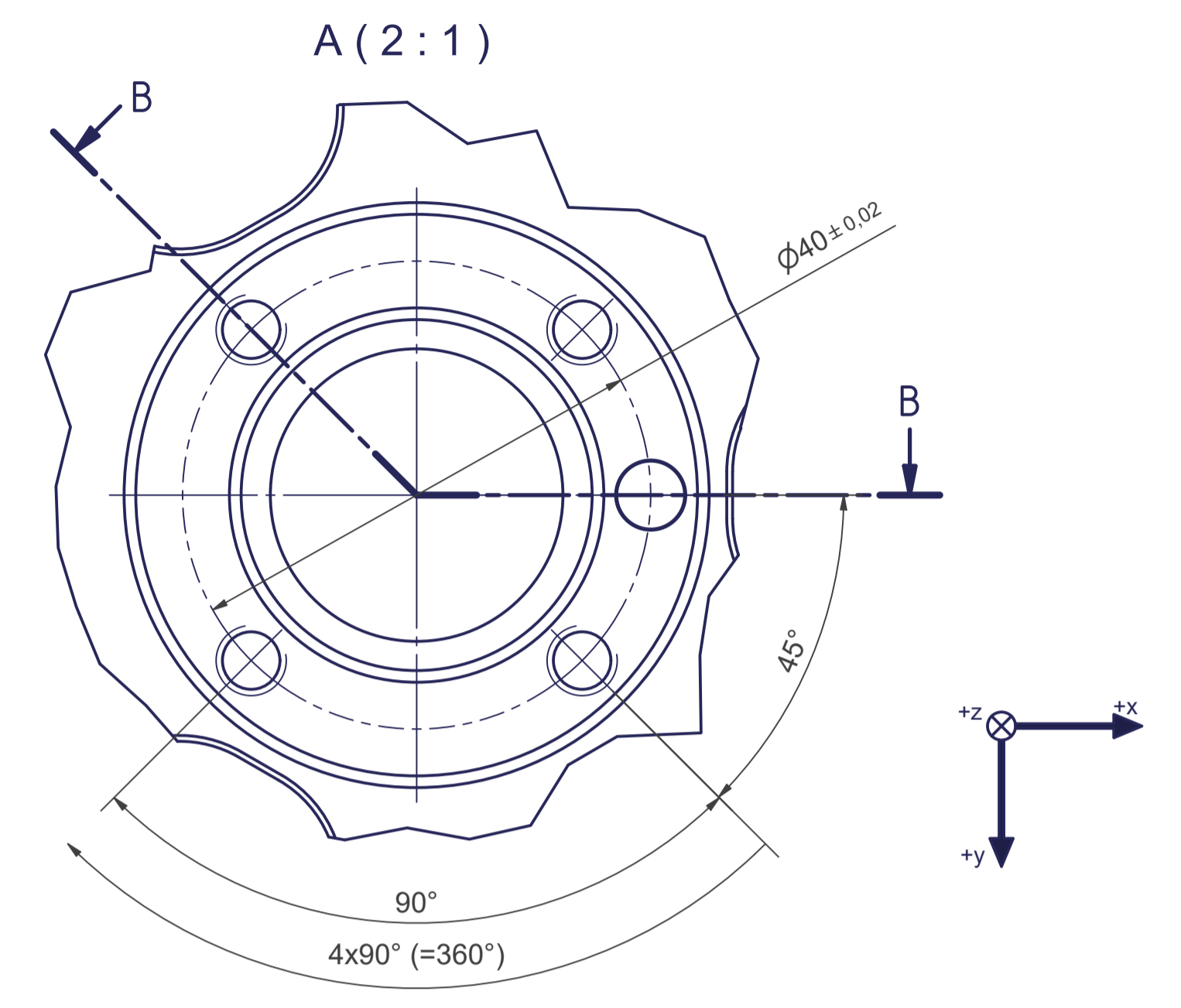

Z (1:1)

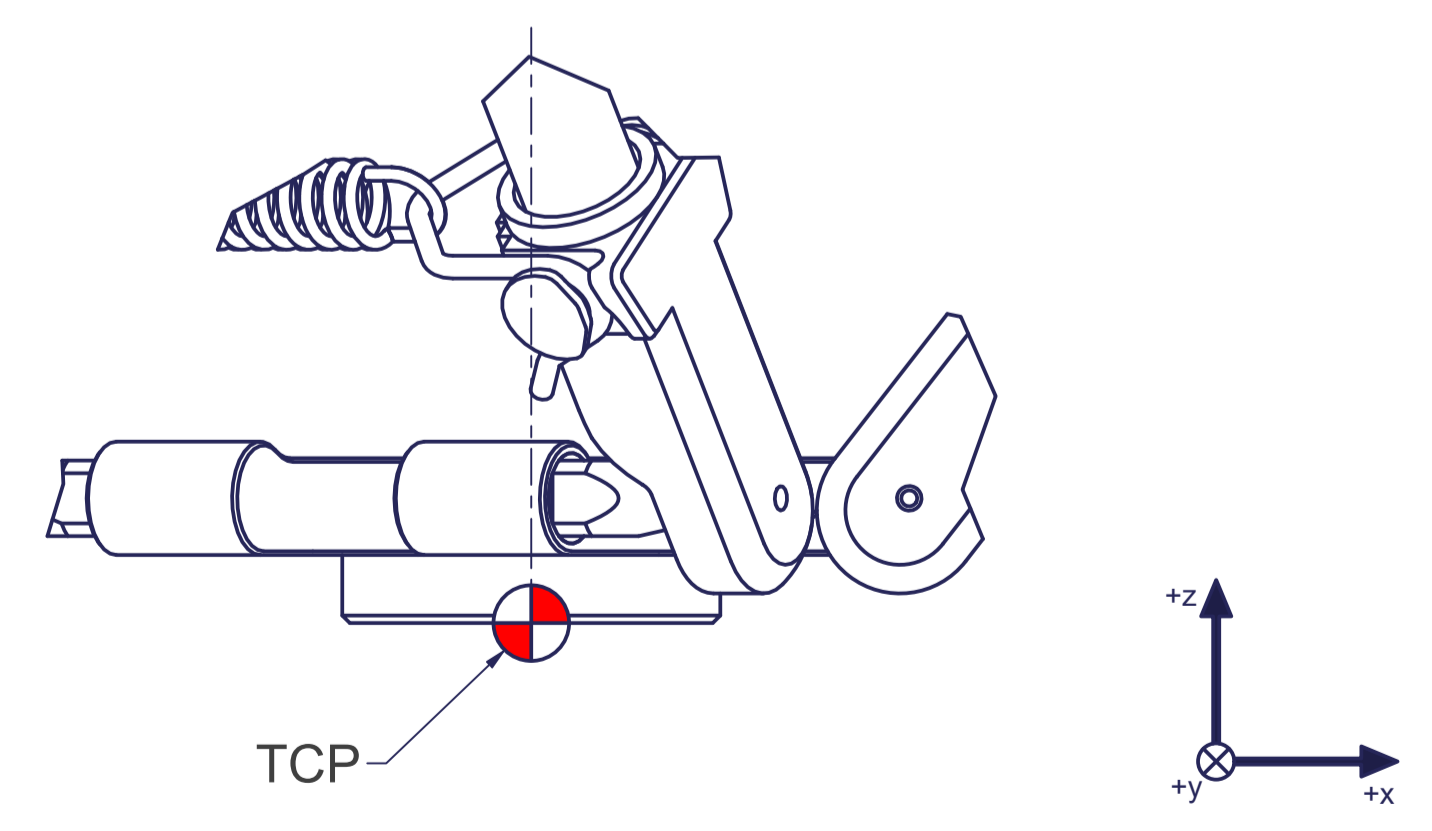

Connecting dimensions,  
valid for article number AL\_10001

m= kg	A	p= bar
proj. storage surface = m²		ψ= l/min
First angle projection	P= kW	<b>autonox</b> lean line
	U= V / Hz / Ph	
	I <sub>max</sub> = A	

12

11

10

9

8

7

6

5

4

3

2

1

H

H

G

G

F

F

E

E

D

D

C

C

B

B

A

A

12

11

10

9

8

7

6

5

4

3

2

1

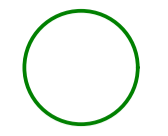

Thread holes for screws M12 are coloured green.  
The tightening torque for these screws (strength class 8.8) is 41 Nm.

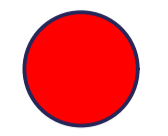

Drilling holes for location pins are filled red.  
Recommended dimensions for locating pins:  $\varnothing 6 \text{ h}8 \left( \begin{smallmatrix} 6 \\ 5,982 \end{smallmatrix} \right)$

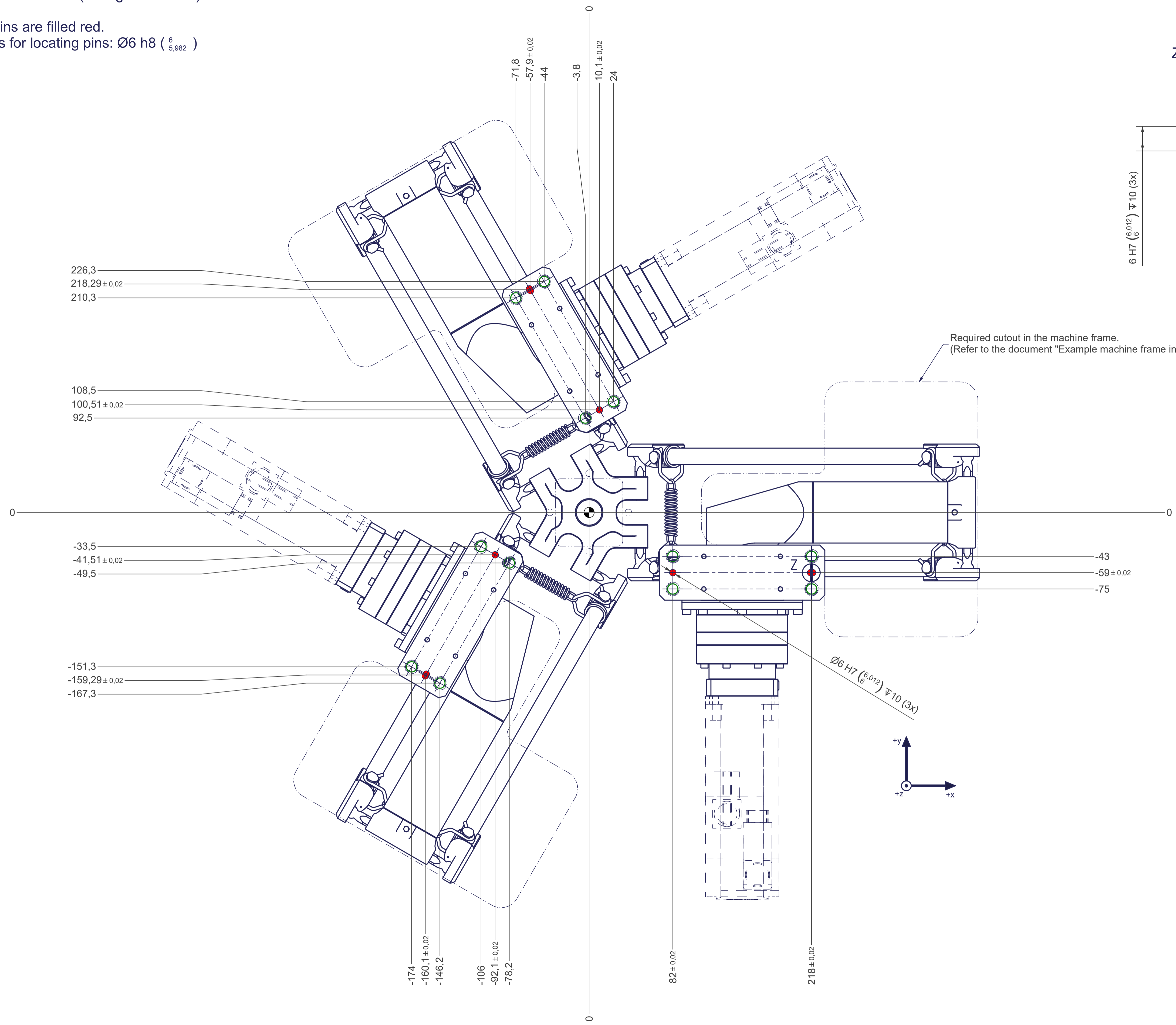

Z (2:1)

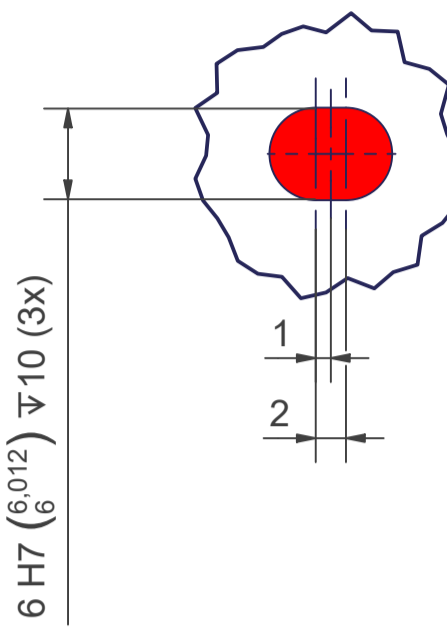

Required cutout in the machine frame.  
(Refer to the document "Example machine frame interface")

$\varnothing 6 \text{ H}7 \left( \begin{smallmatrix} 6 \\ 5,982 \end{smallmatrix} \right) \text{ H}10 (3x)$

