

**Tool Center Point**  
TCP (on the plane of the flange)

TCP - working range

Interference contour  
from machine body

Maximum interference  
contour

Flange diagram according  
to ISO 9409-1-25-4-M4

Z (1:1)

TCP

Connecting dimensions,  
valid for article numbers A\_00800 and A\_00806

m= kg	A	p= bar
proj. storage surface = m <sup>2</sup>	P= kW	v= l/min
First angle projection	U= V / Hz / Ph	
	I <sub>max</sub> = A	

12 11 10 9 8 7 6 5 4 3 2 1

- All fastening holes  $\varnothing 13,5$  mm for screws M12 (DIN ISO 4014/4017 -8.8) without washers. Fastening holes are coloured red.
- Drilling holes for locating pins are filled red. Recommended dimensions of locating pins:  $\varnothing 10$  h6

Z (2:1)

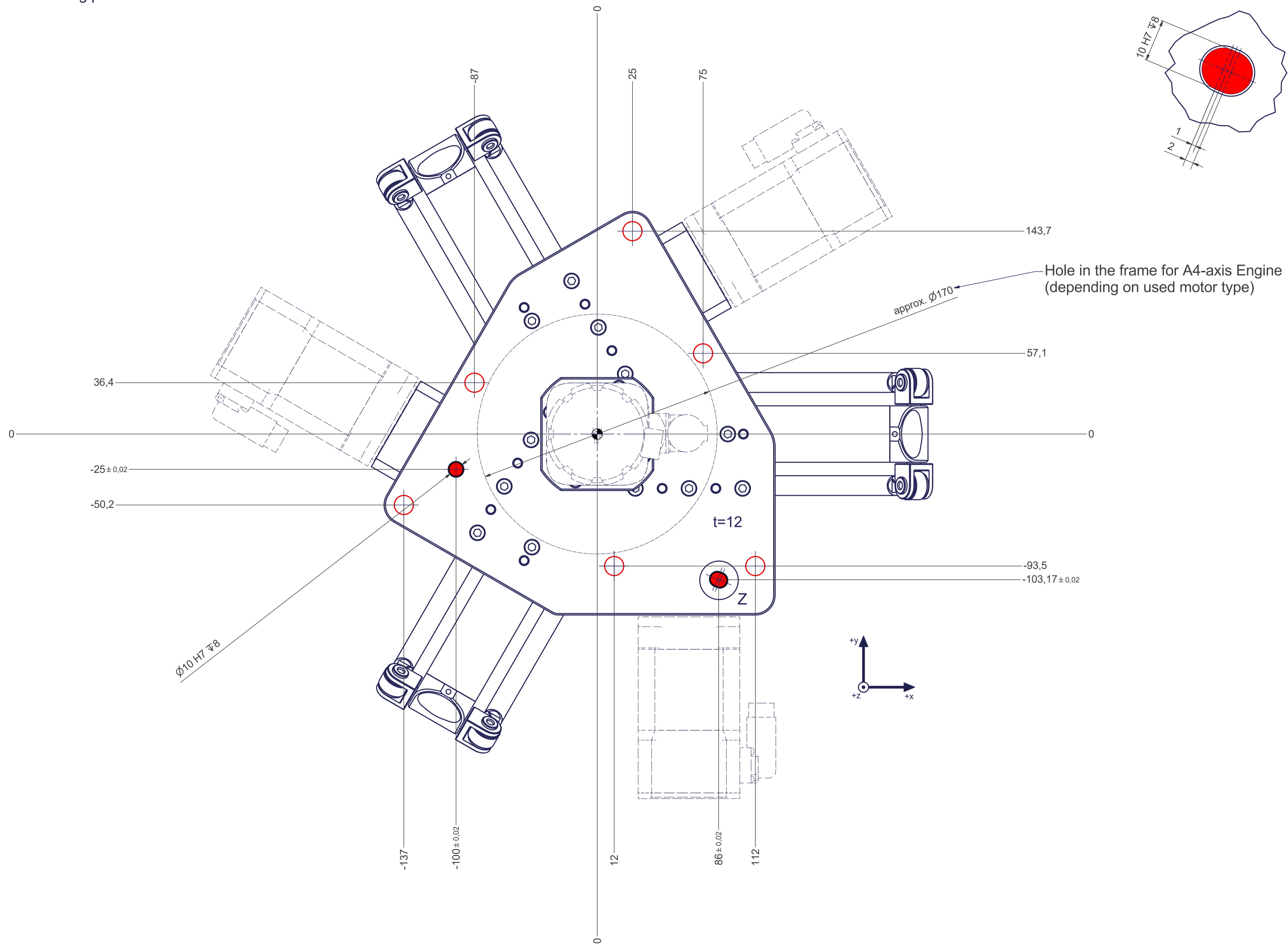
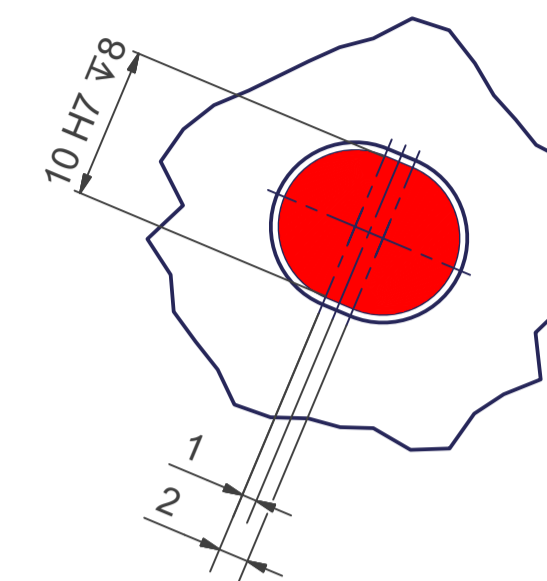

12 11 10 9 8 7 6 5 4 3 2 1