

OPTIONAL:
Tool-side change-adapter MT_BGR00105129

Connecting dimensions,
valid for article number A_00095.01-ATS/+X

m= kg		A
proj. storage surface = m²		p= bar
First angle projection		∅= l/min
	P= kW	
	U= V / Hz / Ph	
	I _{max} = A	



12 11 10 9 8 7 6 5 4 3 2 1

- All fastening holes $\varnothing 17,5$ mm for screws M16 (DIN ISO 4014/4017 -8.8) without washers. Fastening holes are coloured red.
- Drilling holes for locating pins are filled red. Recommended dimensions of locating pins: $\varnothing 12$ h6

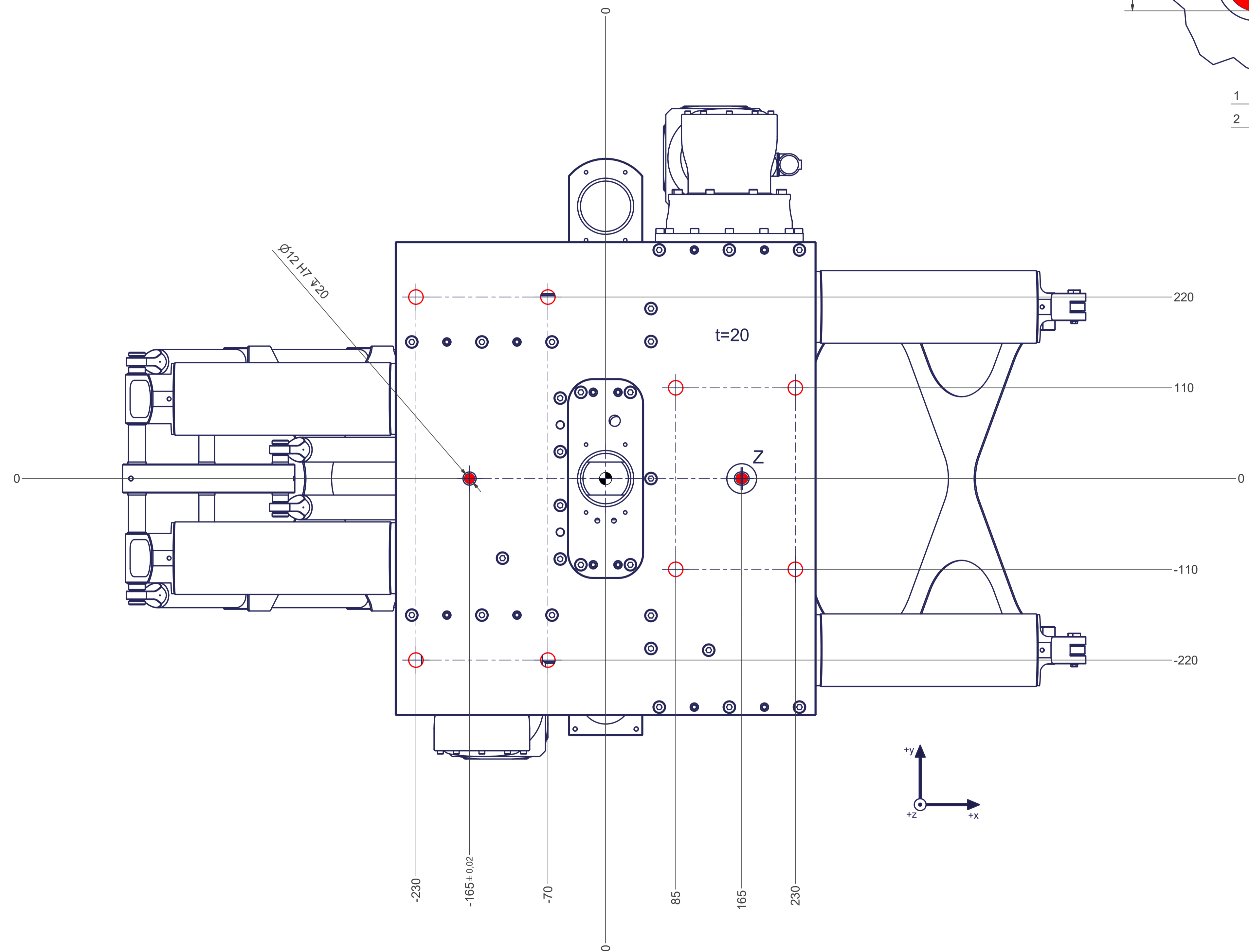
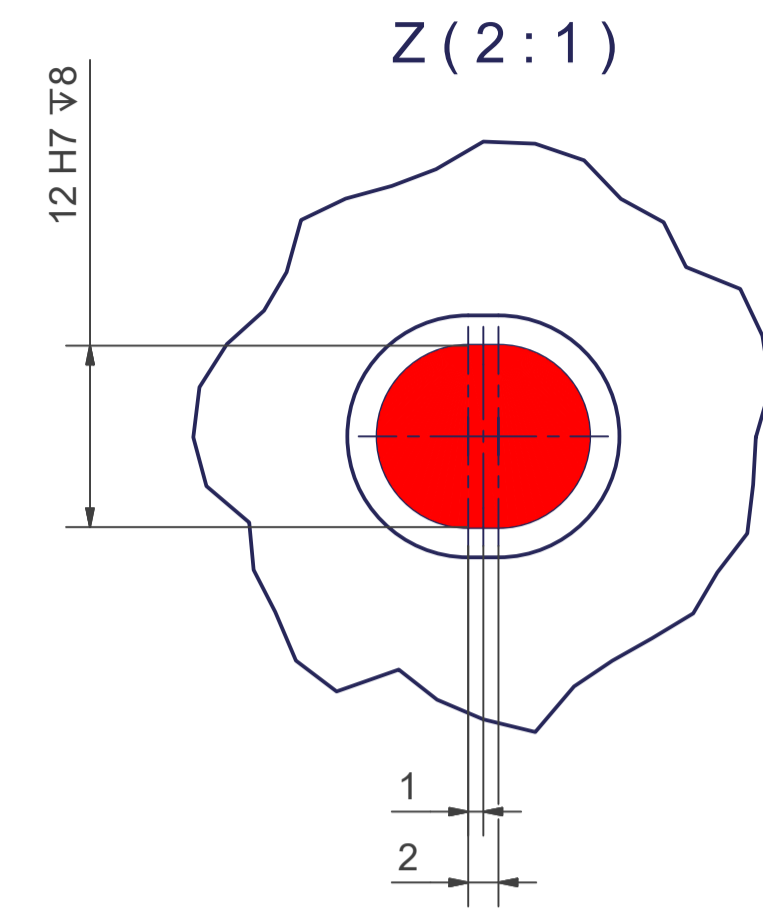

12 11 10 9 8 7 6 5 4 3 2 1