

Maximum deflection of the upper arm

A (1:1)

Flange diagram according to ISO 9409-1-125-6-M10

ISO 9409-1-125-6-M10

Ø125±0.02

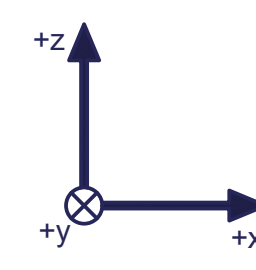

Interference contour from machine body

Maximum interference contour

B-B

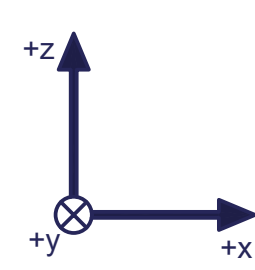

Z (1:2)

Screws strength class 8.8
Fasten with max. 40 Nm.
Do not use bonding agent.

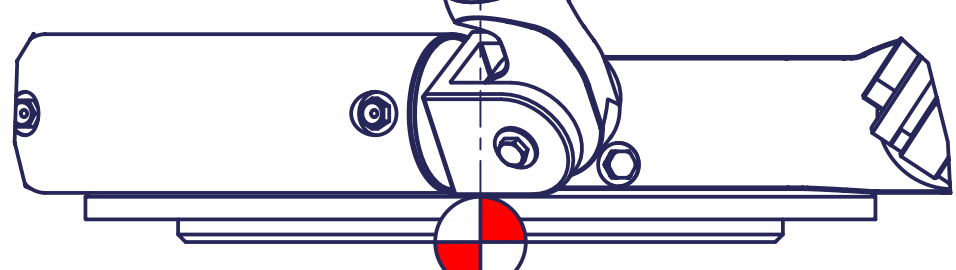

TCP

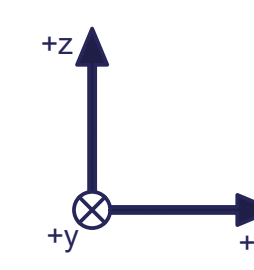

Connecting dimensions,
valid for article number A_00809-01

m= kg	A	●= bar
proj. storage surface = m²		∇= l/min
First angle projection	P= kW	
	U= V / Hz / Ph	
	Imax= A	

12 11 10 9 8 7 6 5 4 3 2 1

- All fastening holes $\varnothing 22$ for screws M20 (DIN ISO 4014/4017 -8.8) without washers. Fastening holes are coloured red.
- Drilling holes for locating pins are filled red. Recommended dimensions of locating pins: $\varnothing 12$ h6
- Thread holes for screws M20 are coloured green. The tightening torque for these screws (strength class 8.8) is 170 Nm.

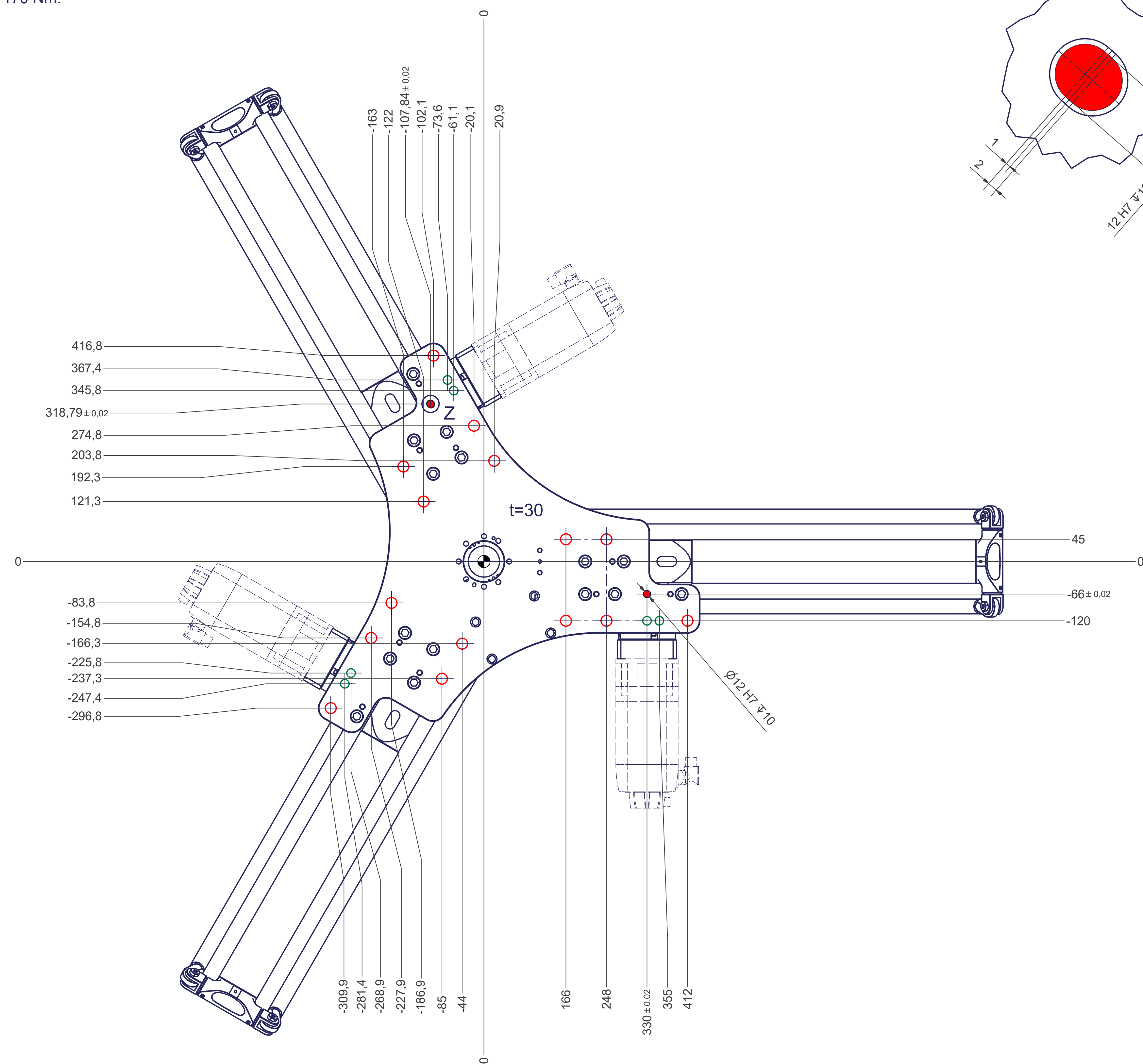
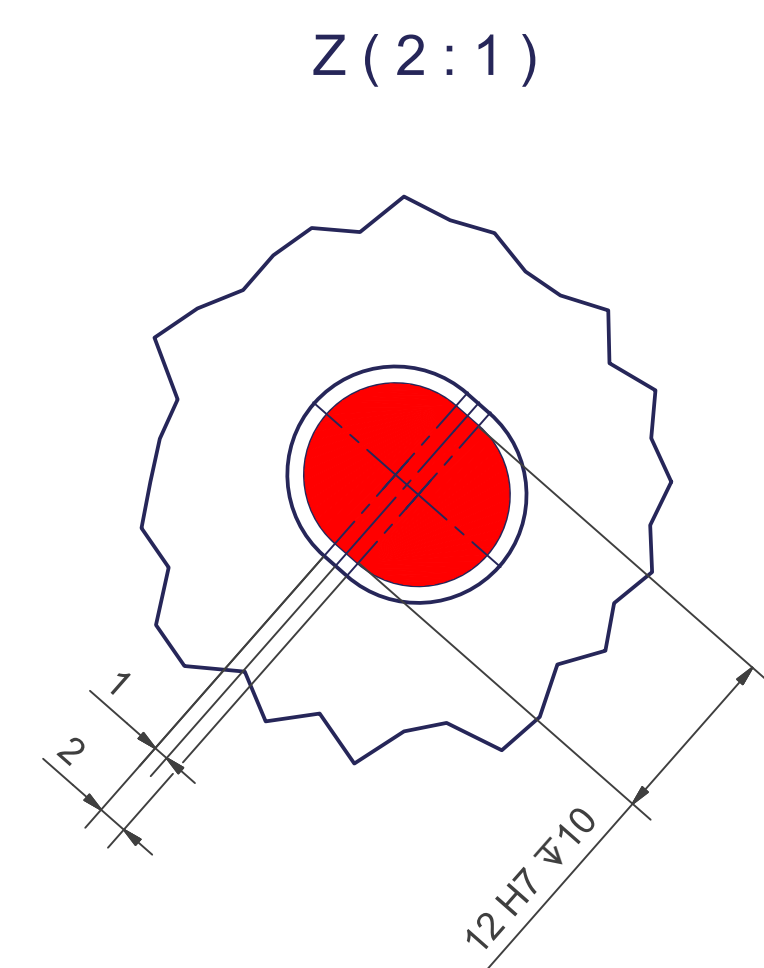

12 11 10 9 8 7 6 5 4 3 2 1